

EXISTING SITE PLAN
SCALE 1:200

COPYRIGHT AND OWNERSHIP OF THIS DRAWING IS VESTED IN DRA CONSULTING ENGINEERS. NO PART OF THIS DOCUMENT MAY BE REPRODUCED OR TRANSMITTED IN ANY FORM OR STORED IN ANY RETRIEVAL SYSTEM OF ANY NATURE WITHOUT THE WRITTEN PERMISSION OF DRA CONSULTING ENGINEERS AS COPYRIGHT HOLDER EXCEPT AS AGREED FOR USE ON THE PROJECT FOR WHICH THE DOCUMENT WAS ORIGINALLY ISSUED. ©

ALL RIGHT RESERVED BY THE LAW OF COPYRIGHT AND BY INTERNATIONAL COPYRIGHT CONVENTIONS ARE RESERVED TO DRA CONSULTING ENGINEERS. ©

ORDNANCE SURVEY MAPS REPRODUCED UNDER LICENCE No. CYAL50327478. © NATIONAL MAPPING DIVISION OF TAILTE EIREANN.

LEGEND:

	SITE BOUNDARY
	EXISTING SURFACE WATER SEWER
	EXISTING COMBINED SEWER

2	EXISTING INVERT LEVELS ADDED	RP	JR	AD	20/09/23
REV.	DESCRIPTION	PROD.	VERIF.	APPR.	DATE

PART 8

DRA
CONSULTING ENGINEERS

DUBLIN T: 01-4007515 | LIMERICK 061-310-701 | WEXFORD 053-915-2814 | E: info@draconsulting.ie | W: www.draconsulting.ie

CLIENT: CORK CITY COUNCIL

PROJECT: PROPOSED HOUSING AT CLANRICKARDE LODGES, BOREENMANNA ROAD, CORK

TITLE: EXISTING SITE PLAN & WATER SERVICES

DATE:	11/09/2023	SCALES:	AS SHOWN @ A1
DESIGNER:	RP	DRG. No.	23083-100
PRODUCER:	RP	REV.	2
VERIFIER:	JR		
APPROVER:	AD		

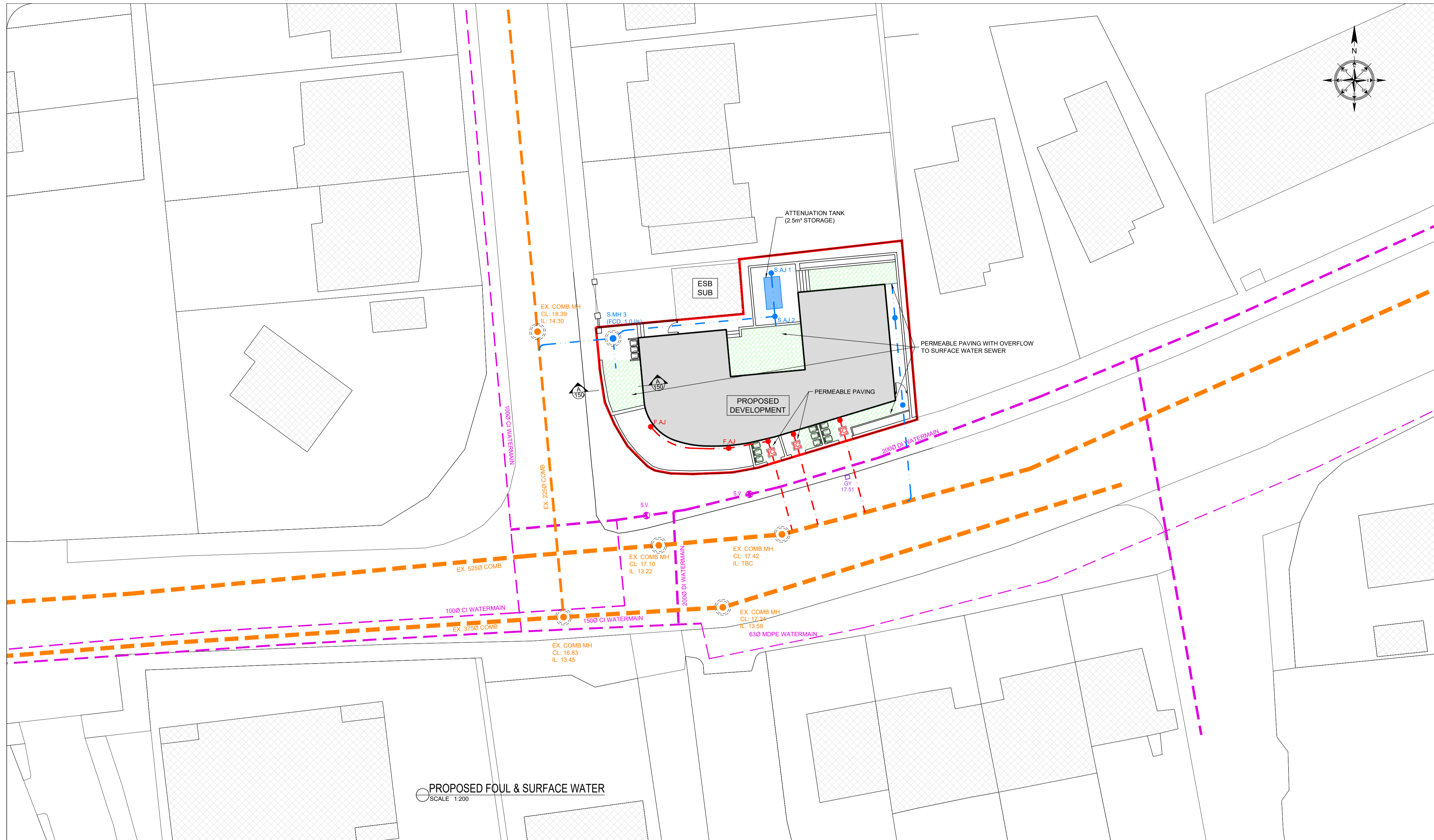

COPYRIGHT AND OWNERSHIP OF THIS DRAWING IS VESTED IN DRA CONSULTING ENGINEERS. NO PART OF THIS DOCUMENT MAY BE REPRODUCED OR TRANSMITTED IN ANY FORM OR STORED IN ANY RETRIEVAL SYSTEM OF ANY NATURE WITHOUT THE WRITTEN PERMISSION OF DRA CONSULTING ENGINEERS AS COPYRIGHT HOLDER EXCEPT AS AGREED FOR USE ON THE PROJECT FOR WHICH THE DOCUMENT WAS ORIGINALLY ISSUED. ©

ALL RIGHT RESERVED BY THE LAW OF COPYRIGHT AND BY INTERNATIONAL COPYRIGHT CONVENTIONS ARE RESERVED TO DRA CONSULTING ENGINEERS. ©

ORDNANCE SURVEY MAPS REPRODUCED UNDER LICENCE No. CYAL50327478. © NATIONAL MAPPING DIVISION OF TAILTE EIREANN.

- LEGEND:**
- SITE BOUNDARY
 - - - PROPOSED SURFACE WATER SEWER (1000 @ 1:100)
 - PROPOSED SURFACE WATER AJ AS PER PART H (400-600mm DEEP Ø300mm)
 - FLOW CONTROL DEVICE. MAX DISCHARGE = X l/s (MANHOLE BENCHES AS PER MANUFACTURERS REQUIREMENTS)
 - ATTENUATION TANK
 - PERMEABLE PAVING
 - - - EXISTING COMBINED SEWER
 - - - PROPOSED FOUL SEWER (1000 @ 1:60 - 1:80)
 - PROPOSED FOUL INSPECTION CHAMBER AS PER IW DETAIL STD-WW-13 (CIRCA 900mm DEEP)
 - PROPOSED FOUL AJ AS PER PART H (400-600mm DEEP, Ø300mm)

PROPOSED FOUL & SURFACE WATER
SCALE 1:200

REV.	DESCRIPTION	PROD.	VERIF.	APPR.	DATE
4	SITE PLAN UPDATED	RP	JR	AD	17/12/24
3	SITE PLAN UPDATED	RP	JR	AD	20/05/24
2	EXISTING INVERT LEVELS ADDED AND DRAINAGE UPDATED	RP	JR	AD	20/09/23

PART 8

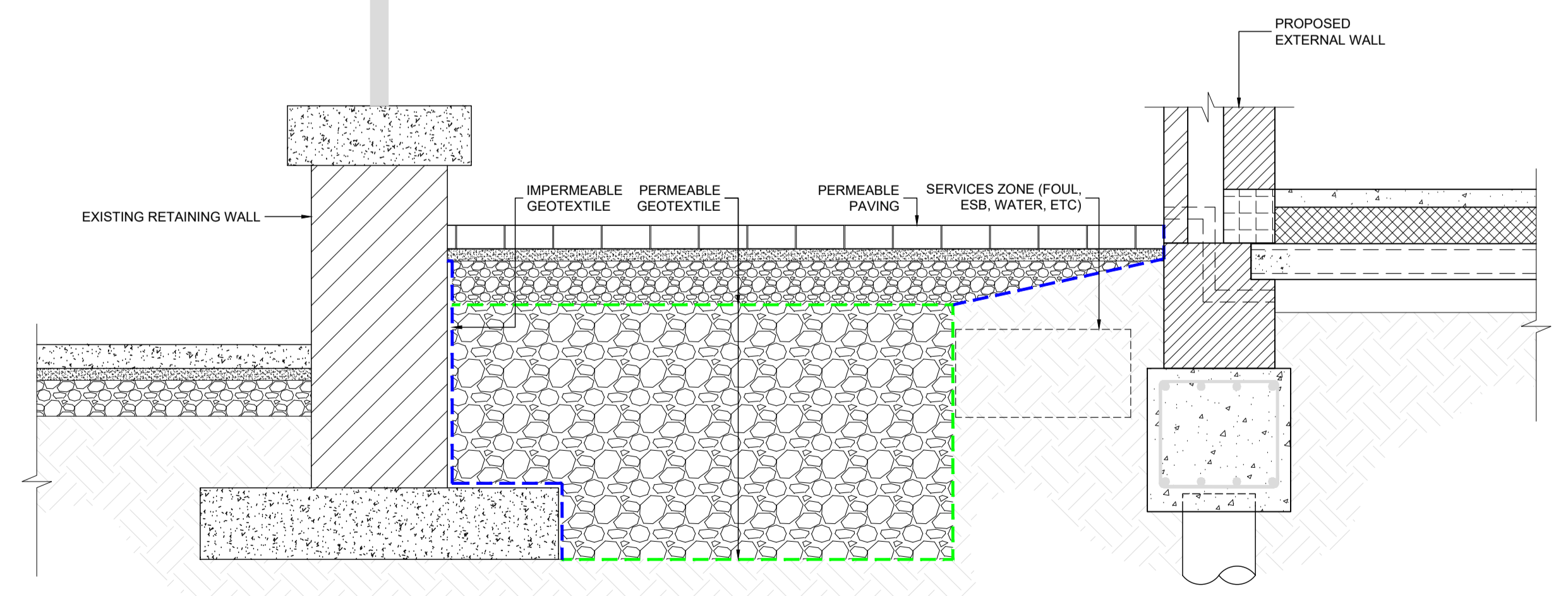

DETAIL A-A
SCALE 1:200

DRA
CONSULTING ENGINEERS

NSAI
NATIONAL SOCIETY OF ASSOCIATED ENGINEERS

IRI
REGISTERED PROFESSIONAL ENGINEER

DUBLIN: 01-4007515 | LIMERICK: 061-310-701 | WEXFORD: 053-915-2814 | E: info@draconsulting.ie | W: www.draconsulting.ie

CLIENT: CORK CITY COUNCIL

PROJECT: PROPOSED HOUSING AT CLANRICKARDE LODGES, BOREENMANNA ROAD, CORK

TITLE: PROPOSED FOUL & SURFACE WATER

DATE:	DESIGNER:	PRODUCER:	VERIFIER:	APPROVER:	SCALES:	ORG. No.	REV.
11/09/2023	RP	RP	JR	AD	AS SHOWN @ A1	23083-150	4

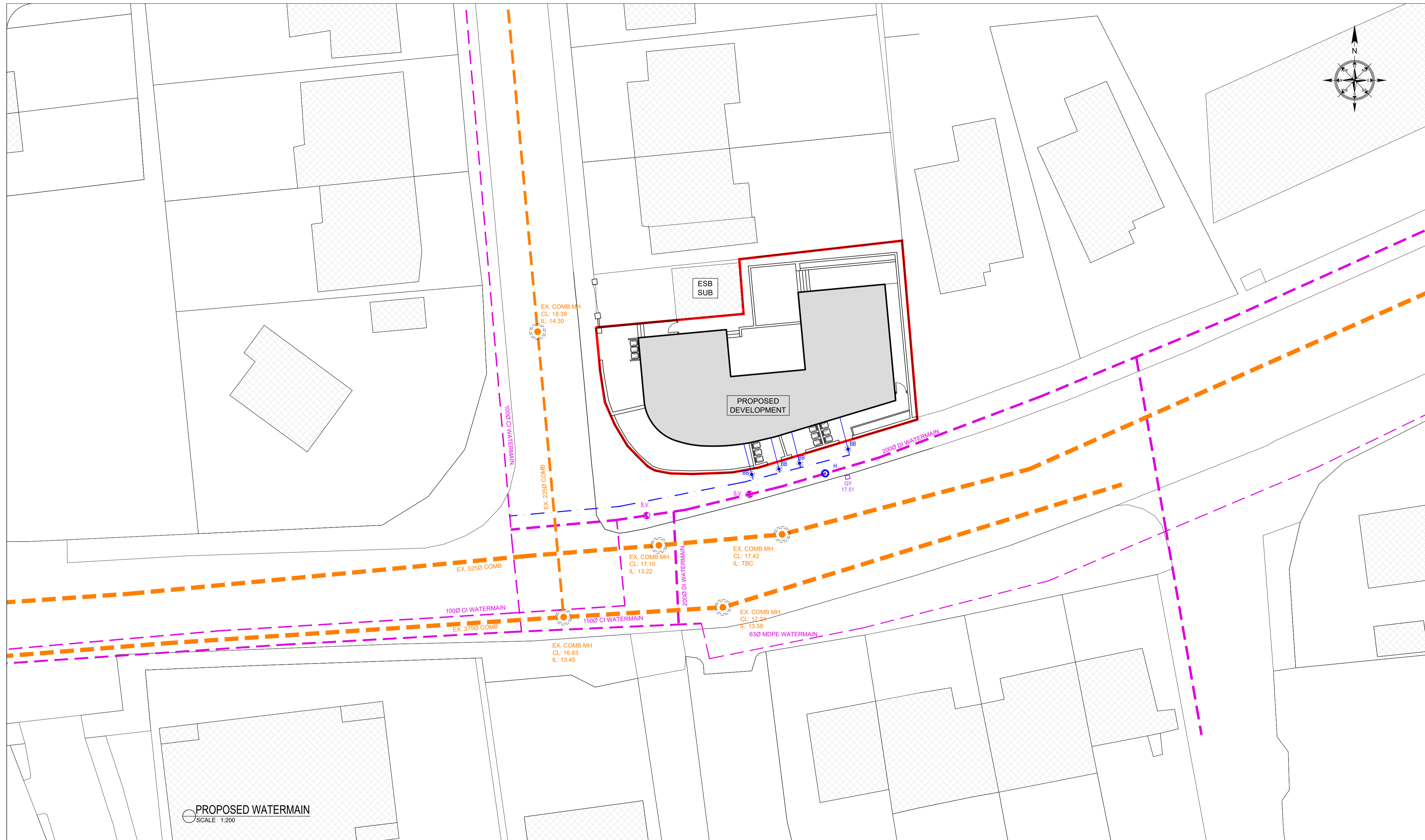

COPYRIGHT AND OWNERSHIP OF THIS DRAWING IS VESTED IN DRA CONSULTING ENGINEERS. NO PART OF THIS DOCUMENT MAY BE REPRODUCED OR TRANSMITTED IN ANY FORM OR STORED IN ANY RETRIEVAL SYSTEM OF ANY NATURE WITHOUT THE WRITTEN PERMISSION OF DRA CONSULTING ENGINEERS AS COPYRIGHT HOLDER EXCEPT AS AGREED FOR USE ON THE PROJECT FOR WHICH THE DOCUMENT WAS ORIGINALLY ISSUED. ©

ALL RIGHT RESERVED BY THE LAW OF COPYRIGHT AND BY INTERNATIONAL COPYRIGHT CONVENTIONS ARE RESERVED TO DRA CONSULTING ENGINEERS. ©

ORDNANCE SURVEY MAPS REPRODUCED UNDER LICENCE No. CYAL50327478. © NATIONAL MAPPING DIVISION OF TAILTE EIREANN.

PROPOSED WATERMAIN
SCALE 1:200

- LEGEND:**
- SITE BOUNDARY
 - - - EXISTING WATERMAIN
 - S.V. Ⓞ EXISTING SLUICE VALVE
 - - - PROPOSED WATERMAIN (630 PE)
 - - - PROPOSED SERVICE CONNECTION (250 PE)
 - H Ⓞ PROPOSED HYDRANT
 - BB Ⓞ PROPOSED BOUNDARY BOX

IRISH WATER STANDARD DETAILS AND CODE PRACTICE:

ALL OF THE SITE WATERMAIN WORKS SHOULD BE CARRIED OUT IN ACCORDANCE WITH IRISH WATER'S (IW) "WATER INFRASTRUCTURE STANDARD DETAILS" AND "CODE OF PRACTICE FOR WATER INFRASTRUCTURE".

- MATERIALS:**
- ALL WATERMAIN PIPE MATERIALS TO BE IN ACCORDANCE WITH SECTION 3.9 OF THE CODE OF PRACTICE.
 - HYDRANTS TO COMPLY WITH BS 750, TYPE 2 SCREW DOWN TYPE & IRISH WATER CODE OF PRACTICE.
 - HYDRANT INDICATOR PLATES TO COMPLY WITH BS 3251 & IRISH WATER CODE OF PRACTICE.

- TESTING:**
- ALL ELEMENTS TO BE TESTED IN ACCORDANCE WITH SECTION 4.10 OF IW CODE OF PRACTICE.

- IRISH WATER INSPECTIONS & AS-BUILTS:**
- CONTRACTOR TO ENSURE THAT IW FIELD ENGINEERS INSPECTS WORKS IN ACCORDANCE WITH QUALITY ASSURANCE (QA) FIELD INSPECTION REQUIREMENTS MANUAL.
 - CONTRACTOR TO ENSURE THAT AS CONSTRUCTED ELEMENTS ARE ADEQUATELY SURVEYED PRIOR TO COVERING UP TO ENSURE AS-BUILT DRAWINGS IN ACCORDANCE WITH QUALITY ASSURANCE (QA) FIELD

4	WATERMAIN REVISED	RP	JR	AD	10/01/25
3	SITE PLAN REVISED	RP	JR	AD	17/12/24
2	SITE PLAN REVISED	RP	JR	AD	24/04/24
REV.	DESCRIPTION	PROD.	VERIF.	APPR.	DATE

PART 8

DRA
CONSULTING ENGINEERS

NSAI
MEMBER

DUBLIN T: 01-4067515 | LIMERICK 061-310-701 | WEXFORD 053-915-2814 | E: info@draconsulting.ie | W: www.draconsulting.ie

CLIENT: CORK CITY COUNCIL	
PROJECT: PROPOSED HOUSING AT CLANRICKARDE LODGES, BOREENMANNA ROAD, CORK	
TITLE: PROPOSED WATERMAIN	
DATE: 11/09/2023	SCALE: AS SHOWN @ A1
DESIGNER: RP	DRG. No. 23083-160
PRODUCER: RP	REV. 4
VERIFIER: JR	
APPROVER: AD	