

NOTE: - DO NOT SCALE. USE FIGURED DIMENSIONS ONLY.  
 THIS DRAWING IS TO BE READ IN CONJUNCTION WITH ALL RELEVANT SPECIFICATIONS AND DRAWINGS.  
 ALL DIMENSIONS TO BE CHECKED ON SITE.  
 IN THE EVENT OF ANY DISCREPANCIES BETWEEN DRAWINGS THE CONTRACTOR IS TO INFORM THE ARCHITECT IMMEDIATELY.

REV	DATE	DESCRIPTION	ISSUED BY
1	27.09.24	Part 8 Planning Application	
2	13.09.25	Part 8 - Council Response	
3	15.10.25	Boundary Type 1 extended along Neptune Stadium	

**BOUNDARY TREATMENT:  
Wall and Railing Legend**

- Boundary Type 01
- Boundary Type 02
- Boundary Type 03
- Boundary Type 04
- Boundary Type 05

● Gate Type 01  
 NOTE: Existing Boundary walls to be removed, height varies. See Existing Site Plan, site survey and to be inspected on site.

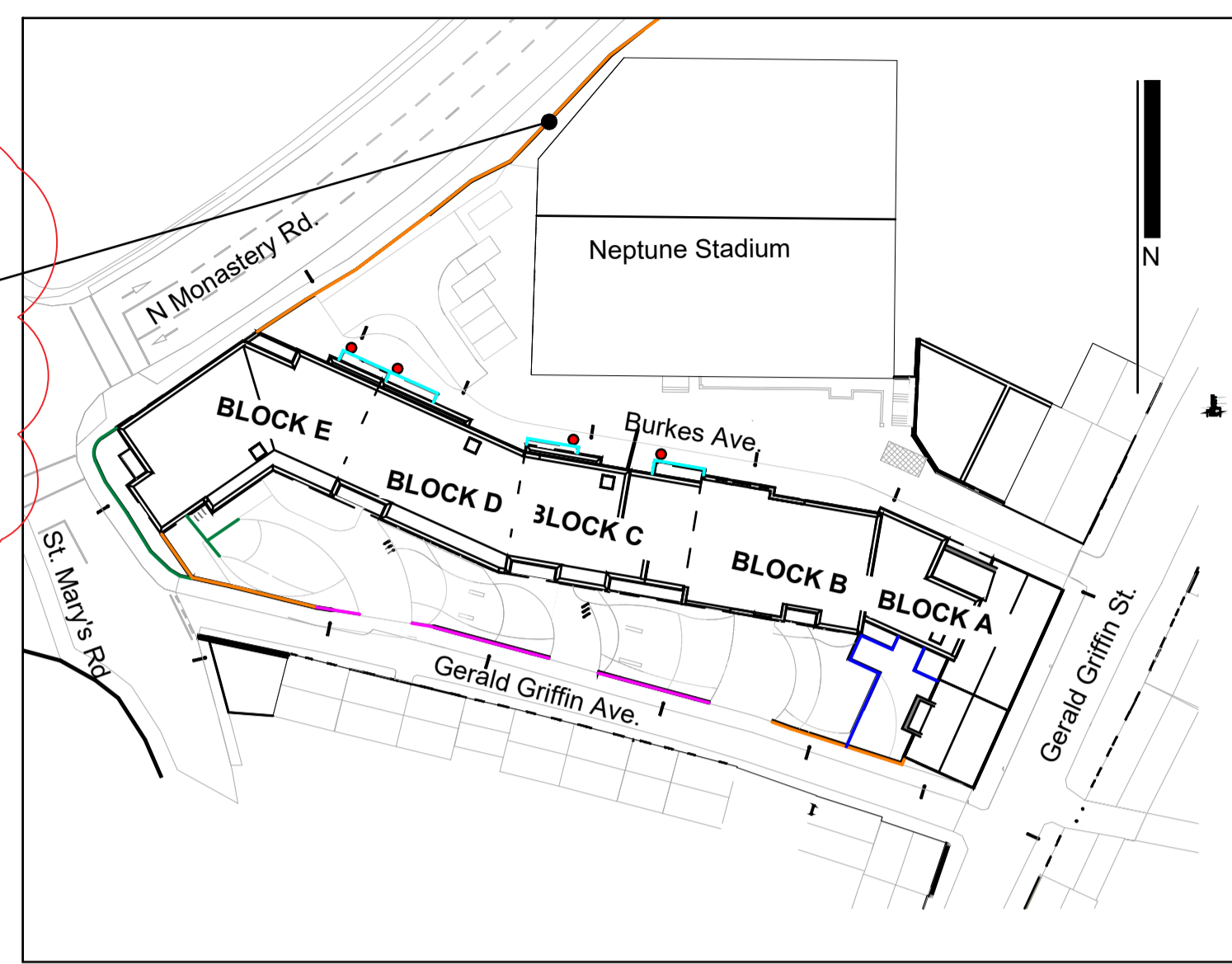

**Boundary Type 01**  
 Cork City Council propose to extend boundary type 1 railing and wall along the western boundary to Neptune Stadium. Extent of Railing to be agreed

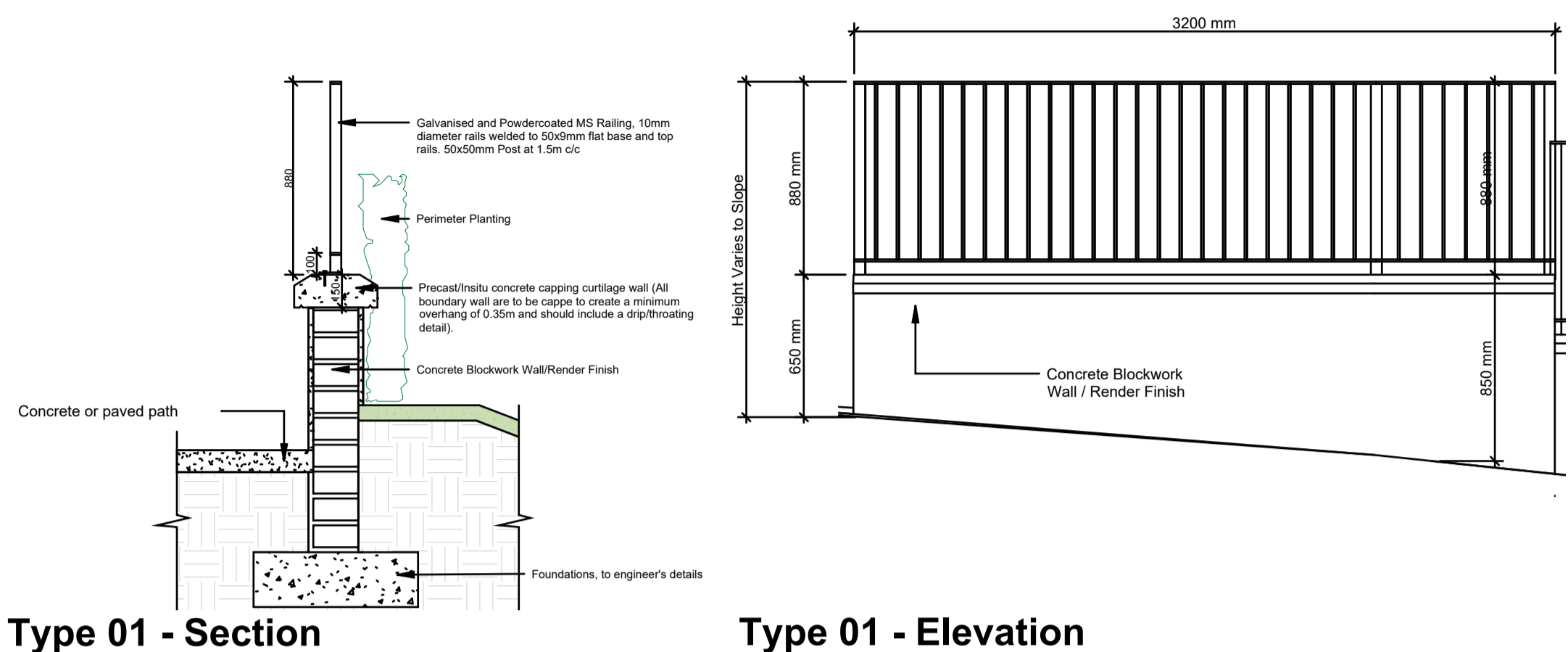

Type 01 - Section

Type 01 - Elevation

**1 Boundary Type 01**  
1:25

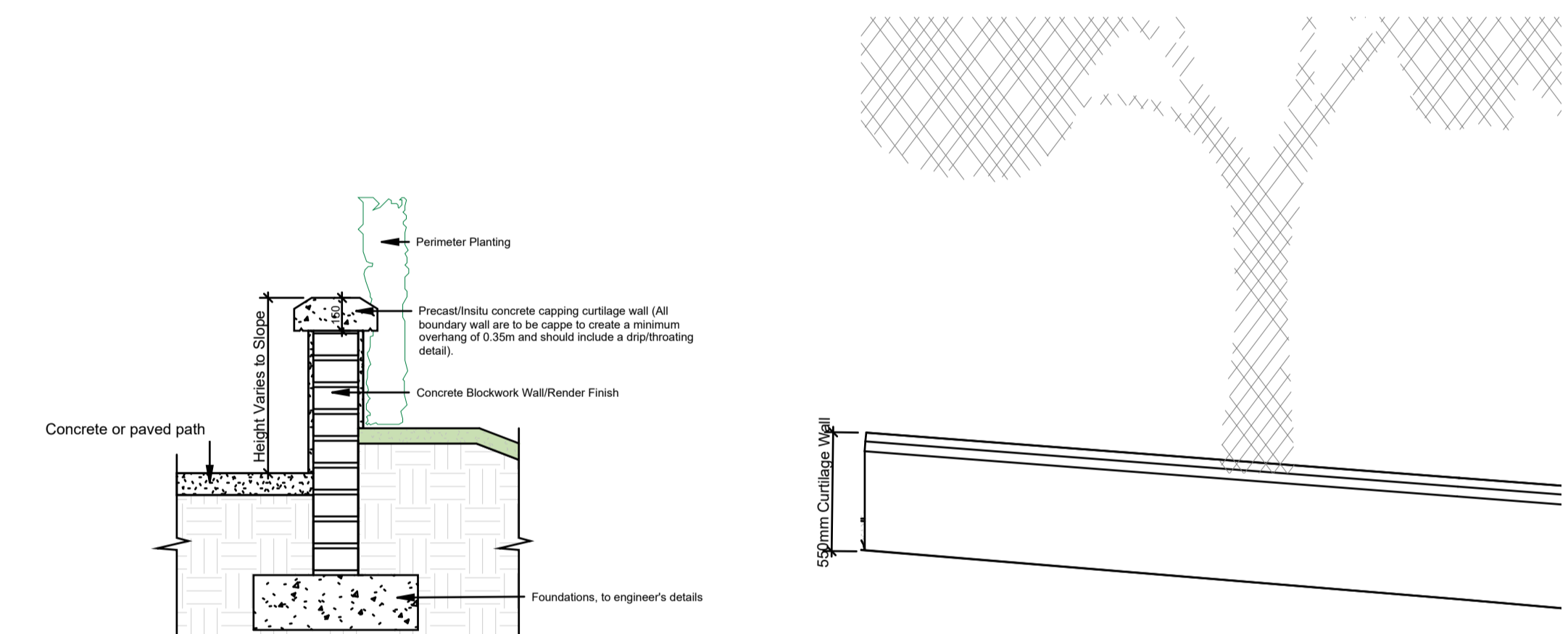

Type 02 - Section

Type 02 - Elevation

**2 Boundary Type 02**  
1:25

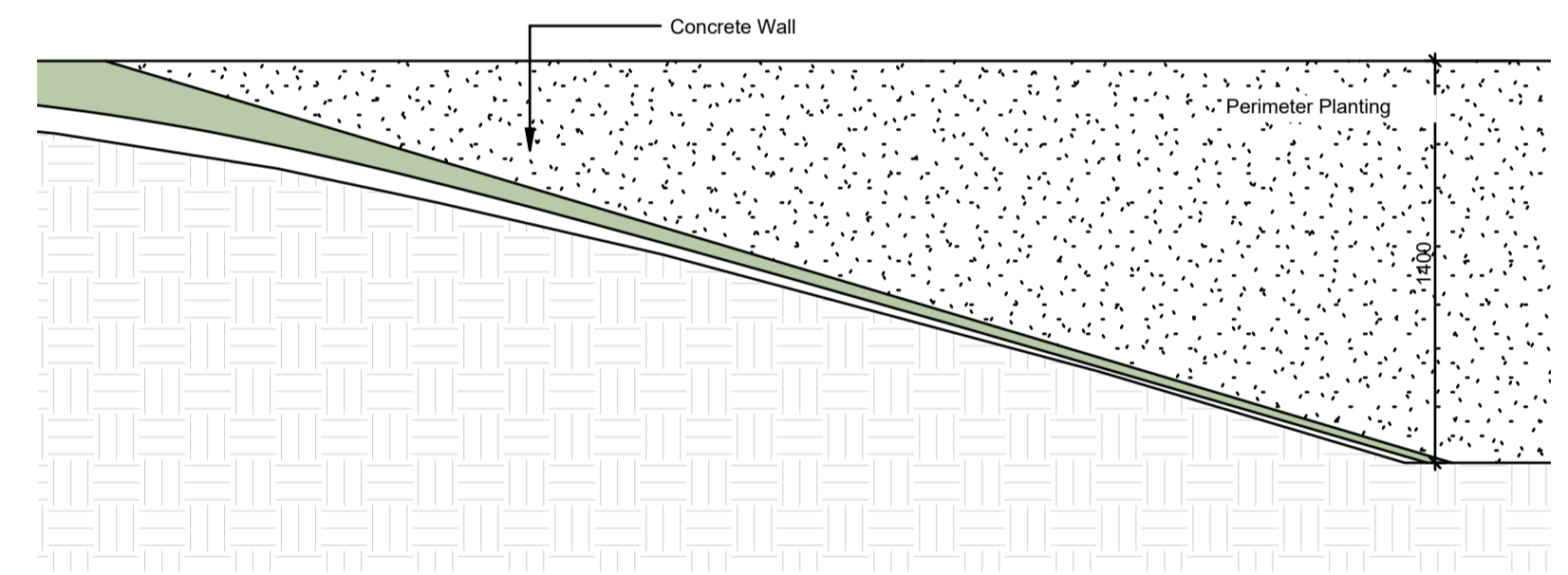

Type 04 - Elevation

**4 Boundary Type 04**  
1:25

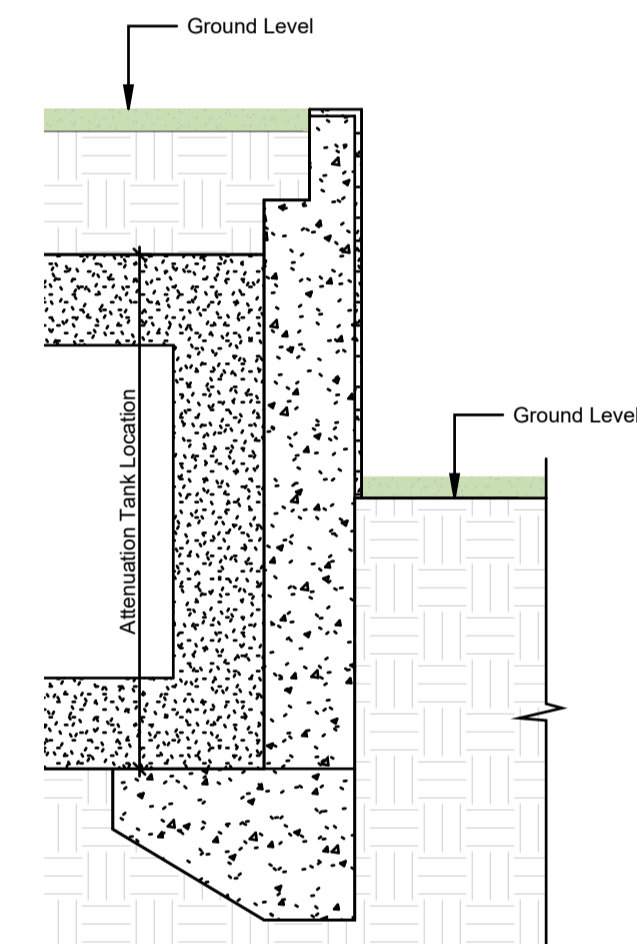

Type 04 - Section

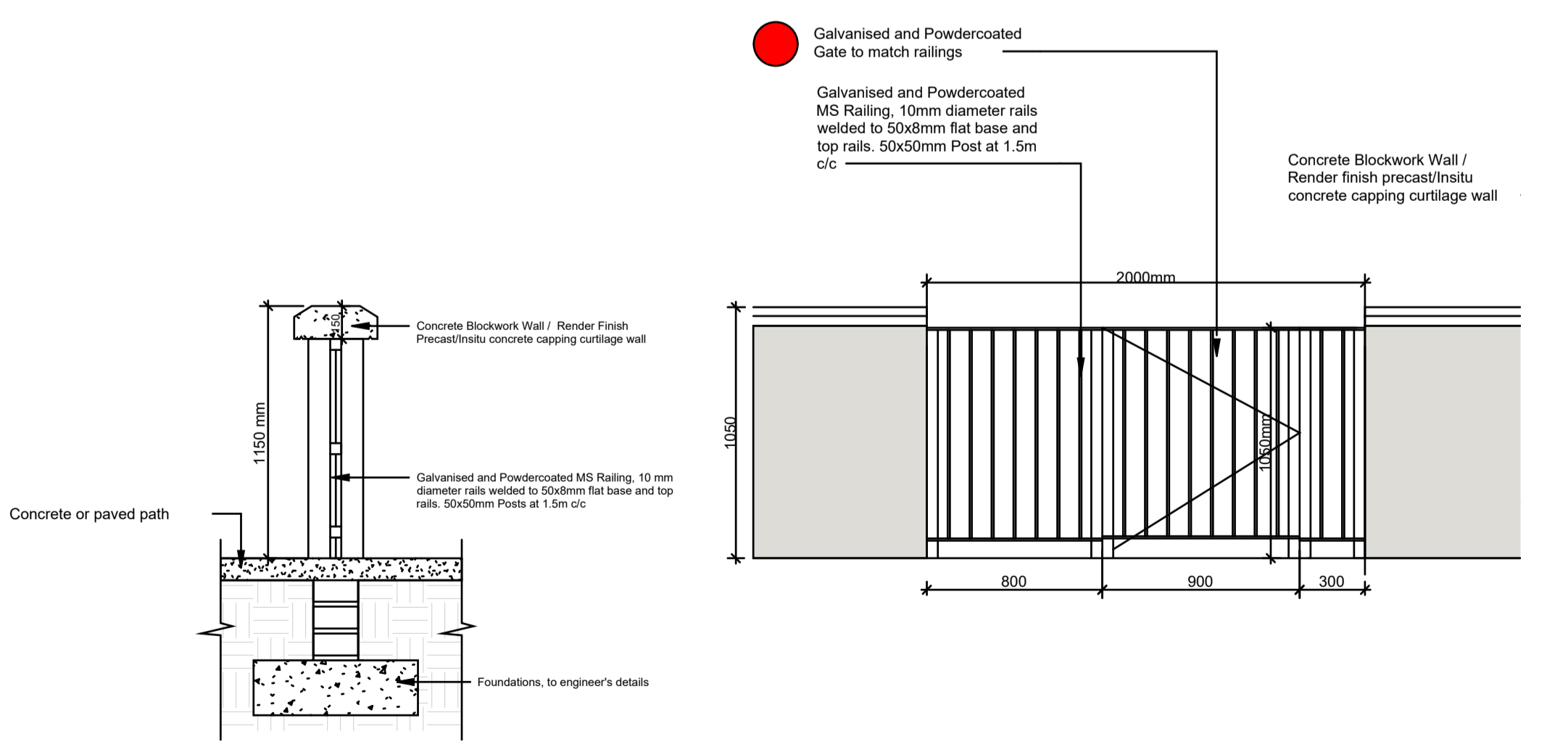

Type 03 - Section

Type 03 - Elevation

**3 Boundary Type 03**  
1:25

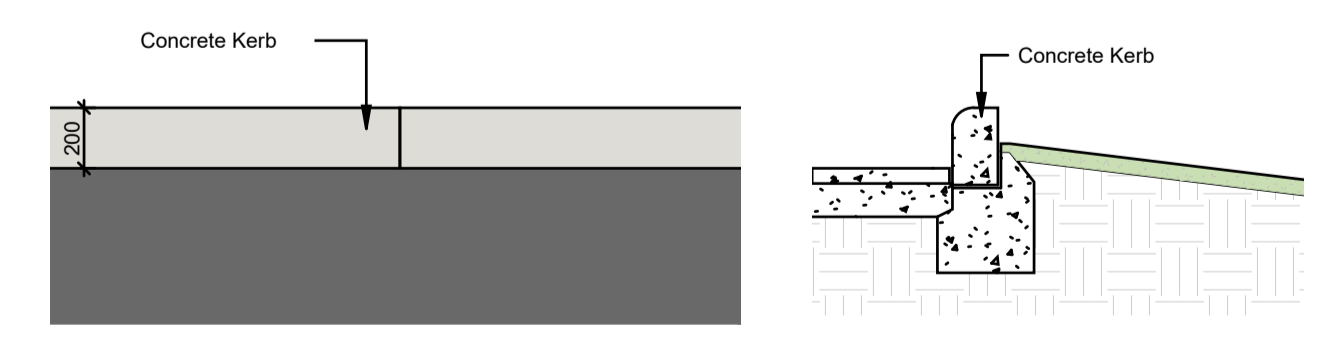

Type 05 - Elevation

Type 05 - Section

**5 Boundary Type 05**  
1:25

WILSON ARCHITECTURE  
 OMM | W

St. Patrick's Place, Wellington Road, Cork +353 (0)21 455255 info@wilsonarchitecture.ie  
 29 Merion Square North, Dublin 2 +353 (0)1 6601866 www.wilsonarchitecture.ie

Housing Development Gerald Griffin Street		Proposed Boundary Treatment Drawing			
REV	DATE	ISSUED	BY	CHKD	SCALE
1		S0	P03	22/06	SC

© COPYRIGHT This drawing or design may not be reproduced without permission.