

Paving Module Layout

- Notes:
1. 100mm x 400mm x 80mm thick Granite sett. Mix: 60%perm2 of G603 (Montemuro) and 40%perm2 of G603 (Grey vilar). All paving to have 'flamed top' sawn sides.
 2. Mortar Bed to Engineers specification.
 3. DBM to Engineers specification.
 4. Sub base to Engineers specification.
 5. Slurry mortar to all joints 8mm wide. Refer to engineers information.

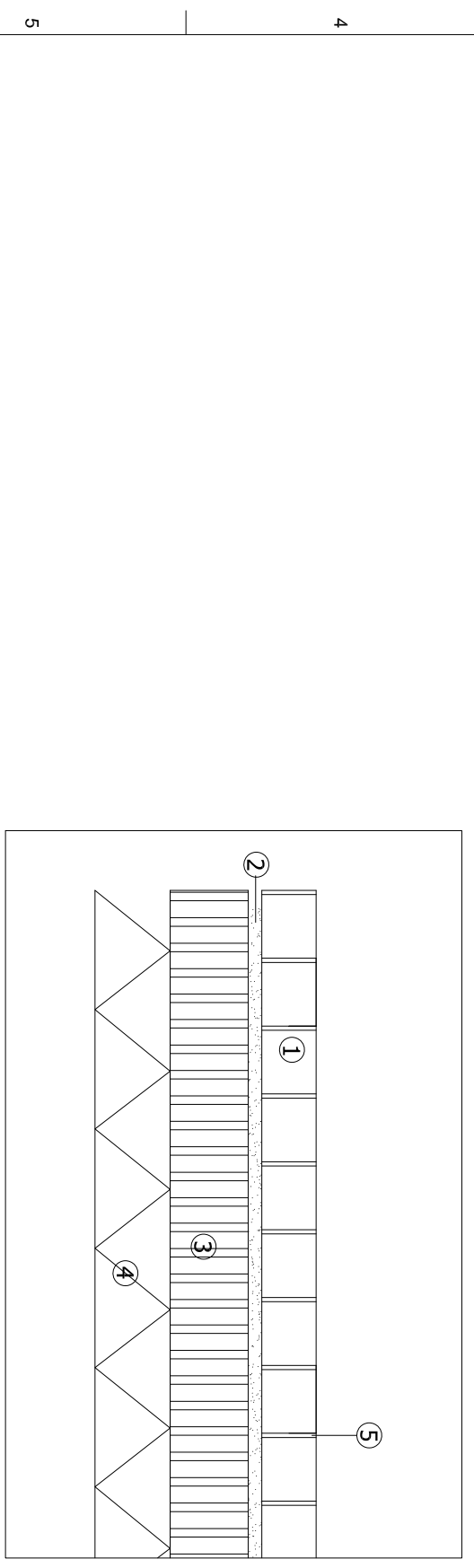

Typical Paving Construction

Notes:
 Drawing to be read in conjunction with all Works Information
 For proposed orientation refer to layouts
 Paving system including jointing and bedding to perform to
 BS 7533 Heavy vehicular over run.

Rev	Date	By	Chkd	Appd
P01	12/02/18	DM	AM	AH

Planning Issue

ARUP
 One Albert Quay
 Cork, Ireland
 Tel +353 (0)21 427 7670 Fax +353 (0)21 427 2345
 www.arup.com

the paulhogarth company

Project Title **Morrison's Island Public Realm and Flood Defence Project**
 Client **Cork City Council**
 City Hall
 Anglesea street
 Cork



Drawing Title **Parquet Typical Paving Details**

Scale at A3 1:10
 Role **Civil Infrastructure**
 Subtitle **Part 8 Planning**
 Arup Job No **230436-00**
 Name **MOR-5003**
 Rev **P01**