

SOUTH MAIN STREET - PLAN VIEW

LEGEND

<ul style="list-style-type: none"> Proposed Street Tree - Fastigate habit (4 no. Trees) Existing Tree to be removed Existing Kerb Line <p>HARDSCAPE:</p> <p>PAVING</p> <ul style="list-style-type: none"> Paving Type A - Dark Granite <ul style="list-style-type: none"> A1: Picked Finish, 150 x 150 x 150mm paving A2: Flamed Finish, 150 x 150 x 150mm paving A3: Picked Finish, 150 x 150 x 100mm paving at building threshold A4: Picked Finish, 150 x 150 x 150mm paving at Historic Laneway with artwork A5: Granite Cobbles, 100 x 100 x 100mm setts at building access and Hanover St. Paving Type B - Light Granite <ul style="list-style-type: none"> B1: Picked Finish, 150 x 150 x 150mm paving B2: Flamed Finish, 150 x 150 x 150mm paving Paving Type C <ul style="list-style-type: none"> C1: 600 x 300 x 80mm granite paving C2: 100 x 100 x 100mm granite sett at driving apron Paving Type D <ul style="list-style-type: none"> Red Granite - TBC to match Bishop Lucey Park Paving Type E <ul style="list-style-type: none"> Typical granite aggregate paving Paving Type F <ul style="list-style-type: none"> Alternating Dark and Light granite pavers at controlled Crossing Paving Type G <ul style="list-style-type: none"> Standard Cycle Lane - Red chip asphalt Paving Type H <ul style="list-style-type: none"> Standard chip asphalt Paving Type I <ul style="list-style-type: none"> Street print Asphalt/Concrete Paving Type J <ul style="list-style-type: none"> 100 x 100 x 100mm, blue grey limestone sets, fan-tail pattern (TBC) Paving Type K <ul style="list-style-type: none"> 100 x 100 x 100mm porphyry fan-tail paving (TBC) Paving Type L <ul style="list-style-type: none"> 600 x 450-900mm varied lengths, blue grey limestone, bush hammered (TBC) Paving Type M <ul style="list-style-type: none"> Permeable Resin Bound aggregate 	<p>KERBS</p> <ul style="list-style-type: none"> K1: Dark Stone Kerb <ul style="list-style-type: none"> 300x300x914mm dark granite, picked finish K2: Flush Kerb - Stone Banding <ul style="list-style-type: none"> 300x300x914mm dark granite, picked finish K3: Chamfered Stone Kerb at Cycle Lane <ul style="list-style-type: none"> 300x300x914mm dark granite with chamfered edge, picked finish K4: Light Stone Kerb <ul style="list-style-type: none"> 200x200x914mm light granite, picked finish K5: Standard Kerb <ul style="list-style-type: none"> Standard PC/Cast in Situ Kerb 	<p>TACTILE PAVING</p> <ul style="list-style-type: none"> Red Blister at controlled crossing <ul style="list-style-type: none"> 200x133x65mm clay bricks Blue Blister at uncontrolled crossing <ul style="list-style-type: none"> 200x133x65mm clay bricks Corduroy Hazard at uncontrolled crossing <ul style="list-style-type: none"> 200x100x65mm clay bricks Cycleway controlled slabs <ul style="list-style-type: none"> 400x400x50mm precast concrete tactile flags <p>SITE FEATURES/FURNISHINGS:</p> <ul style="list-style-type: none"> Planting Area Proposed SUDS Tree Pit System with Tree Grille Planter Box Proposed Raised Access Pedestrian Crossing Stone Seatwall Bench/Individual Seat Cafe Tables & Chairs Proposed Bollard and retention socket Existing Light Column to be removed Proposed Light Column location Proposed push button crossing signal Proposed slot drain location Proposed cycle stand location Relocated bike share terminal <p>*Mood images shown are meant to reflect the character of the site and may not depict exact features</p>
--	---	--

Rev	Date	Drawn	Checked	Description

Notes

Copyright © All Rights Reserved.
This work is copyright and cannot be reproduced or copied in any form without the written permission of the copyright owner. Work only from the original drawings.
This drawing to be read in conjunction with relevant consultant's drawings.

Ordnance Survey Ireland Licence No AR 0001319
© Ordnance Survey Ireland/Government of Ireland

Key Plan

North

Project: BEAMISH & CRAWFORD QUARTER INFRASTRUCTURE	Project No: 6813	BSM Est. 1968
Dwg: SITE PLAN	Drawing No: 301	
Scales: 1:200 @ A1	Status: Planning	Date: 12/07/2021
Penrose Wharf Business Centre, Penrose Wharf, Cork Tel: +353(0) 21 242 5620	mail@bradysjpmartin.com www.bradysjpmartin.com	Dwn: EG Chd: DB Passed

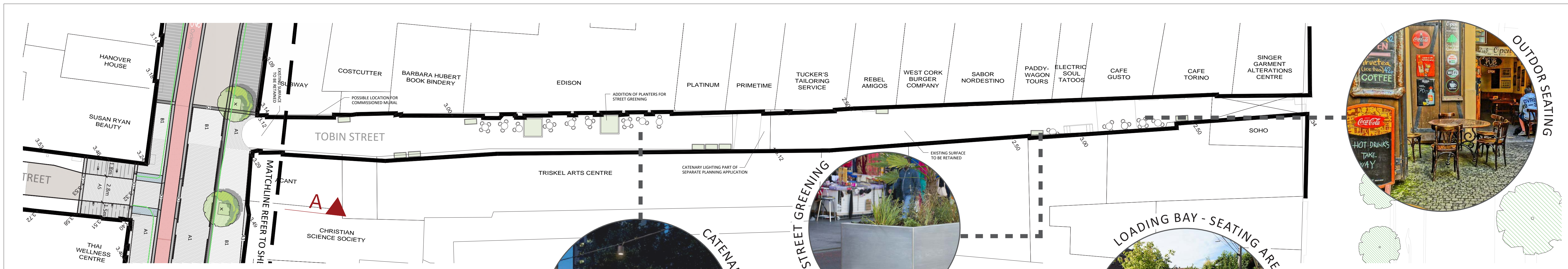

TOBIN STREET - PLAN VIEW

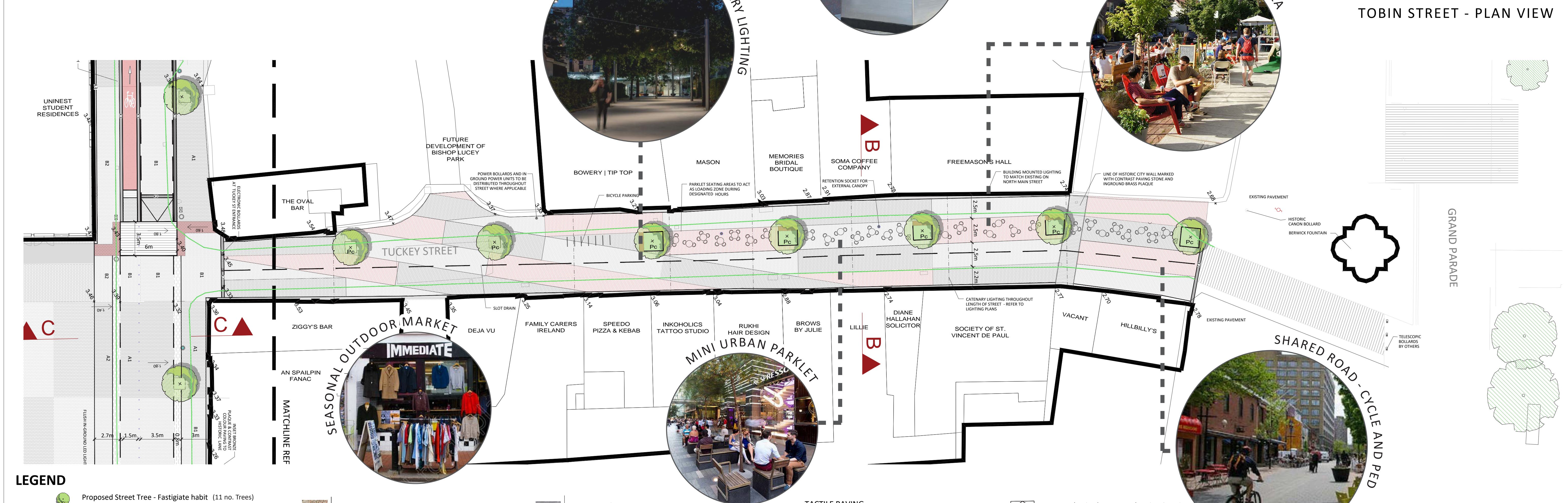

TUCKEY STREET - PLAN VIEW

- LEGEND**
- Proposed Street Tree - Fastigiate habit (11 no. Trees)
 - Existing Tree to be removed
 - Existing Kerb Line
- HARDSCAPE:**
- PAVING**
- Paving Type A - Dark Granite**
 - A1: Picked Finish, 150 x 150 x 150mm paving
 - A2: Flamed Finish, 150 x 150 x 150mm paving
 - A3: Picked Finish, 150 x 150 x 100mm paving at building threshold
 - A4: Picked Finish, 150 x 150 x 150mm paving at Historic Laneway with artwork
 - A5: Granite Cobbles, 100 x 100 x 100mm setts at building access and Hanover St.
 - Paving Type B - Light Granite**
 - B1: Picked Finish, 150 x 150 x 150mm paving
 - B2: Flamed Finish, 150 x 150 x 150mm paving
 - Paving Type C**
 - C1: 600 x 300 x 80mm granite paving
 - C2: 100 x 100 x 100mm granite sett at driving apron
 - Paving Type D**: Red Granite - TBC to match Bishop Lucey Park
 - Paving Type E**: Typical granite aggregate paving
 - Paving Type F**: Alternating Dark and Light granite pavers at controlled Crossing
 - Paving Type G**: Standard Cycle Lane - Red chip asphalt
 - Paving Type H**: Standard chip asphalt
 - Paving Type I**: Street print Asphalt/Concrete
 - Paving Type J**: 100 x 100 x 100mm, blue grey limestone setts, fan-tail pattern (TBC)
 - Paving Type K**: 100 x 100 x 100mm porphyry fan-tail paving (TBC)
 - Paving Type L**: 600 x 450-900mm varied lengths, blue grey limestone, bush hammered (TBC)
 - Paving Type M**: Permeable Resin Bound aggregate
- KERBS**
- K1: Dark Stone Kerb**: 300x300x914mm dark granite, picked finish
 - K2: Flush Kerb - Stone Banding**: 300x300x914mm dark granite, picked finish
 - K3: Chamfered Stone Kerb at Cycle Lane**: 300x300x914mm dark granite with chamfered edge, picked finish
 - K4: Light Stone Kerb**: 200x200x914mm light granite, picked finish
 - K5: Standard Kerb**: Standard PC/Cast in Situ Kerb

- TACTILE PAVING**
- Red Blister at controlled crossing: 200x133x65mm clay bricks
 - Blue Blister at uncontrolled crossing: 200x133x65mm clay bricks
 - Corduroy Hazard at uncontrolled crossing: 200x100x65mm clay bricks
 - Cycleway controlled slabs: 400x400x50mm precast concrete tactile flags
- SITE FEATURES/FURNISHINGS:**
- Planting Area
 - Proposed SUDS Tree Pit System with Tree Grille
 - Planter Box
 - Proposed Raised Access Pedestrian Crossing
 - Stone Seatwall
 - Bench/Individual Seat
 - Cafe Tables & Chairs
 - Proposed Bollard and retention socket
 - Existing Light Column to be removed
 - Proposed Light Column location
 - Proposed push button crossing signal
 - Proposed slot drain location
 - Proposed cycle stand location
 - Relocated bike share terminal
- *Mood images shown are meant to reflect the character of the site and may not depict exact features

Notes

Copyright © All Rights Reserved. This work is copyright and cannot be reproduced or copied in any form without the written permission of the draughtsman. Scale only from the drawings. Scale only from the drawings. This drawing to be read in conjunction with relevant consultant's drawings.

Key Plan

North

Project: BEAMISH & CRAWFORD QUARTER INFRASTRUCTURE
 Site: SITE PLAN
 Scales: 1:200 @ A1
 Status: Planning
 Project No: 6813
 Drawing No: 302
 Date: 12/07/2021
 Dm: EG
 Chd: DB
 Passed

BSM
Est. 1968

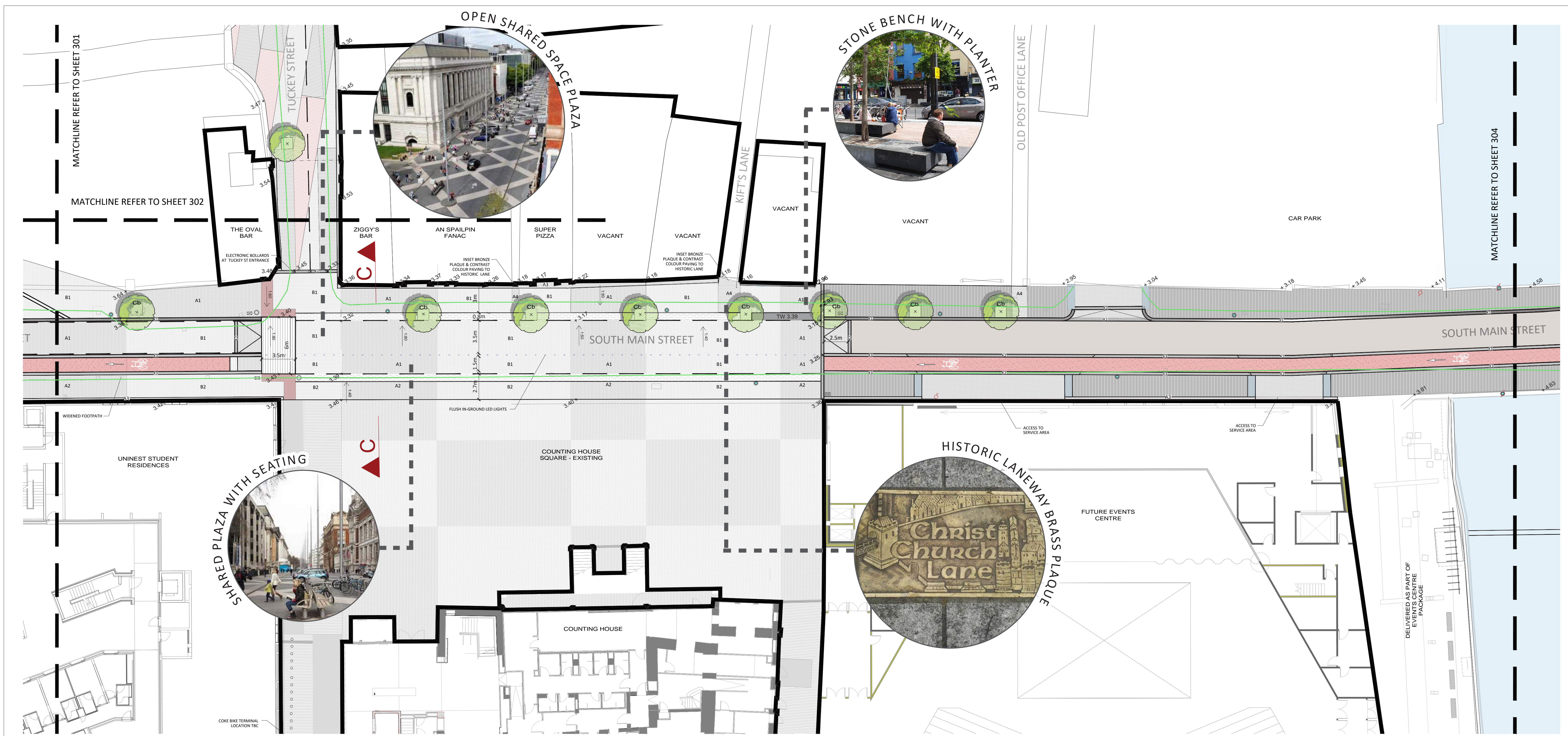

SOUTH MAIN STREET - PLAN VIEW

LEGEND

<ul style="list-style-type: none"> Proposed Street Tree - Fastigate habit (9 no. Trees) Existing Tree to be removed Existing Kerb Line <p>HARDSCAPE:</p> <p>PAVING</p> <p>Paving Type A - Dark Granite A1: Picked Finish, 150 x 150 x 150mm paving A2: Flamed Finish, 150 x 150 x 150mm paving A3: Picked Finish, 150 x 150 x 100mm paving at building threshold A4: Picked Finish, 150 x 150 x 150mm paving at Historic Laneway with artwork A5: Granite Cobbles, 100 x 100 x 100mm setts at building access and Hanover St.</p> <p>Paving Type B - Light Granite B1: Picked Finish, 150 x 150 x 150mm paving B2: Flamed Finish, 150 x 150 x 150mm paving</p> <p>Paving Type C C1: 600 x 300 x 80mm granite paving C2: 100 x 100 x 100mm granite sett at driving apron</p>	<p>Paving Type D Red Granite - TBC to match Bishop Lucey Park</p> <p>Paving Type E Typical granite aggregate paving</p> <p>Paving Type F Alternating Dark and Light granite pavers at controlled Crossing</p> <p>Paving Type G Standard Cycle Lane - Red chip asphalt</p> <p>Paving Type H Standard chip asphalt</p> <p>Paving Type I Street print Asphalt/Concrete</p> <p>Paving Type J 100 x 100 x 100mm, blue grey limestone setts, fan-tail pattern (TBC)</p> <p>Paving Type K 100 x 100 x 100mm porphyry fan-tail paving (TBC)</p>	<p>Paving Type L 600 x 450-900mm varied lengths, blue grey limestone, bush hammered (TBC)</p> <p>Paving Type M Permeable Resin Bound aggregate</p> <p>KERBS</p> <p>K1: Dark Stone Kerb 300x300x914mm dark granite, picked finish</p> <p>K2: Flush Kerb - Stone Banding 300x300x914mm dark granite, picked finish</p> <p>K3: Chamfered Stone Kerb at Cycle Lane 300x300x914mm dark granite with chamfered edge, picked finish</p> <p>K4: Light Stone Kerb 200x200x914mm light granite, picked finish</p> <p>K5: Standard Kerb Standard PC/Cast in Situ Kerb</p>	<p>TACTILE PAVING</p> <p>Red Blister at controlled crossing 200x133x65mm clay bricks</p> <p>Blue Blister at uncontrolled crossing 200x133x65mm clay bricks</p> <p>Corduroy Hazard at uncontrolled crossing 200x100x65mm clay bricks</p> <p>Cycleway controlled slabs 400x400x50mm precast concrete tactile flags</p> <p>SITE FEATURES/FURNISHINGS:</p> <p> Planting Area</p> <p> Proposed SUDS Tree Pit System with Tree Grille</p> <p> Planter Box</p>	<p> Proposed Raised Access Pedestrian Crossing</p> <p> Stone Seatwall</p> <p> Bench/Individual Seat</p> <p> Cafe Tables & Chairs</p> <p> Proposed Bollard and retention socket</p> <p> Existing Light Column to be removed</p> <p> Proposed Light Column location</p> <p> Proposed push button crossing signal</p> <p> Proposed slot drain location</p> <p> Proposed cycle stand location</p> <p> Relocated bike share terminal</p> <p><i>*Mood images shown are meant to reflect the character of the site and may not depict exact features</i></p>
---	---	---	---	---

<p>Notes</p> <p>Drawing in Irish Grid (ITM) meters format.</p> <p>Levels in Malin Head datum.</p>	<p>Copyright © All Rights Reserved.</p> <p>THIS WORK IS COPYRIGHT AND CANNOT BE REPRODUCED OR COPIED IN ANY FORM WITHOUT THE WRITTEN PERMISSION OF THE ORGANISATION.</p> <p>DO NOT SCALE FROM THIS DRAWING. WORK ONLY FROM DIMENSIONS.</p> <p>THIS DRAWING TO BE READ IN CONJUNCTION WITH RELEVANT CONSULTANT'S DRAWINGS.</p>	<p>Key Plan</p>	<p>North</p>	<table border="1"> <tr> <td>Project</td> <td>BEAMISH & CRAWFORD QUARTER INFRASTRUCTURE</td> <td>Project No.</td> <td>6813</td> </tr> <tr> <td>Dwg.</td> <td>SITE PLAN</td> <td>Drawing No.</td> <td>303</td> </tr> <tr> <td>Scale</td> <td>1:200 @ A1</td> <td>Status</td> <td>Planning</td> </tr> <tr> <td>Date</td> <td>12/07/2021</td> <td>Drn.</td> <td>EG</td> </tr> <tr> <td>Checked</td> <td>DB</td> <td>Passed</td> <td></td> </tr> </table>	Project	BEAMISH & CRAWFORD QUARTER INFRASTRUCTURE	Project No.	6813	Dwg.	SITE PLAN	Drawing No.	303	Scale	1:200 @ A1	Status	Planning	Date	12/07/2021	Drn.	EG	Checked	DB	Passed		<p>BSM</p> <p>Est. 1968</p>
Project	BEAMISH & CRAWFORD QUARTER INFRASTRUCTURE	Project No.	6813																						
Dwg.	SITE PLAN	Drawing No.	303																						
Scale	1:200 @ A1	Status	Planning																						
Date	12/07/2021	Drn.	EG																						
Checked	DB	Passed																							