

DRAWING IS PRODUCED USING THE IRISH TRANSVERSE MERCATOR (ITM) GEOGRAPHIC COORDINATE SYSTEM

**A1**

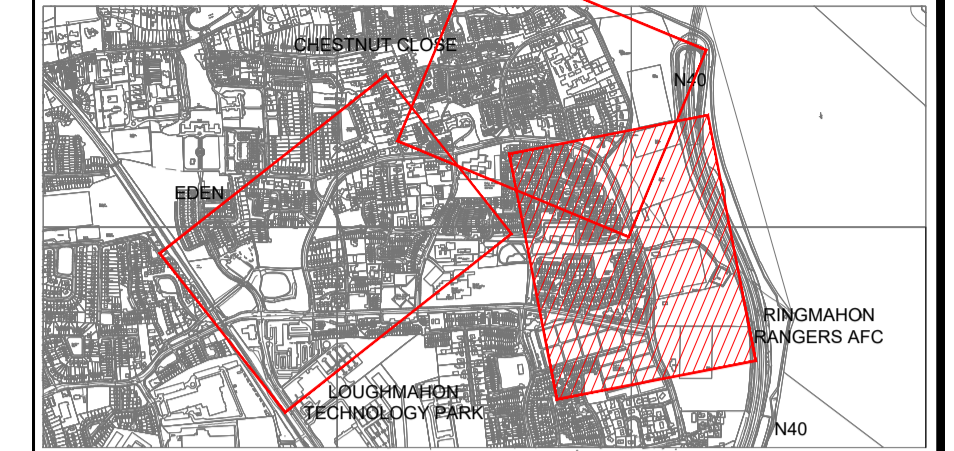

**KEY PLAN** Scale N.T.S.

**LEGEND :**

- CARRIAGEWAY -
- PROPOSED CONCRETE PATH -
- LANDSCAPED AREA -
- RAISED CROSSING -
- PROPOSED CYCLE PATH -
- PROPOSED CYCLE LANE -
- EXISTING BUS LANE / STOP -
- PARKING -
- SHARED SPACE -
- PROPOSED TACTILE PAVING -
- PROPOSED TREE -
- EXISTING TREE TO BE RETAINED -
- EXISTING TREE TO BE REMOVED -

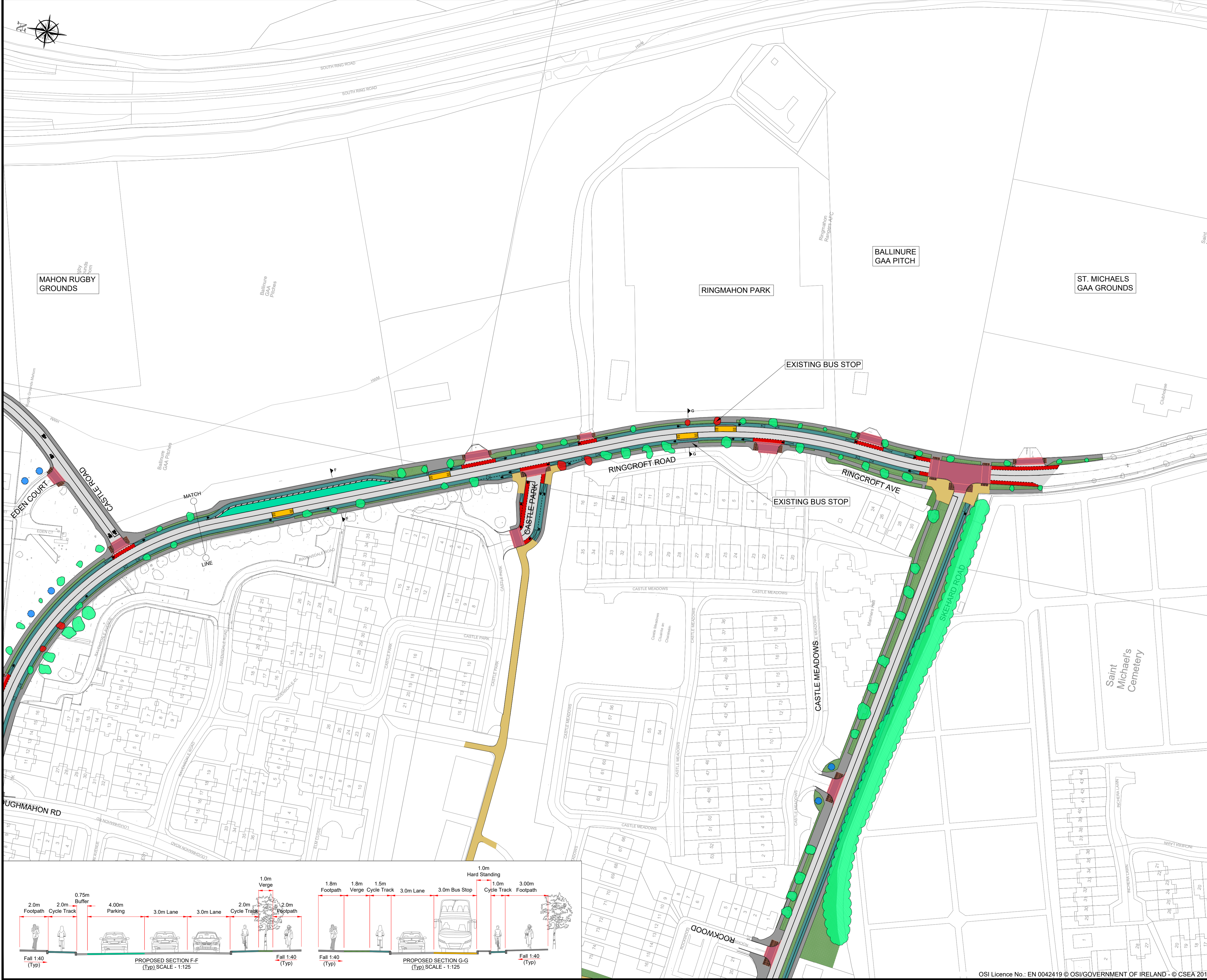

Rev	Description	Drawn	Checked	Date
P01	ISSUE FOR SECTION 38	MR	CB	17.01.22

**Clifton Scannell Emerson Associates**

Clifton Scannell Emerson Associates Limited  
Consulting Engineers,  
3rd Floor The Highline,  
Bakers Point, Pottery Road,  
Dun Laoghaire, Co. Dublin,  
Ireland, A96 KW29

T: +353 1 288 5006  
F: +353 1 283 3468  
E: info@csea.ie  
W: www.csea.ie

Client: **CORK CITY COUNCIL**

Project: **MAHON CYCLING SCHEME**

Dwg. Title: **RINGMAHON ROAD - PROPOSED LAYOUT SHEET 3 OF 3**

Drawn By	MR	Date	09.12.21	21_036
Checked By	CB	Scale	1:1000 @ A1	
Project Code	21_036 - CSE - GEN - XX - DR - C - 2108	Originator	CSEA Job No.	
Status Code	S2 FOR SECTION 38	Zone/Phase	Level	Type
Revision	P01 PRELIMINARY	Role	Dwg. No.	

