

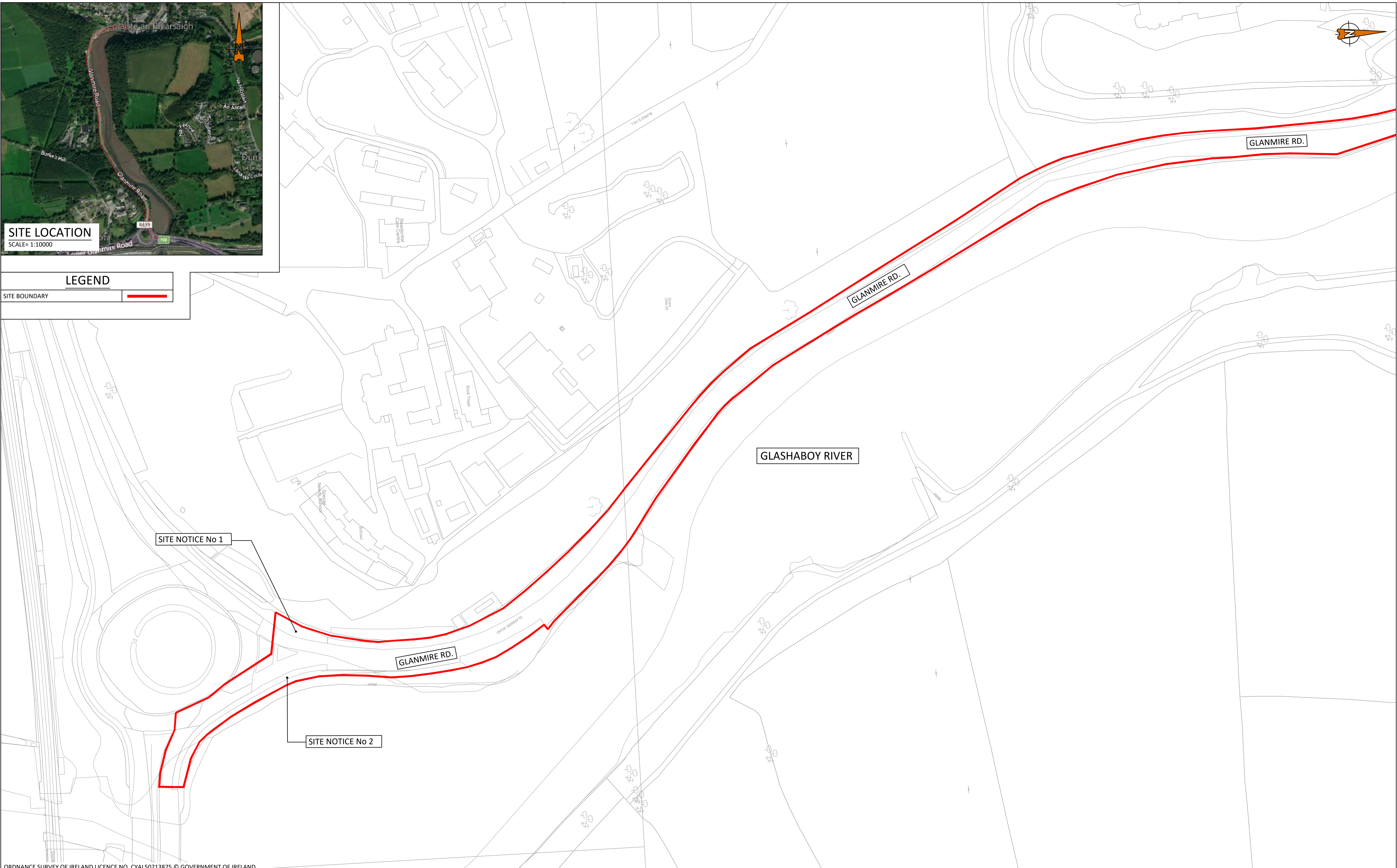

SITE LOCATION
SCALE= 1:10000

LEGEND	
SITE BOUNDARY	



ORDNANCE SURVEY OF IRELAND LICENCE NO. CYAL50213875 © GOVERNMENT OF IRELAND

- FOR SETTING OUT REFER TO ARCHITECT'S DRAWINGS.
- THIS DRAWING TO BE READ IN CONJUNCTION WITH ALL OTHER ARCHITECTURAL AND ENGINEERING DRAWINGS AND ALL OTHER RELEVANT DRAWINGS AND SPECIFICATIONS.
- DO NOT SCALE THIS DRAWING. USE FIGURED DIMENSIONS ONLY.
- NO PART OF THIS DOCUMENT MAY BE REPRODUCED OR TRANSMITTED IN ANY FORM OR STORED IN ANY RETRIEVAL SYSTEM OF ANY NATURE WITHOUT THE WRITTEN PERMISSION OF O'CONNOR SUTTON CROMIN AS COPYRIGHT HOLDER EXCEPT AS AGREED FOR USE ON THE PROJECT FOR WHICH THE DOCUMENT WAS ORIGINALLY ISSUED.

Rev No.	Date	Revision Note	Drn by	Chkd by	Rev No.	Date	Revision Note	Drn by	Chkd by
C01	21/05/21	SUITABLE FOR INFORMATION	LS	CW					

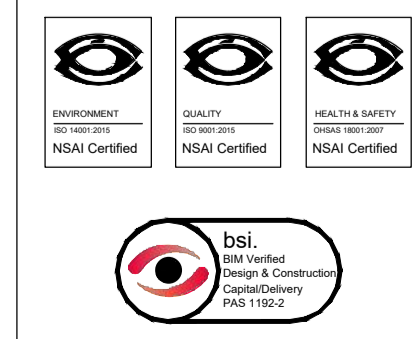

Head Office,
9 Prussia Street,
Dublin 7.
D07 KT57

TEL +353 (0)1 8682000
e: contactus@ocsc.ie
w: www.ocsc.ie



Dublin | London | Belfast | Galway | Cork | Birmingham

Client:	Cork City Council								
Project:	Cork City Infrastructure Development Glanmire To City Cycle Route (Phase 1)								
Title:	Part 8 Drawings Site Location Sheet 1 of 2								
Code	Originator	Zone	Level	Type	Role	Number	Status	Revision	
C1001	OCSC	ZZ	XX	DR	C	0001	A3	C01	
Date:	04/10/21		Scale:	1:2000@ A1		Drn by:	LS	Chkd by:	CW
						Aprvd by:	BO'R		



SITE LOCATION
SCALE= 1:10000

LEGEND	
SITE BOUNDARY	



ORDNANCE SURVEY OF IRELAND LICENCE NO. CYAL50213875 © GOVERNMENT OF IRELAND

- FOR SETTING OUT REFER TO ARCHITECT'S DRAWINGS.
- THIS DRAWING TO BE READ IN CONJUNCTION WITH ALL OTHER ARCHITECTURAL AND ENGINEERING DRAWINGS AND ALL OTHER RELEVANT DRAWINGS AND SPECIFICATIONS.
- DO NOT SCALE THIS DRAWING. USE FIGURED DIMENSIONS ONLY.
- NO PART OF THIS DOCUMENT MAY BE REPRODUCED OR TRANSMITTED IN ANY FORM OR STORED IN ANY RETRIEVAL SYSTEM OF ANY NATURE WITHOUT THE WRITTEN PERMISSION OF O'CONNOR SUTTON CRONIN AS COPYRIGHT HOLDER EXCEPT AS AGREED FOR USE ON THE PROJECT FOR WHICH THE DOCUMENT WAS ORIGINALLY ISSUED.

Rev No.	Date	Revision Note	Drn by	Chkd by	Rev No.	Date	Revision Note	Drn by	Chkd by
C01	21/05/21	SUITABLE FOR INFORMATION	LS	CW					



Head Office,
9 Prussia Street,
Dublin 7.
D07 KT57

TEL +353 (0)1 8682000

e: contactus@ocsc.ie
w: www.ocsc.ie

Dublin | London | Belfast | Galway | Cork | Birmingham



Client:	Cork City Council										
Project:	Cork City Infrastructure Development Glanmire To City Cycle Route (Phase 1)										
Title:	Part 8 Drawings Site Location Sheet 2 of 2										
Code	Originator	Zone	Level	Type	Role	Number	Status	Revision			
C1001	OCSC	ZZ	XX	DR	C	0002	A3	C01			
Date:	04/10/21		Scale:	1:2000@ A1		Drn by:	LS	Chkd by:	CW	Aprvd by:	BO'R

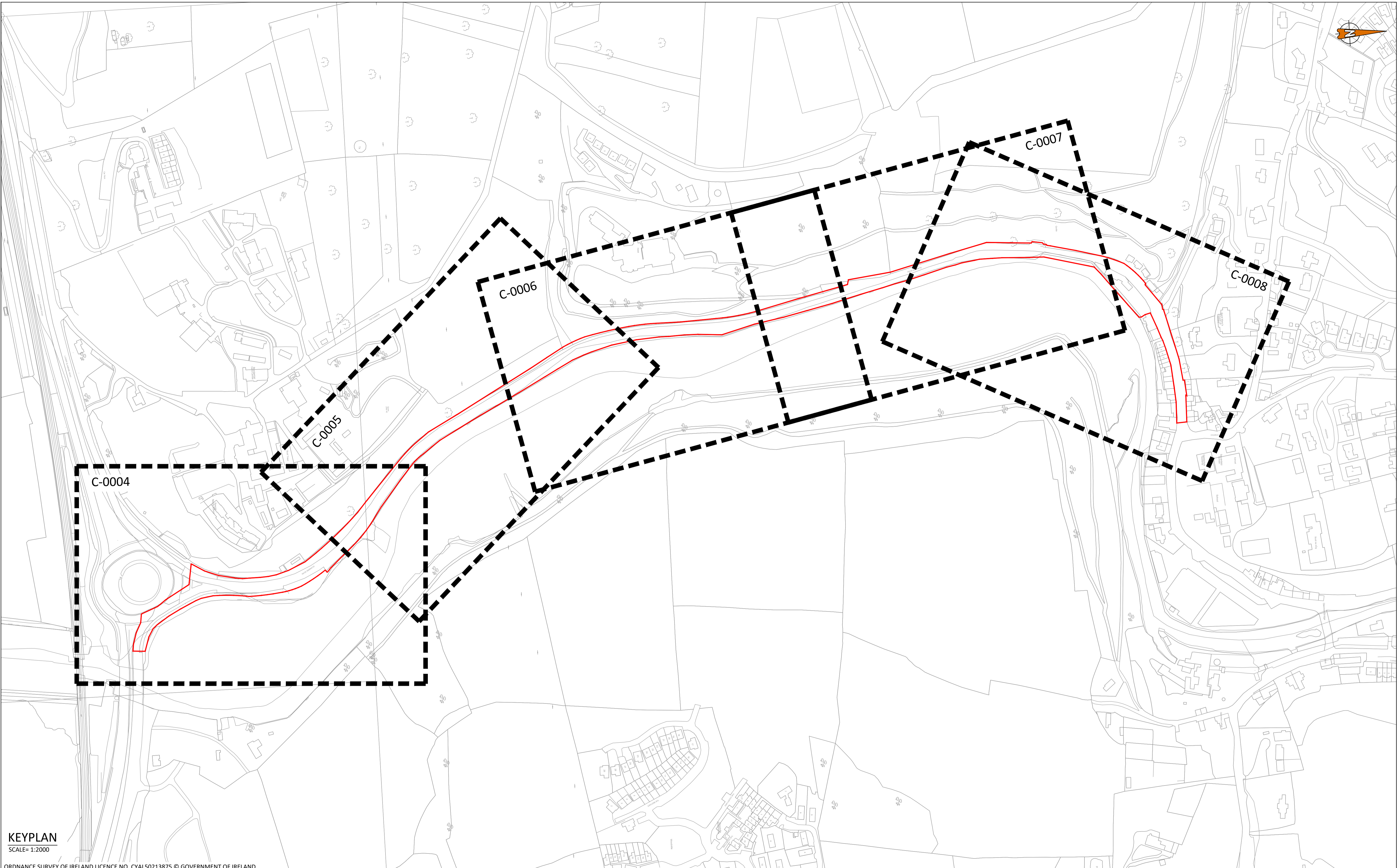

KEYPLAN
SCALE= 1:2000

ORDNANCE SURVEY OF IRELAND LICENCE NO. CYAL50213875 © GOVERNMENT OF IRELAND

- FOR SETTING OUT REFER TO ARCHITECT'S DRAWINGS.
- THIS DRAWING TO BE READ IN CONJUNCTION WITH ALL OTHER ARCHITECTURAL AND ENGINEERING DRAWINGS AND ALL OTHER RELEVANT DRAWINGS AND SPECIFICATIONS.
- DO NOT SCALE THIS DRAWING. USE FIGURED DIMENSIONS ONLY.
- NO PART OF THIS DOCUMENT MAY BE REPRODUCED OR TRANSMITTED IN ANY FORM OR STORED IN ANY RETRIEVAL SYSTEM OF ANY NATURE WITHOUT THE WRITTEN PERMISSION OF O'CONNOR SUTTON CRONIN AS COPYRIGHT HOLDER EXCEPT AS AGREED FOR USE ON THE PROJECT FOR WHICH THE DOCUMENT WAS ORIGINALLY ISSUED.

Rev No.	Date	Revision Note	Drn by	Chkd by
C01	21/05/21	SUITABLE FOR INFORMATION	LS	CW

Rev No.	Date	Revision Note	Drn by	Chkd by

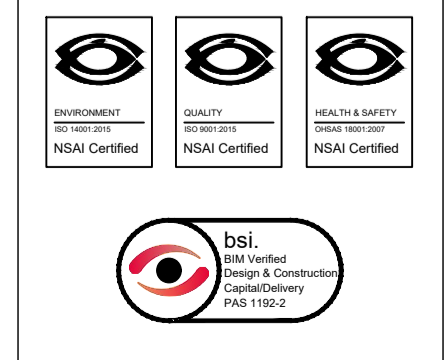

Head Office,
9 Prussia Street,
Dublin 7,
D07 KT57



TEL +353 (0)1 8682000
e: contactus@ocsc.ie
w: www.ocsc.ie

Dublin | London | Belfast | Galway | Cork | Birmingham

Client:	Cork City Council							
Project:	Cork City Infrastructure Development Glanmire To City Cycle Route (Phase 1)							
Title:	Part 8 Drawings Site Layout Plan Keyplan							
Code	Originator	Zone	Level	Type	Role	Number	Status	Revision
C1001	OCSC	ZZ	XX	DR	C	0003	A3	C01
Date:	04/10/21 Scale: 1:2000 @ A1 Drn by: LS Chkd by: CW Aprvd by: BO'R							

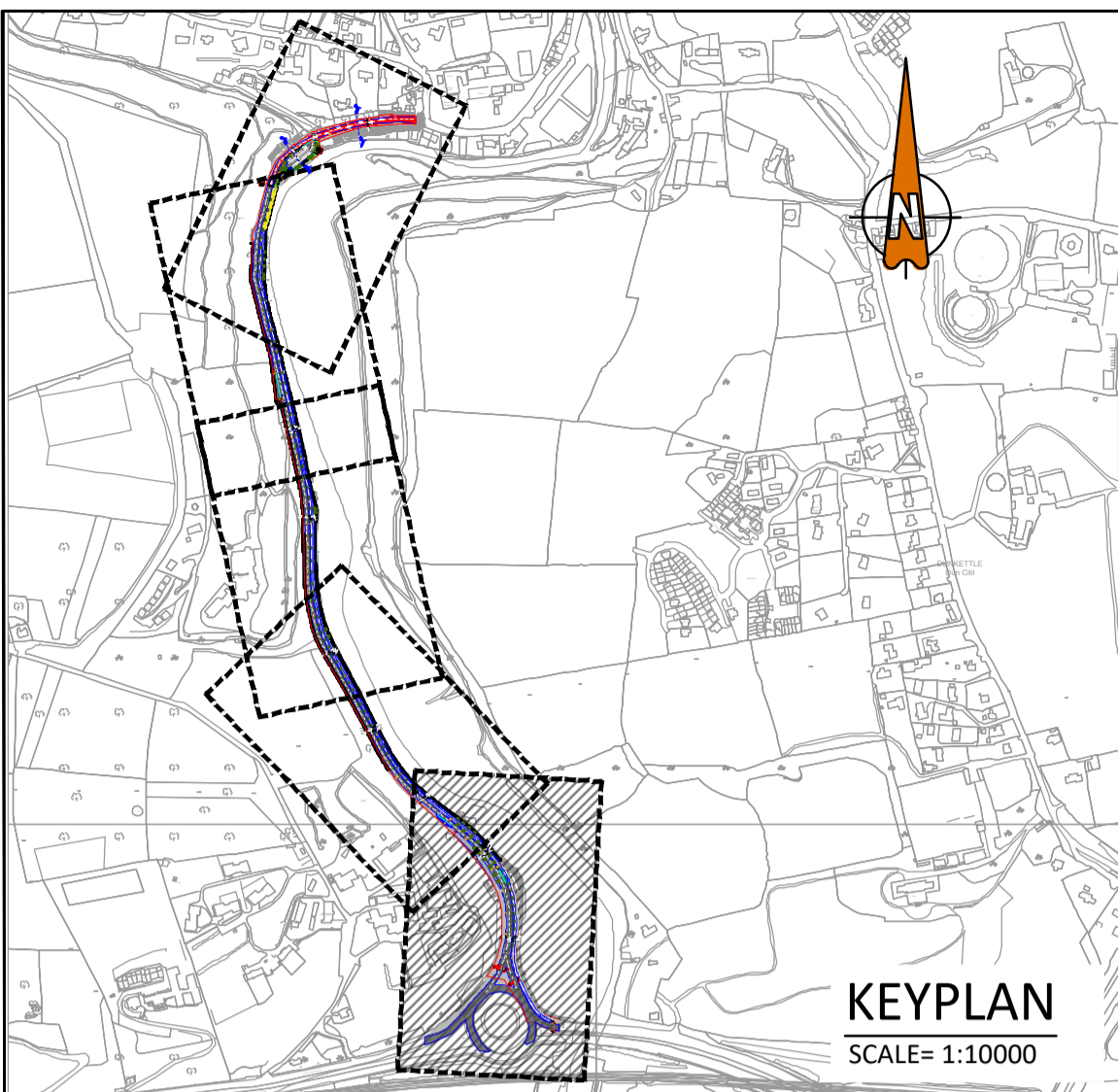

LEGEND	
PROPOSED ROAD SURFACE	
PROPOSED FOOTPATH	
PROPOSED VERGE	
PROPOSED CYCLE LANE OFF ROAD	
BOARDWALK	
GRASS CRETE	
PROPOSED RED COLOUR SURFACE	
PROPOSED COBBLESTONE SURFACE	
TACTILE PAVING ON CONTROLLED CROSSING	
TACTILE PAVING ON UN-CONTROLLED CROSSING	
WALL	
PROPOSED 125mm KERB	
PROPOSED FLUSH KERB	
PROPOSED TRANSITION KERB	
PROPOSED TREES	
PROPOSED ROAD SIGN	
PUBLIC LIGHTING	

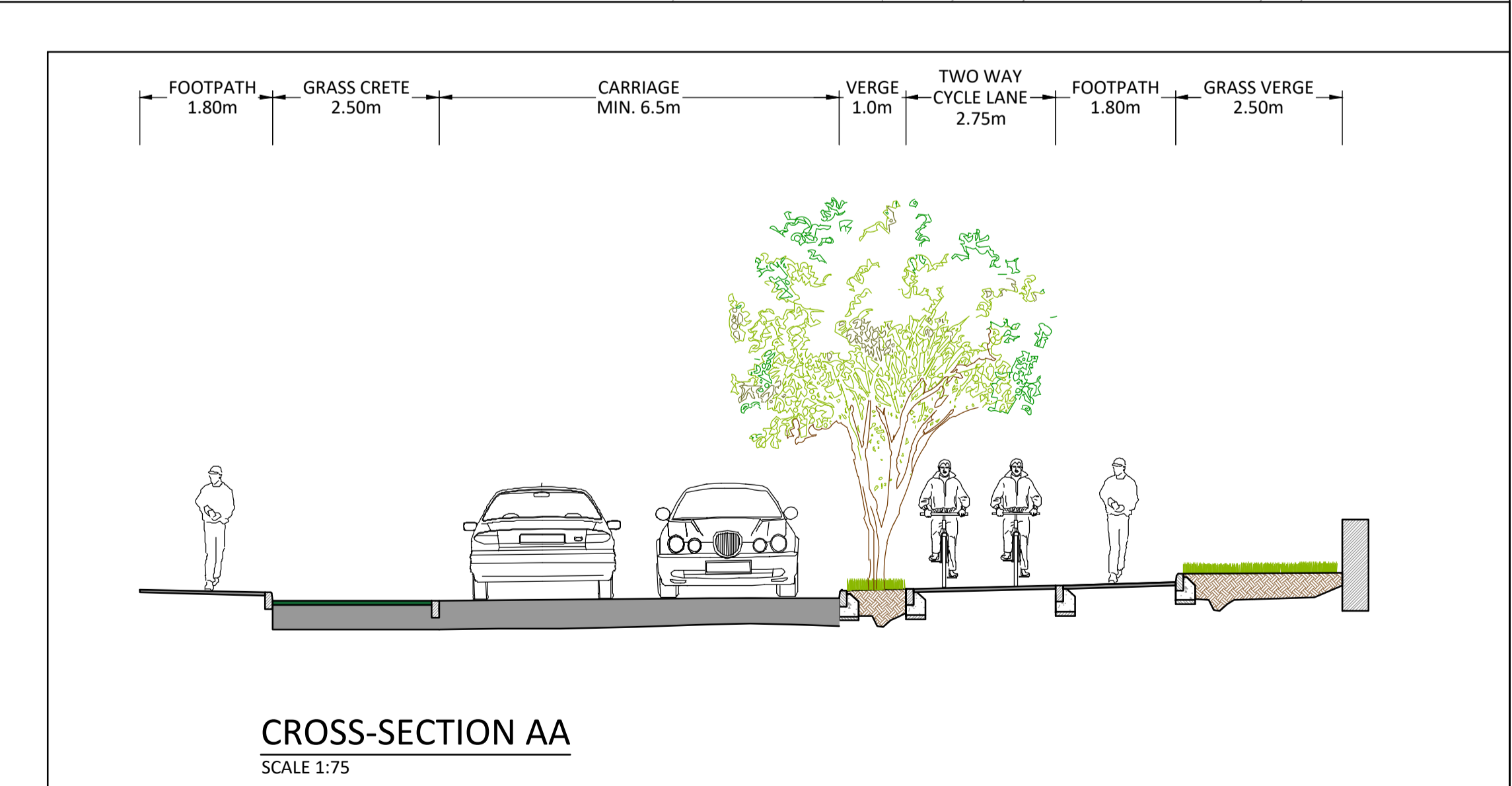
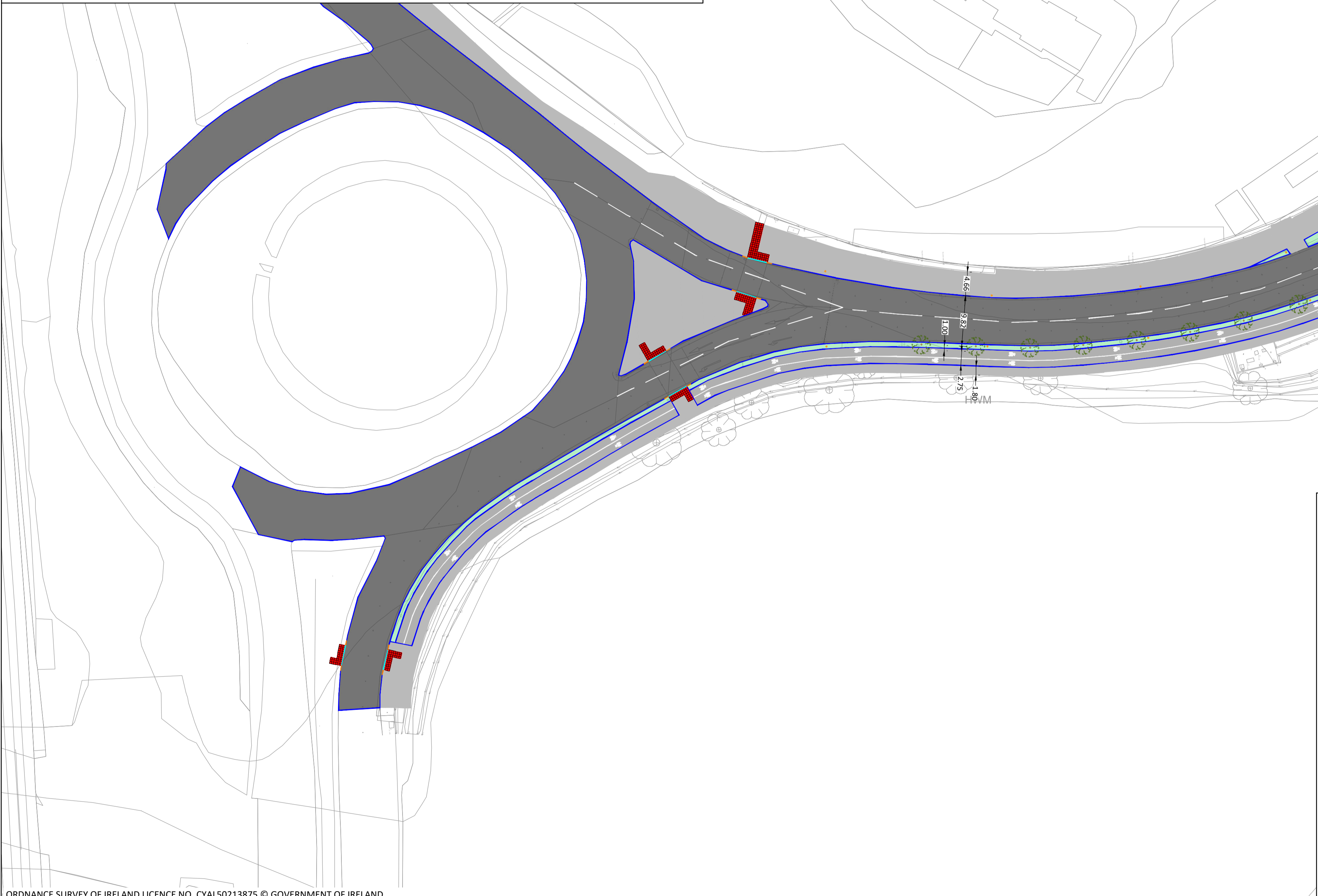
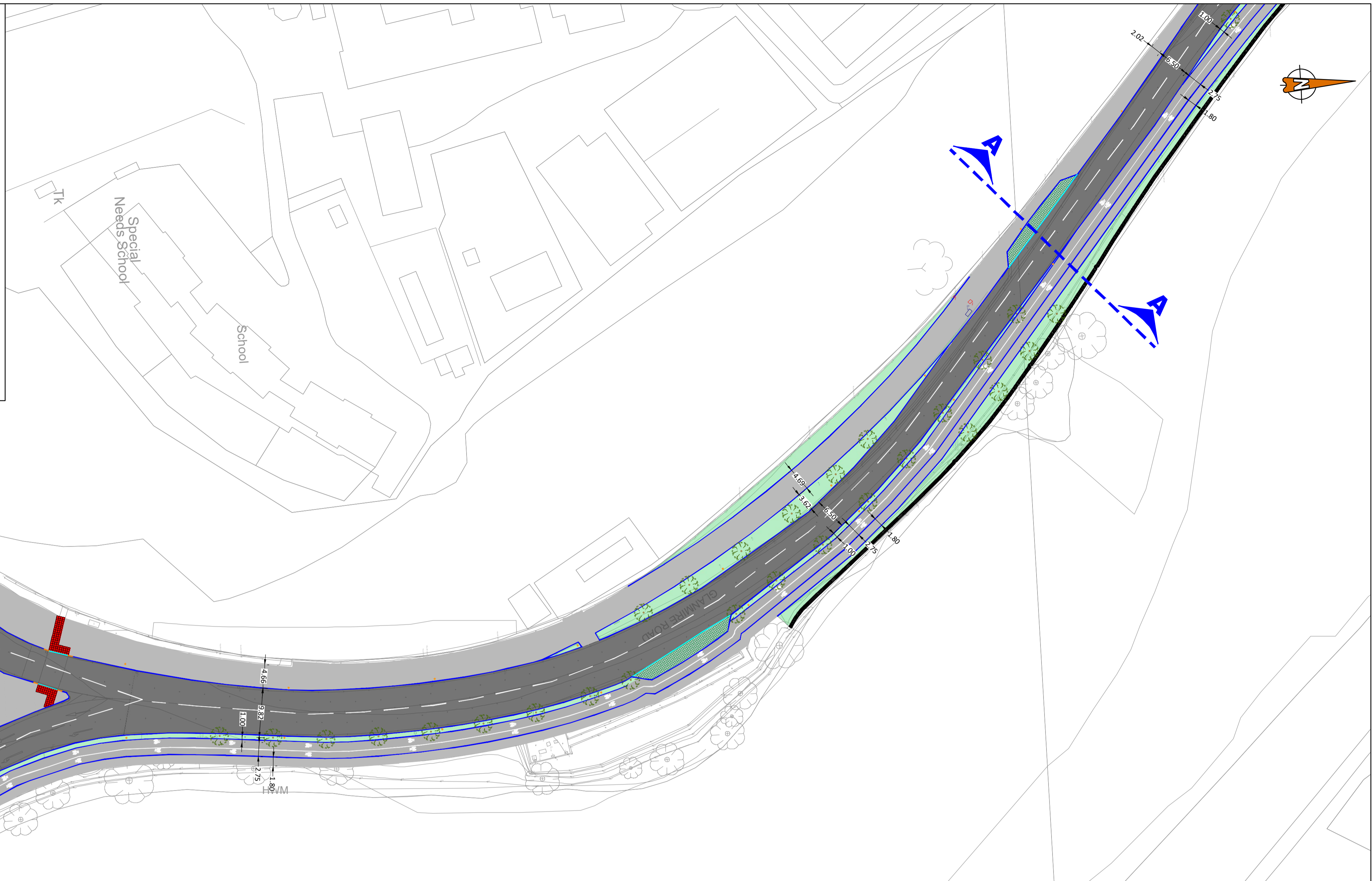

ORDNANCE SURVEY OF IRELAND LICENCE NO. CYAL50213875 © GOVERNMENT OF IRELAND

- FOR SETTING OUT REFER TO ARCHITECT'S DRAWINGS.
- THIS DRAWING TO BE READ IN CONJUNCTION WITH ALL OTHER ARCHITECTURAL AND ENGINEERING DRAWINGS AND ALL OTHER RELEVANT DRAWINGS AND SPECIFICATIONS.
- DO NOT SCALE THIS DRAWING. USE FIGURED DIMENSIONS ONLY.
- NO PART OF THIS DOCUMENT MAY BE REPRODUCED OR TRANSMITTED IN ANY FORM OR STORED IN ANY RETRIEVAL SYSTEM OF ANY NATURE WITHOUT THE WRITTEN PERMISSION OF O'CONNOR SUTTON CRONIN AS COPYRIGHT HOLDER EXCEPT AS AGREED FOR USE ON THE PROJECT FOR WHICH THE DOCUMENT WAS ORIGINALLY ISSUED.

Rev No.	Date	Revision Note	Drn by	Chkd by	Rev No.	Date	Revision Note	Drn by	Chkd by
C01	21/05/21	SUITABLE FOR INFORMATION	LS	CW					

Cork City Council
9 Prussia Street,
Dublin 7,
D07 KT57

TEL +353 (0)1 8682000

e: contactus@ocsc.ie
w: www.ocsc.ie

Dublin | London | Belfast | Galway | Cork | Birmingham

OCSC
O'CONNOR SUTTON CRONIN
Multidisciplinary
Consulting Engineers

Client: **Cork City Council**
Project: **Cork City Infrastructure Development
Glanmire To City Cycle Route (Phase 1)**
Title: **Part 8 Drawings
Site Layout Plan
Sheet 1 of 5**

Code	Originator	Zone	Level	Type	Role	Number	Status	Revision
C1001	OCSC	ZZ	XX	DR	C	0004	A3	C01

Date: 04/10/21 Scale: 1:500 @ A1 Drn by: LS Chkd by: CW Aprvd by: BO'R

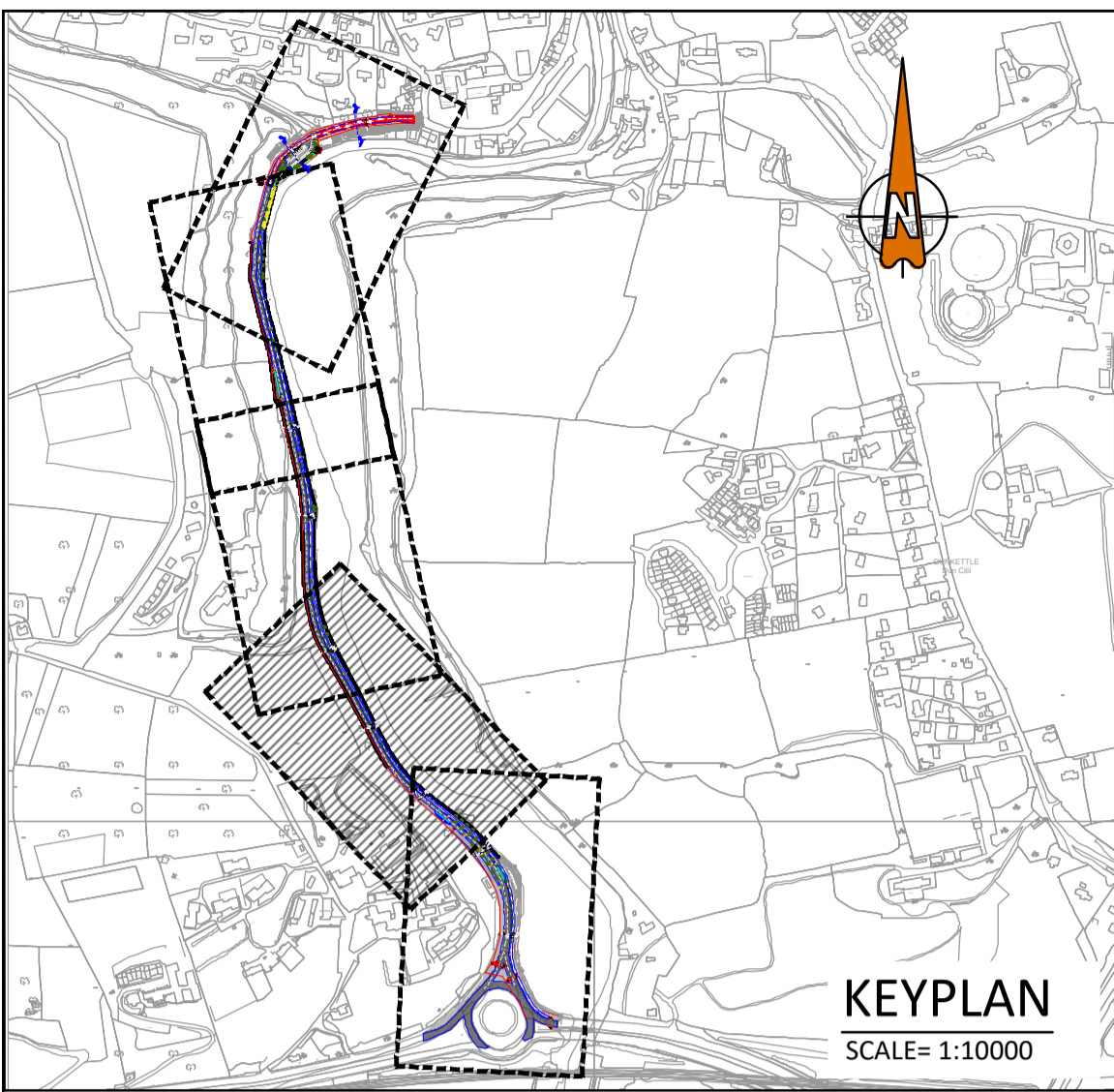

LEGEND	
PROPOSED ROAD SURFACE	
PROPOSED FOOTPATH	
PROPOSED VERGE	
PROPOSED CYCLE LANE OFF ROAD	
BOARDWALK	
GRASS CRETE	
PROPOSED RED COLOUR SURFACE	
PROPOSED COBBLESTONE SURFACE	
TACTILE PAVING ON CONTROLLED CROSSING	
TACTILE PAVING ON UN-CONTROLLED CROSSING	
WALL	
PROPOSED 125mm KERB	
PROPOSED FLUSH KERB	
PROPOSED TRANSITION KERB	
PROPOSED TREES	
PROPOSED ROAD SIGN	
PUBLIC LIGHTING	

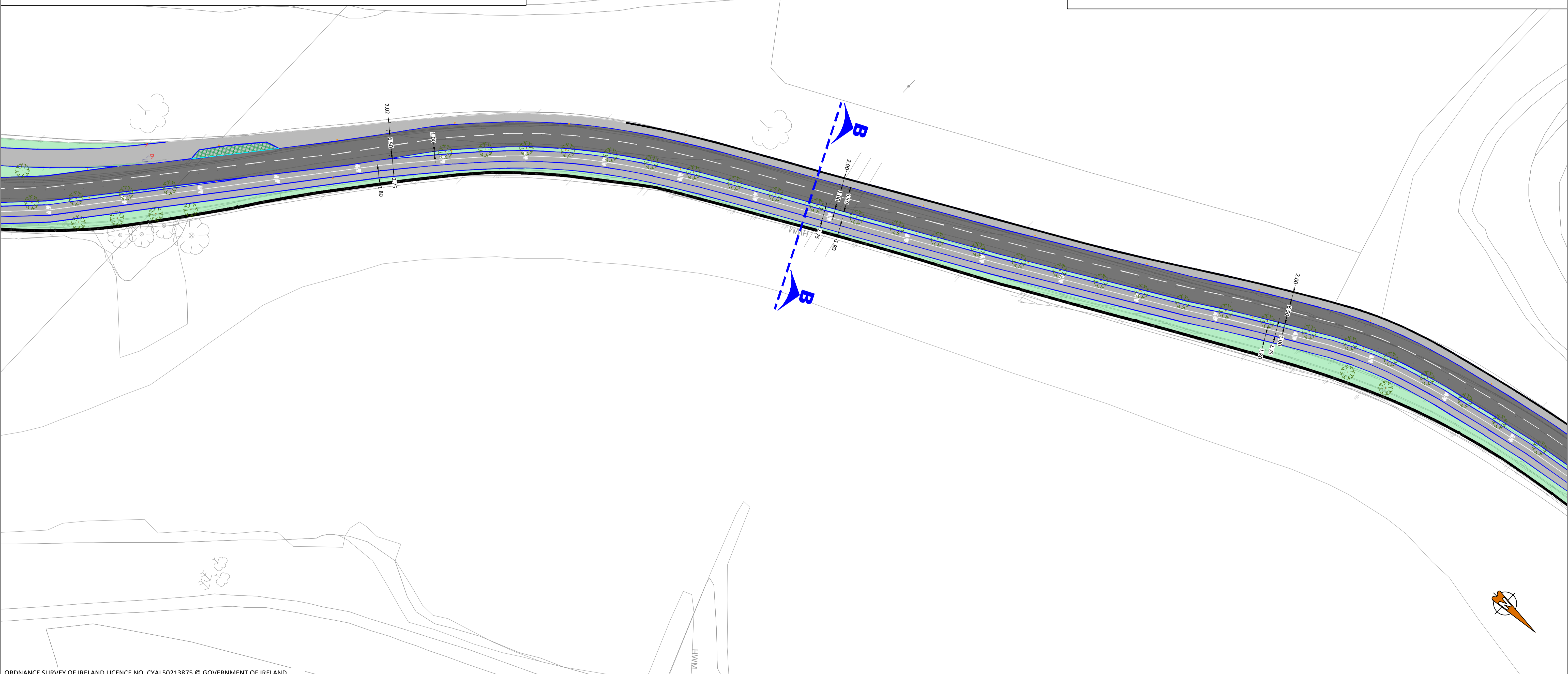
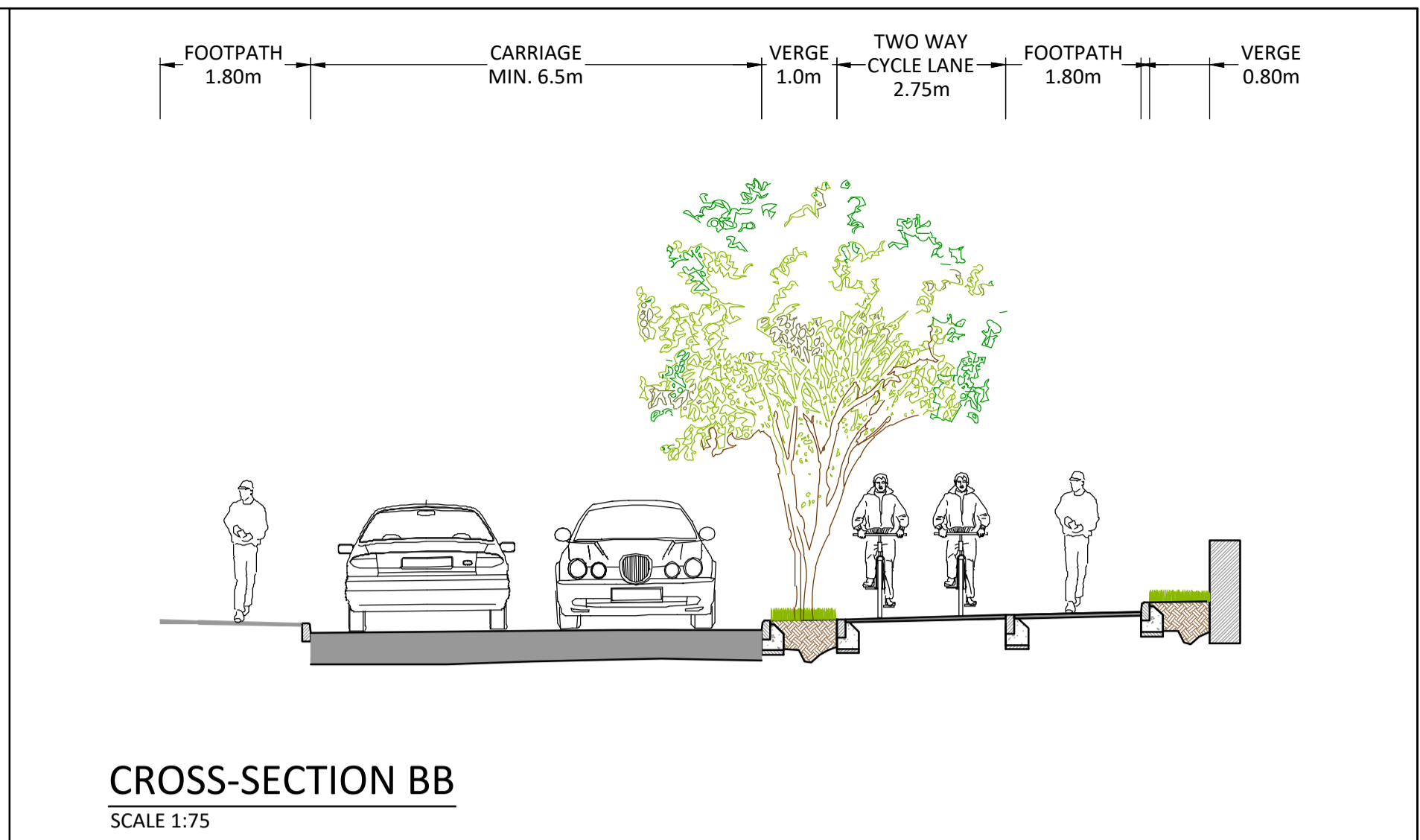

ORDNANCE SURVEY OF IRELAND LICENCE NO. CYAL50213875 © GOVERNMENT OF IRELAND

- FOR SETTING OUT REFER TO ARCHITECT'S DRAWINGS.
- THIS DRAWING TO BE READ IN CONJUNCTION WITH ALL OTHER ARCHITECTURAL AND ENGINEERING DRAWINGS AND ALL OTHER RELEVANT DRAWINGS AND SPECIFICATIONS.
- DO NOT SCALE THIS DRAWING. USE FIGURED DIMENSIONS ONLY.
- NO PART OF THIS DOCUMENT MAY BE REPRODUCED OR TRANSMITTED IN ANY FORM OR STORED IN ANY RETRIEVAL SYSTEM OF ANY NATURE WITHOUT THE WRITTEN PERMISSION OF O'CONNOR SUTTON CRONIN AS COPYRIGHT HOLDER EXCEPT AS AGREED FOR USE ON THE PROJECT FOR WHICH THE DOCUMENT WAS ORIGINALLY ISSUED.

Rev No.	Date	Revision Note	Drn by	Chkd by	Rev No.	Date	Revision Note	Drn by	Chkd by
C01	21/05/21	SUITABLE FOR INFORMATION	LS	CW					



Head Office,
9 Prussia Street,
Dublin 7.
D07 KT57

TEL +353 (0)1 8682000

e: contactus@ocsc.ie
w: www.ocsc.ie

Dublin | London | Belfast | Galway | Cork | Birmingham



Client:	Cork City Council							
Project:	Cork City Infrastructure Development Glanmire To City Cycle Route (Phase 1)							
Title:	Part 8 Drawings Site Layout Plan Sheet 2 of 5							
Code	Originator	Zone	Level	Type	Role	Number	Status	Revision
C1001	OCSC	ZZ	XX	DR	C	0005	A3	C01
Date:	04/10/21 Scale: 1:500 @ A1 Drn by: LS Chkd by: CW Aprvd by: BO'R							

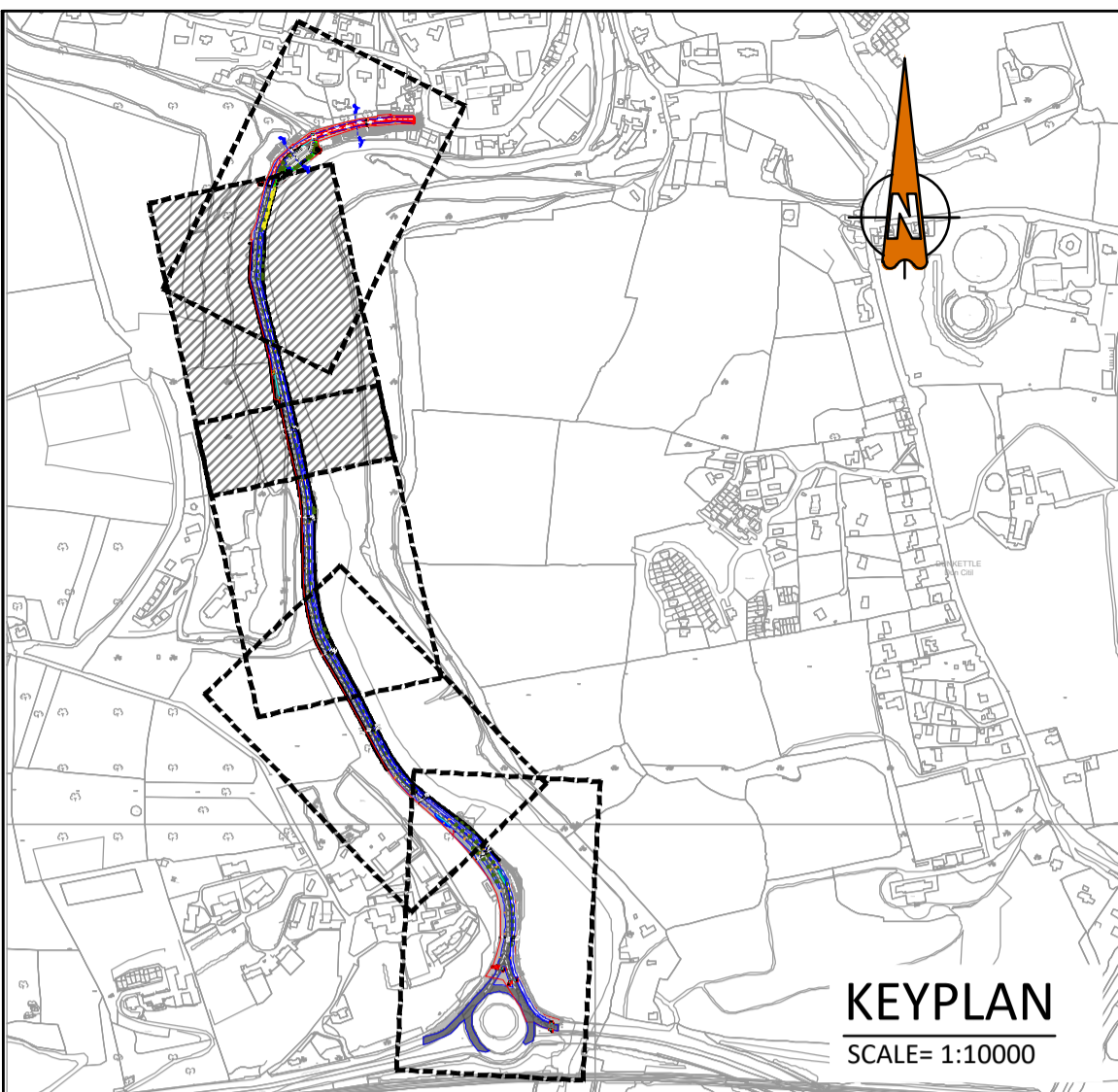

LEGEND	
PROPOSED ROAD SURFACE	
PROPOSED FOOTPATH	
PROPOSED VERGE	
PROPOSED CYCLE LANE OFF ROAD	
BOARDWALK	
GRASS CRETE	
PROPOSED RED COLOUR SURFACE	
PROPOSED COBBLESTONE SURFACE	
TACTILE PAVING ON CONTROLLED CROSSING	
TACTILE PAVING ON UN-CONTROLLED CROSSING	
WALL	
PROPOSED 125mm KERB	
PROPOSED FLUSH KERB	
PROPOSED TRANSITION KERB	
PROPOSED TREES	
PROPOSED ROAD SIGN	
PUBLIC LIGHTING	

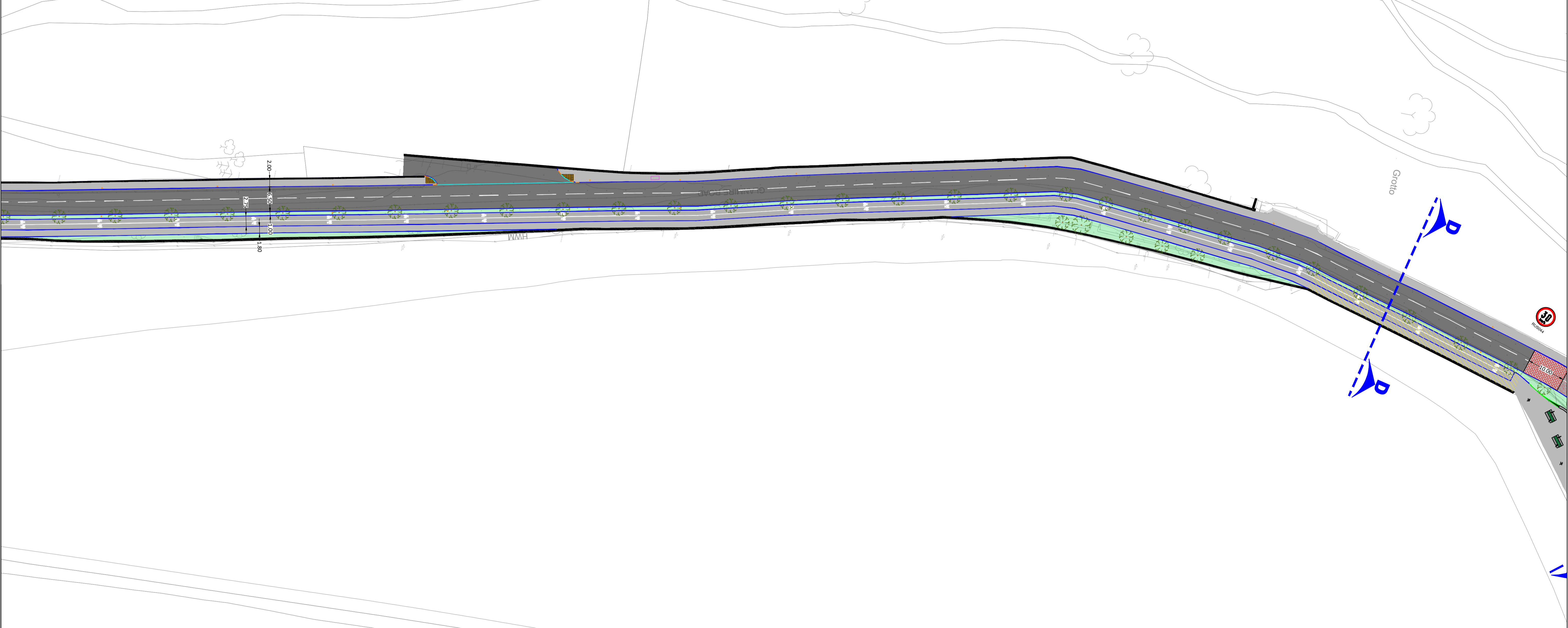
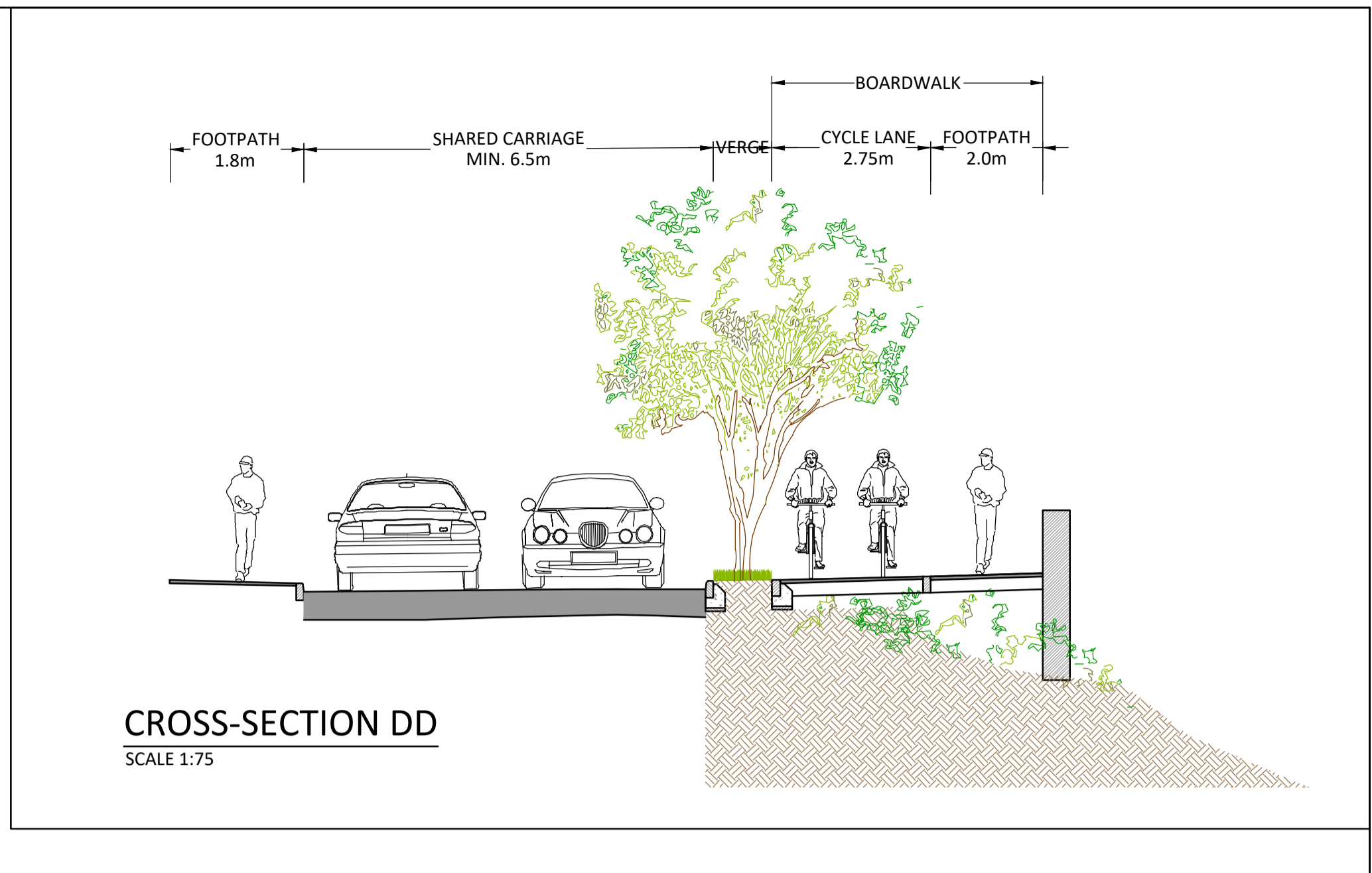
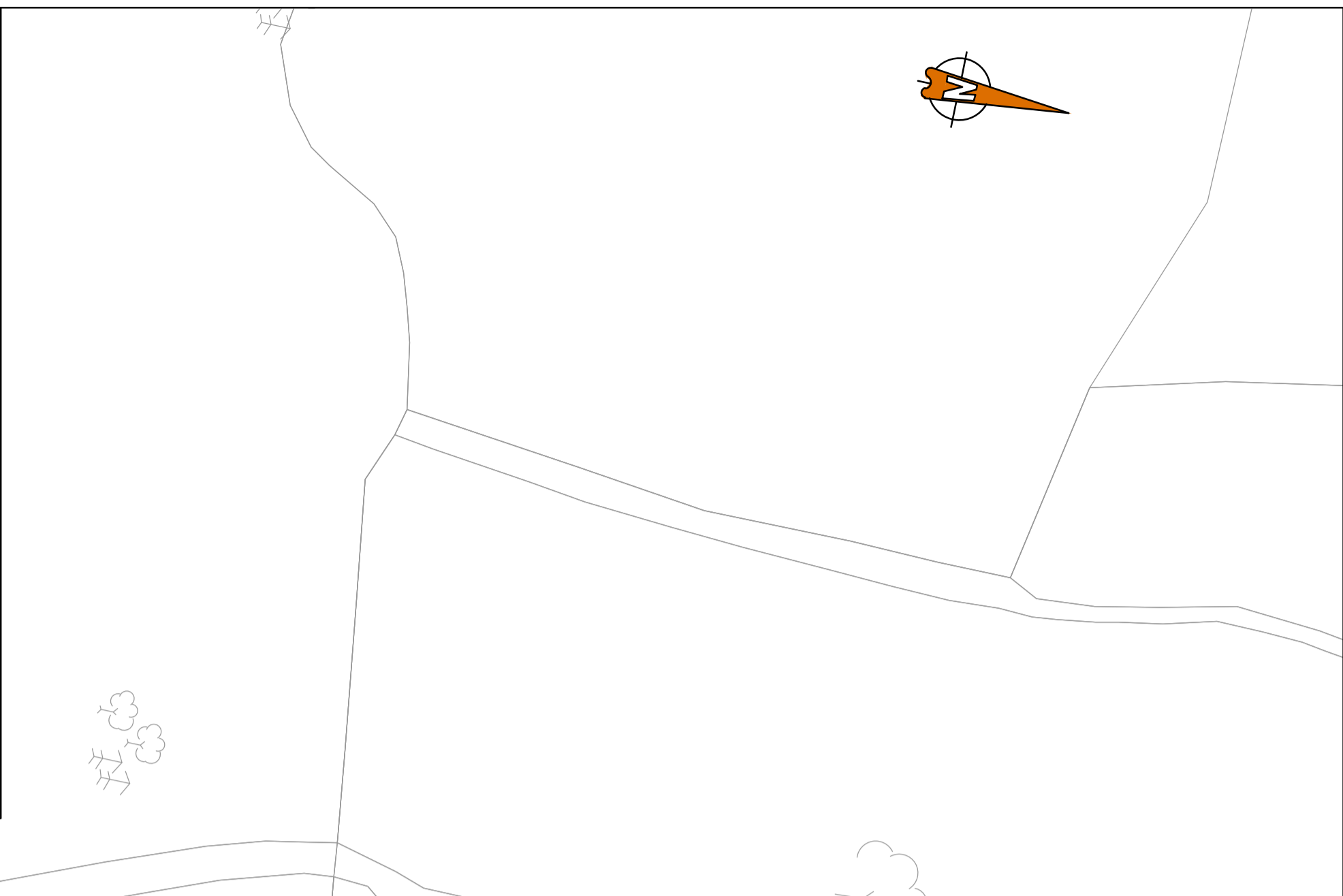

ORDNANCE SURVEY OF IRELAND LICENCE NO. CYAL50213875 © GOVERNMENT OF IRELAND

- FOR SETTING OUT REFER TO ARCHITECT'S DRAWINGS.
- THIS DRAWING TO BE READ IN CONJUNCTION WITH ALL OTHER ARCHITECTURAL AND ENGINEERING DRAWINGS AND ALL OTHER RELEVANT DRAWINGS AND SPECIFICATIONS.
- DO NOT SCALE THIS DRAWING. USE FIGURED DIMENSIONS ONLY.
- NO PART OF THIS DOCUMENT MAY BE REPRODUCED OR TRANSMITTED IN ANY FORM OR STORED IN ANY RETRIEVAL SYSTEM OF ANY NATURE WITHOUT THE WRITTEN PERMISSION OF O'CONNOR SUTTON CRONIN AS COPYRIGHT HOLDER EXCEPT AS AGREED FOR USE ON THE PROJECT FOR WHICH THE DOCUMENT WAS ORIGINALLY ISSUED.

Rev No.	Date	Revision Note	Drn by	Chkd by	Rev No.	Date	Revision Note	Drn by	Chkd by
C01	21/05/21	SUITABLE FOR INFORMATION	LS	CW					



Head Office,
9 Prussia Street,
Dublin 7.
D07 KT57

TEL +353 (0)1 8682000

e: contactus@ocsc.ie
w: www.ocsc.ie

Dublin | London | Belfast | Galway | Cork | Birmingham



Client:	Cork City Council							
Project:	Cork City Infrastructure Development Glannire To City Cycle Route (Phase 1)							
Title:	Part 8 Drawings Site Layout Plan Sheet 4 of 5							
Code	Originator	Zone	Level	Type	Role	Number	Status	Revision
C1001	OCSC	ZZ	XX	DR	C	0007	A3	C01
Date:	04/10/21 Scale: 1:500 @ A1 Drn by: LS Chkd by: CW Aprvd by: BO'R							

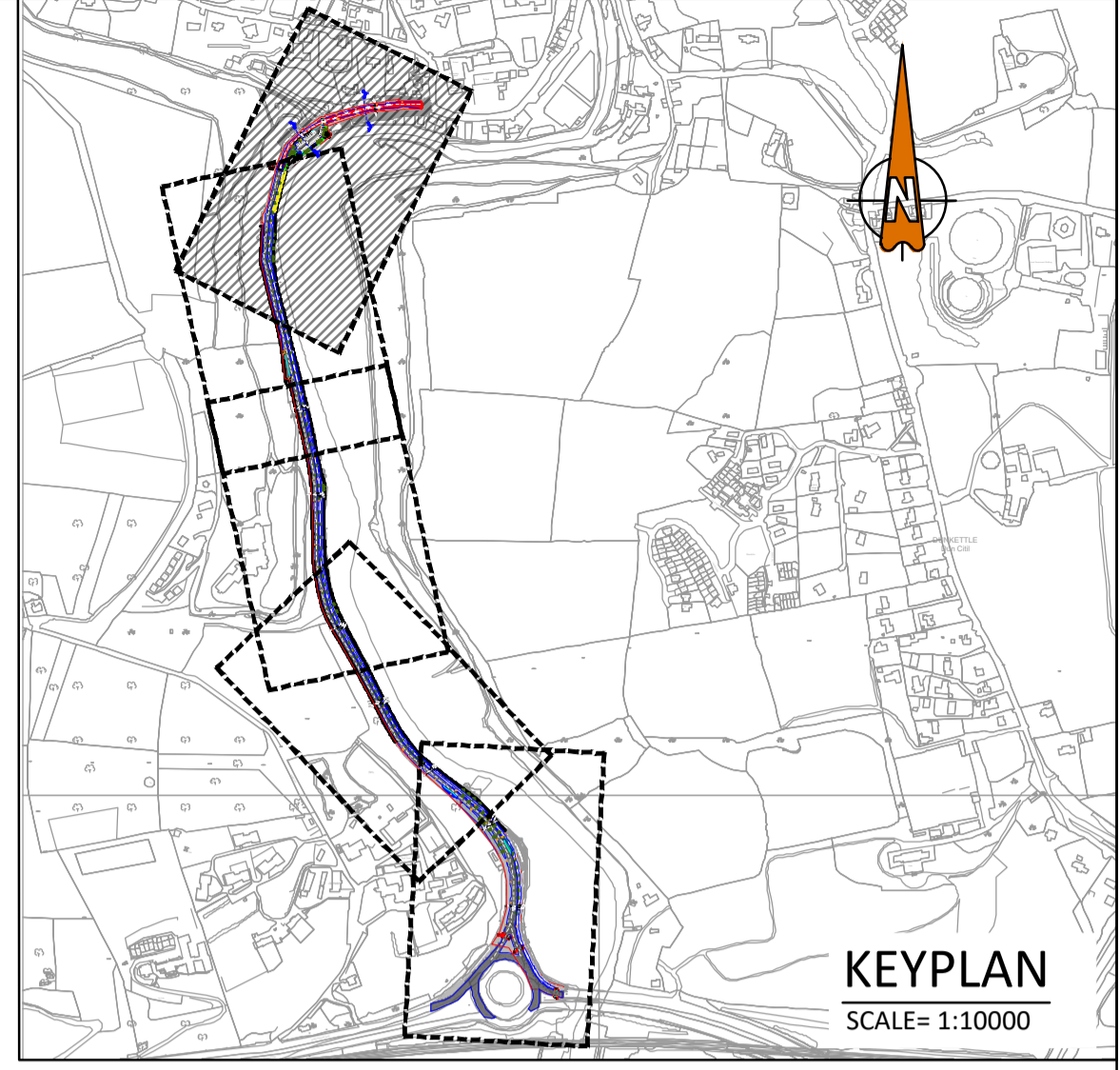
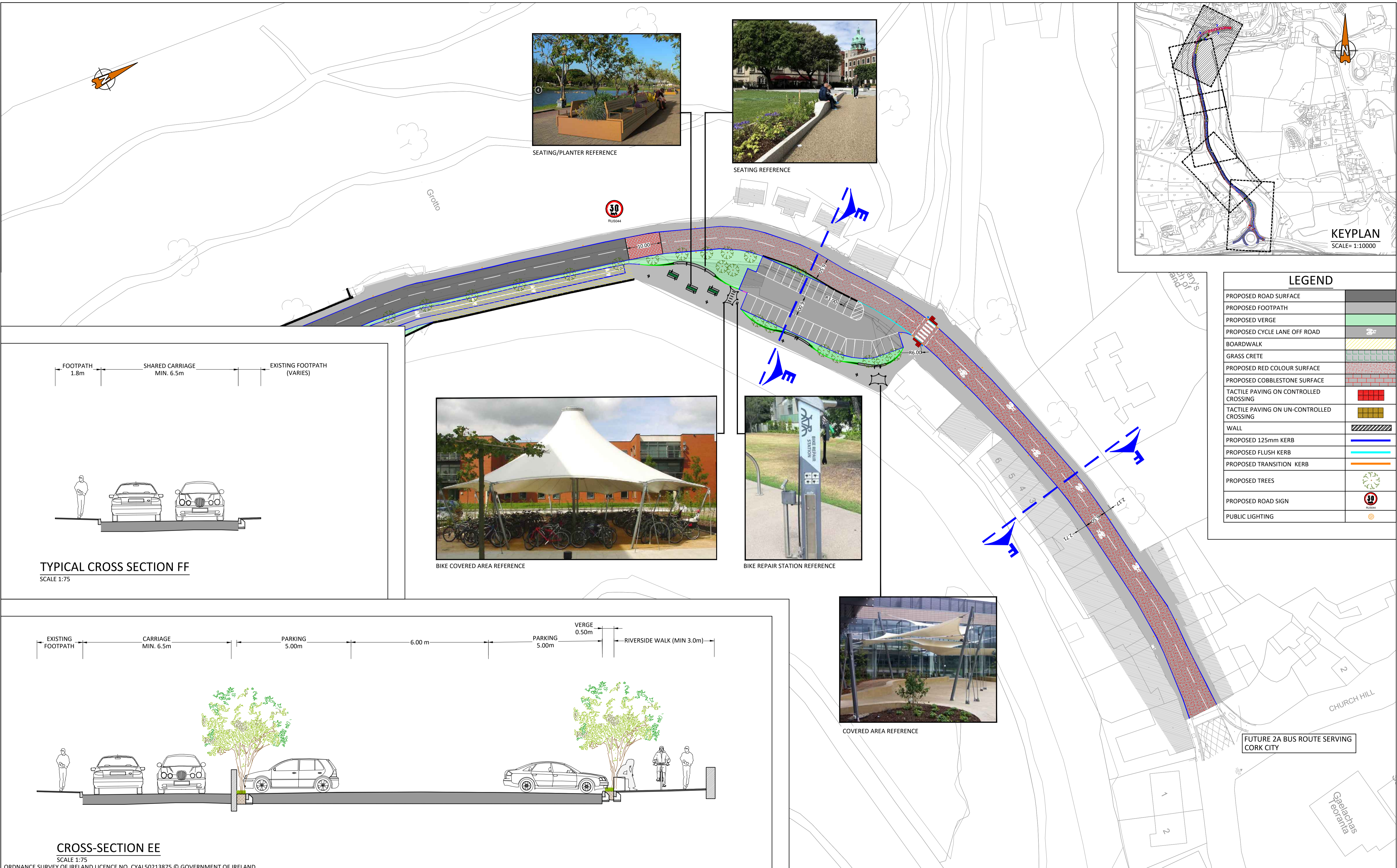

LEGEND	
PROPOSED ROAD SURFACE	[Symbol]
PROPOSED FOOTPATH	[Symbol]
PROPOSED VERGE	[Symbol]
PROPOSED CYCLE LANE OFF ROAD	[Symbol]
BOARDWALK	[Symbol]
GRASS CRETE	[Symbol]
PROPOSED RED COLOUR SURFACE	[Symbol]
PROPOSED COBBLESTONE SURFACE	[Symbol]
TACTILE PAVING ON CONTROLLED CROSSING	[Symbol]
TACTILE PAVING ON UN-CONTROLLED CROSSING	[Symbol]
WALL	[Symbol]
PROPOSED 125mm KERB	[Symbol]
PROPOSED FLUSH KERB	[Symbol]
PROPOSED TRANSITION KERB	[Symbol]
PROPOSED TREES	[Symbol]
PROPOSED ROAD SIGN	[Symbol]
PUBLIC LIGHTING	[Symbol]

FOOTPATH 1.8m | SHARED CARRIAGE MIN. 6.5m | EXISTING FOOTPATH (VARIES)

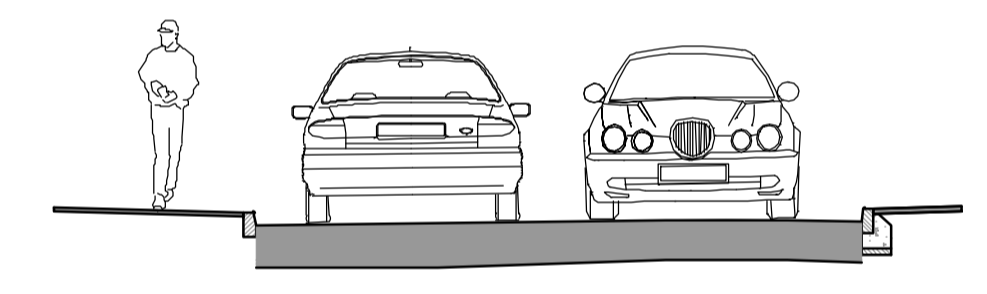

TYPICAL CROSS SECTION FF
SCALE 1:75



BIKE COVERED AREA REFERENCE



BIKE REPAIR STATION REFERENCE

EXISTING FOOTPATH | CARRIAGE MIN. 6.5m | PARKING 5.00m | 6.00m | PARKING 5.00m | VERGE 0.50m | RIVERSIDE WALK (MIN 3.0m)

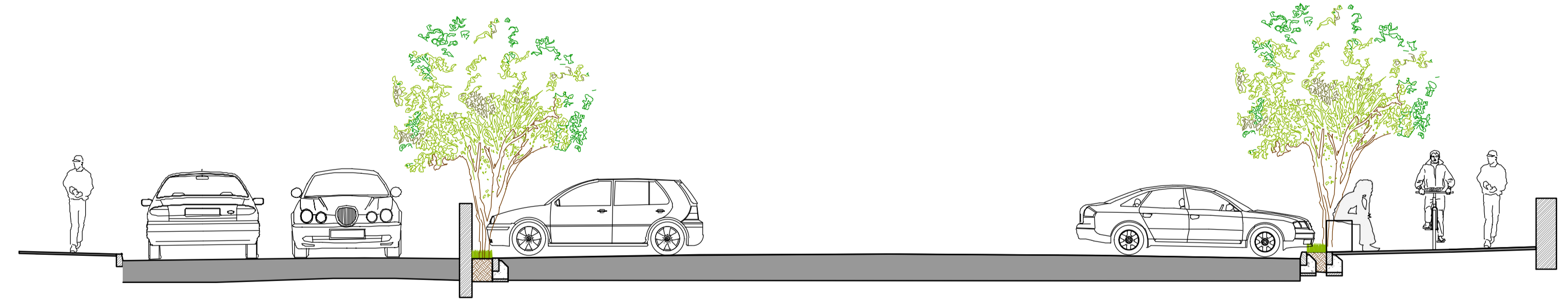

CROSS-SECTION EE
SCALE 1:75

ORDNANCE SURVEY OF IRELAND LICENCE NO. CYAL50213875 © GOVERNMENT OF IRELAND

- FOR SETTING OUT REFER TO ARCHITECT'S DRAWINGS.
- THIS DRAWING TO BE READ IN CONJUNCTION WITH ALL OTHER ARCHITECTURAL AND ENGINEERING DRAWINGS AND ALL OTHER RELEVANT DRAWINGS AND SPECIFICATIONS.
- DO NOT SCALE THIS DRAWING. USE FIGURED DIMENSIONS ONLY.
- NO PART OF THIS DOCUMENT MAY BE REPRODUCED OR TRANSMITTED IN ANY FORM OR STORED IN ANY RETRIEVAL SYSTEM OF ANY NATURE WITHOUT THE WRITTEN PERMISSION OF O'CONNOR SUTTON CRONIN AS COPYRIGHT HOLDER EXCEPT AS AGREED FOR USE ON THE PROJECT FOR WHICH THE DOCUMENT WAS ORIGINALLY ISSUED.

Rev No.	Date	Revision Note	Drn by	Chkd by	Rev No.	Date	Revision Note	Drn by	Chkd by
C01	21/05/21	SUITABLE FOR INFORMATION	LS	CW					



Head Office,
9 Prussia Street,
Dublin 7.
D07 KT57

TEL +353 (0)1 8682000

e: contactus@ocsc.ie
w: www.ocsc.ie

Dublin | London | Belfast | Galway | Cork | Birmingham



Client: Cork City Council
Project: Cork City Infrastructure Development
Glanmire To City Cycle Route (Phase 1)
Title: Part 8 Drawings
Site Layout Plan
Sheet 5 of 5

Code | Originator | Zone | Level | Type | Role | Number | Status | Revision
C1001 | OCSC | ZZ | XX | DR | C | 0008 | A3 | C01

Date: 04/10/21 Scale: 1:500 @ A1 Drn by: LS Chkd by: CW Aprvd by: BO'R



EXISTING ROAD/CAR PARKING AREA



PROPOSED ROAD AND SEATING AREA

ORDNANCE SURVEY OF IRELAND LICENCE NO. CYAL50213875 © GOVERNMENT OF IRELAND

- FOR SETTING OUT REFER TO ARCHITECT'S DRAWINGS.
- THIS DRAWING TO BE READ IN CONJUNCTION WITH ALL OTHER ARCHITECTURAL AND ENGINEERING DRAWINGS AND ALL OTHER RELEVANT DRAWINGS AND SPECIFICATIONS.
- DO NOT SCALE THIS DRAWING. USE FIGURED DIMENSIONS ONLY.
- NO PART OF THIS DOCUMENT MAY BE REPRODUCED OR TRANSMITTED IN ANY FORM OR STORED IN ANY RETRIEVAL SYSTEM OF ANY NATURE WITHOUT THE WRITTEN PERMISSION OF O'CONNOR SUTTON CRONIN AS COPYRIGHT HOLDER EXCEPT AS AGREED FOR USE ON THE PROJECT FOR WHICH THE DOCUMENT WAS ORIGINALLY ISSUED.

Rev No.	Date	Revision Note	Drn by	Chkd by
C01	21/05/21	SUITABLE FOR INFORMATION	LS	CW

Rev No.	Date	Revision Note	Drn by	Chkd by

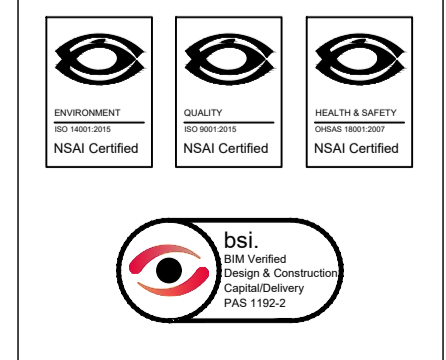

Head Office,
9 Prussia Street,
Dublin 7.
D07 KT57

TEL +353 (0)1 8682000

e: contactus@ocsc.ie
w: www.ocsc.ie

Dublin | London | Belfast | Galway | Cork | Birmingham



Client:	Cork City Council							
Project:	Cork City Infrastructure Development Glanmire To City Cycle Route (Phase 1)							
Title:	Part 8 Drawings Photomontages Sheet 01 of 02							
Code	Originator	Zone	Level	Type	Role	Number	Status	Revision
C1001	OCSC	ZZ	XX	DR	C	0009	A3	C01
Date: 04/10/21 Scale: N.T.S @ A1 Drn by: LS Chkd by: CW Aprvd by: BO'R								



EXISTING GLANMIRE ROAD VIEW 01



EXISTING GLANMIRE ROAD VIEW 02



PROPOSED GLANMIRE ROAD VIEW 01



PROPOSED GLANMIRE ROAD VIEW 02

ORDNANCE SURVEY OF IRELAND LICENCE NO. CYAL50213875 © GOVERNMENT OF IRELAND

- FOR SETTING OUT REFER TO ARCHITECT'S DRAWINGS.
- THIS DRAWING TO BE READ IN CONJUNCTION WITH ALL OTHER ARCHITECTURAL AND ENGINEERING DRAWINGS AND ALL OTHER RELEVANT DRAWINGS AND SPECIFICATIONS.
- DO NOT SCALE THIS DRAWING. USE FIGURED DIMENSIONS ONLY.
- NO PART OF THIS DOCUMENT MAY BE REPRODUCED OR TRANSMITTED IN ANY FORM OR STORED IN ANY RETRIEVAL SYSTEM OF ANY NATURE WITHOUT THE WRITTEN PERMISSION OF O'CONNOR SUTTON CRONIN AS COPYRIGHT HOLDER EXCEPT AS AGREED FOR USE ON THE PROJECT FOR WHICH THE DOCUMENT WAS ORIGINALLY ISSUED.

Rev No.	Date	Revision Note	Drn by	Chkd by
C01	21/05/21	SUITABLE FOR INFORMATION	LS	CW

Rev No.	Date	Revision Note	Drn by	Chkd by



Head Office,
9 Prussia Street,
Dublin 7.
D07 KT57

TEL +353 (0)1 8682000
e: contactus@ocsc.ie
w: www.ocsc.ie



Dublin | London | Belfast | Galway | Cork | Birmingham

Client: Cork City Council
Project: Cork City Infrastructure Development
Glanmire To City Cycle Route (Phase 1)
Title: Part 8 Drawings
Photomontages
Sheet 02 of 02

Code	Originator	Zone	Level	Type	Role	Number	Status	Revision
C1001	OCSC	ZZ	XX	DR	C	0010	A3	C01

Date: 04/10/21 Scale: N.T.S @ A1 Drn by: LS Chkd by: CW Aprvd by: BO'R