

LEGEND:

PROPOSED NEW KERBLINE	—
EXISTING KERBLINE/ EDGE OF ROAD	- - -
PROPOSED 50mm KERB BETWEEN CYCLE TRACK AND FOOTPATH	—
BACK OF PROPOSED FOOTPATH	—
EXISTING FOOTPATH UPGRADE / PROPOSED NEW FOOTPATH	—
PROPOSED RAISED ENTRY/ RAMP	—
PROPOSED ON ROAD CYCLE LANE	—
PROPOSED OFF ROAD CYCLE TRACK	—
PROPOSED BUS SHELTER / WALL	—
PROPOSED LANDSCAPED AREA	—
PROPOSED LANDTAKE AREA	—
EXISTING FOOTPATH TO BE RETAINED	—

TREE LEGEND:

EXISTING TREE TO BE RETAINED	
EXISTING TREE TO BE REMOVED	

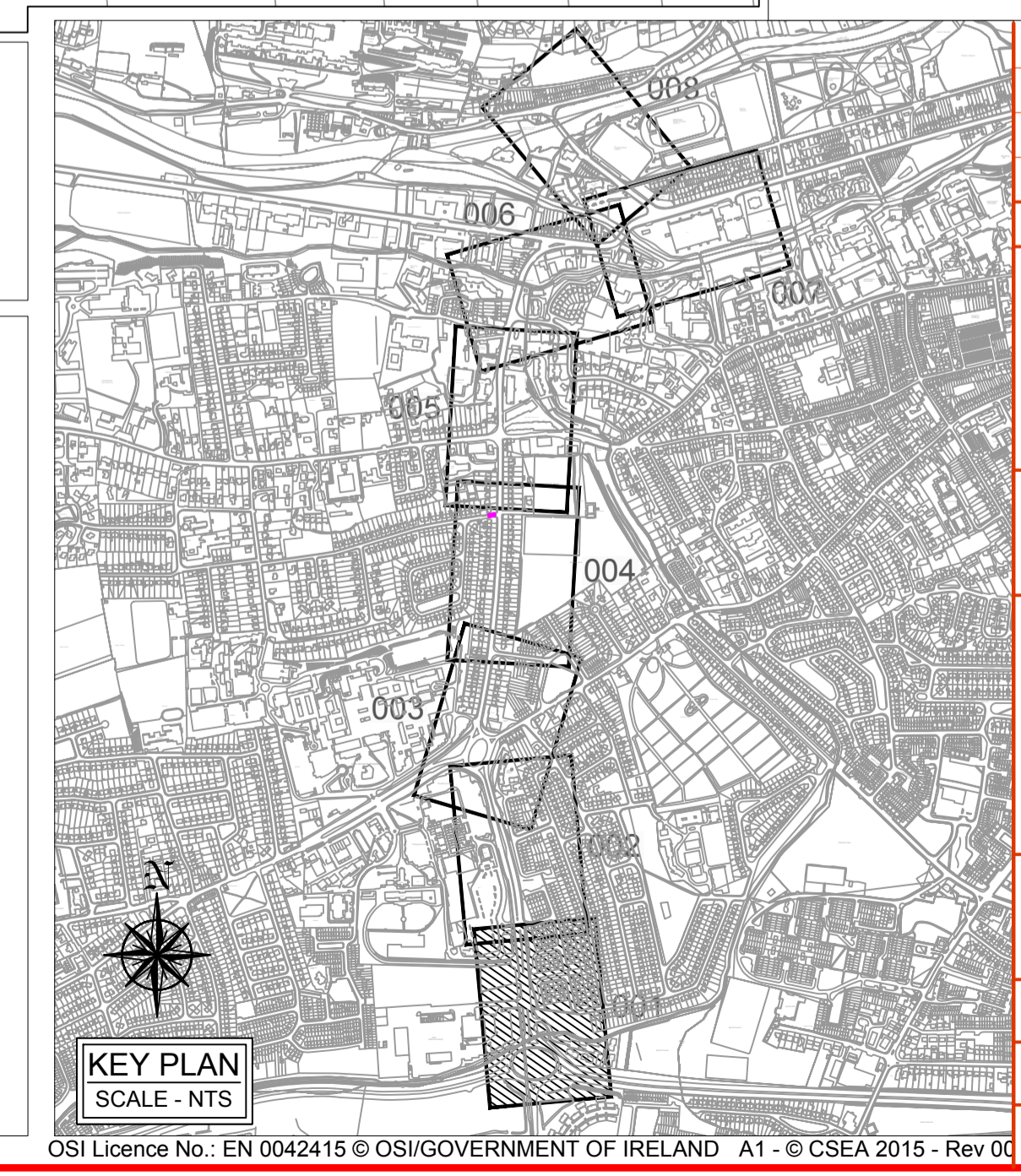
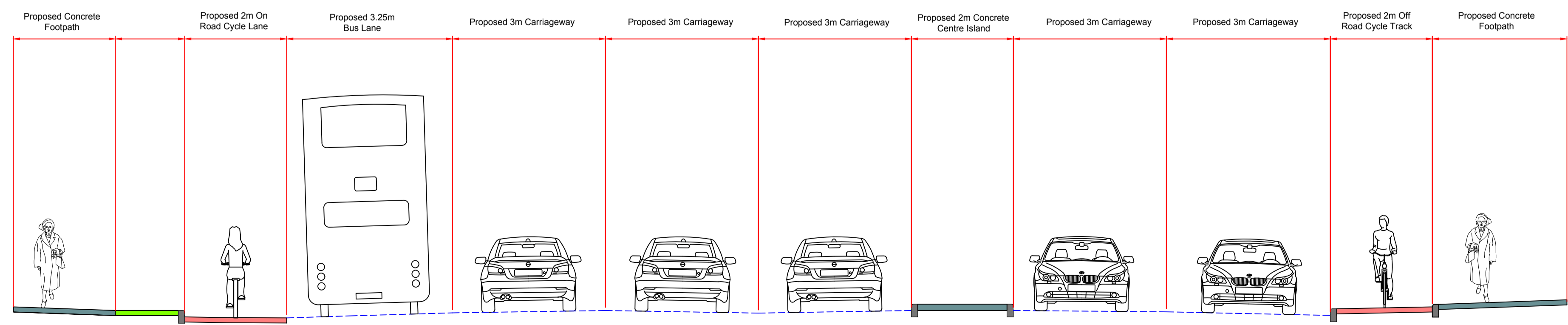

P1	SL	25/07/16	ISSUED FOR INFORMATION
----	----	----------	------------------------

CORK CITY COUNCIL
COMHAIRLE CATHRACH CHORCAÍ
Roads Design Division
Roads & Transportation Directorate
Anglesea Street
Cork
Telephone: (031) 492 4658

INCLUDES ORDNANCE SURVEY IRELAND DATA REPRODUCED UNDER OSI LICENCE NUMBER 2014/05/CCMA/CorkCityCouncil. UNAUTHORISED REPRODUCTION INFRINGES ORDNANCE SURVEY IRELAND AND GOVERNMENT OF IRELAND COPYRIGHT. © ORDNANCE SURVEY IRELAND.

Wilton Road, Sarsfield Road, Victoria Cross & Western Road Project

Part 8 Planning Proposal
Sheet 1 of 8

Scale: 1:500	File Name: W:\Wilton Road\Pre Contract\Part 8 Planning
Drawn: S.L.	Date: May 2016
Checked: JG	Approved: JS
Contract: WR-P8-01	Rev: P1

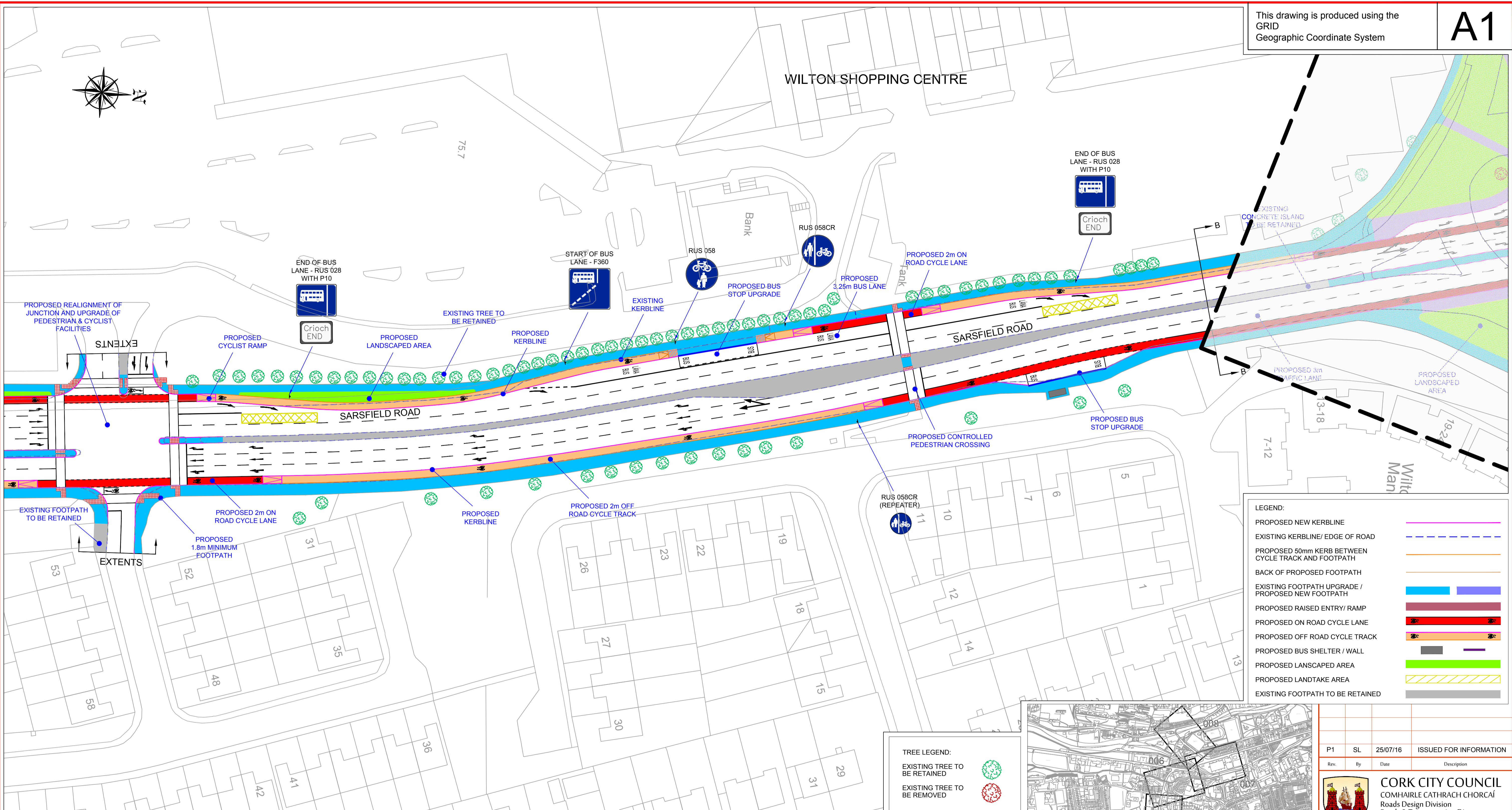

LEGEND:

PROPOSED NEW KERBLINE	
EXISTING KERBLINE/ EDGE OF ROAD	
PROPOSED 50mm KERB BETWEEN CYCLE TRACK AND FOOTPATH	
BACK OF PROPOSED FOOTPATH	
EXISTING FOOTPATH UPGRADE / PROPOSED NEW FOOTPATH	
PROPOSED RAISED ENTRY/ RAMP	
PROPOSED ON ROAD CYCLE LANE	
PROPOSED OFF ROAD CYCLE TRACK	
PROPOSED BUS SHELTER / WALL	
PROPOSED LANDSCAPED AREA	
PROPOSED LANDTAKE AREA	
EXISTING FOOTPATH TO BE RETAINED	

TREE LEGEND:

EXISTING TREE TO BE RETAINED	
EXISTING TREE TO BE REMOVED	

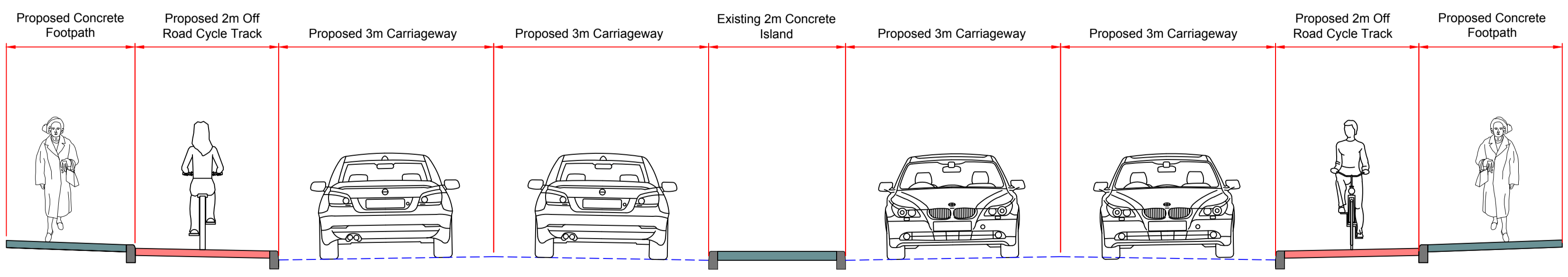
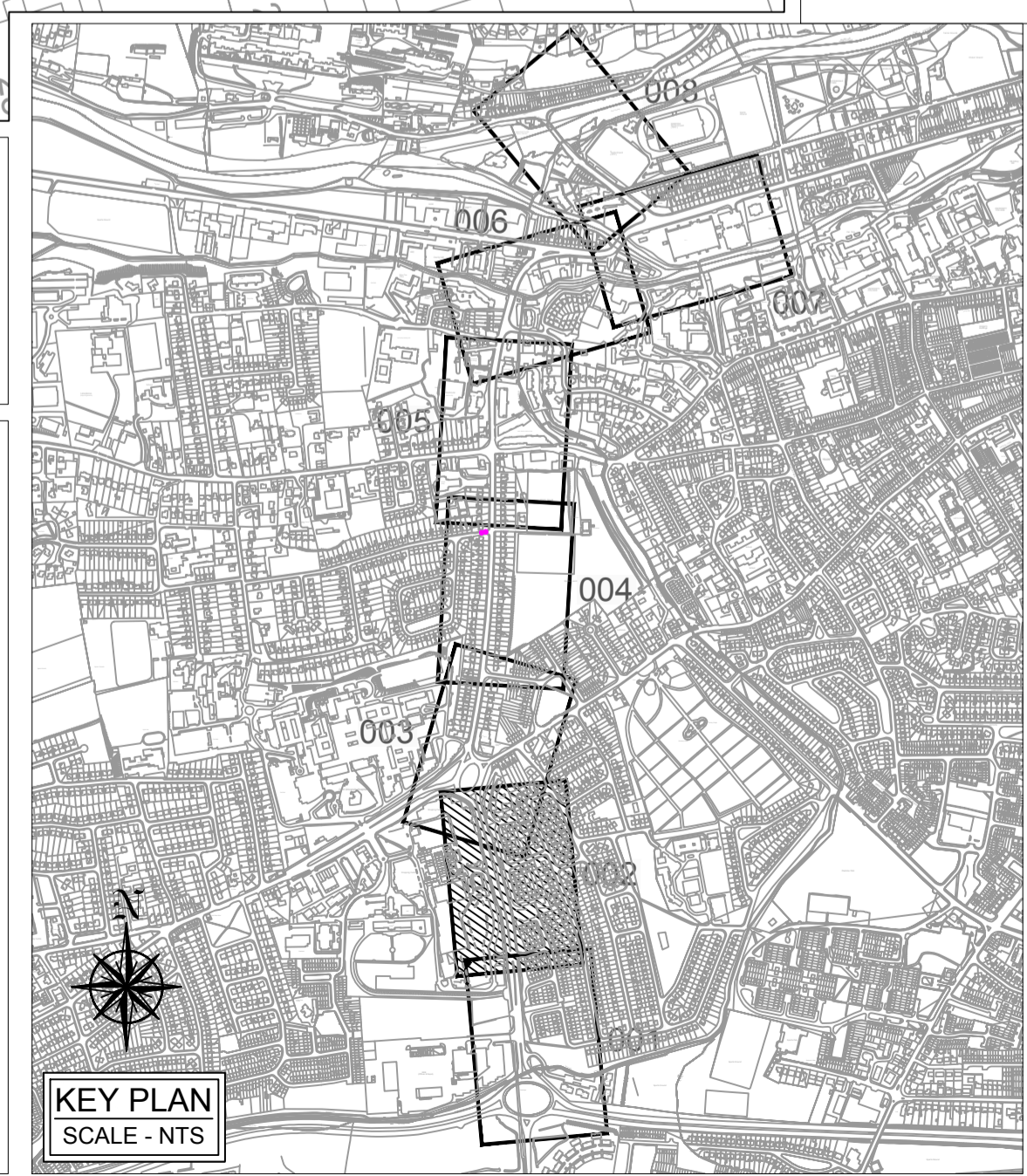

PROPOSED SECTION B-B
SCALE - 1:50

P1	SL	25/07/16	ISSUED FOR INFORMATION
----	----	----------	------------------------

CORK CITY COUNCIL
COMHAIRLE CATHRACH CHORCAÍ
Roads Design Division
Roads & Transportation Directorate
Anglesea Street
Cork
Telephone: (021) 492 4658

INCLUDES ORDNANCE SURVEY IRELAND DATA REPRODUCED UNDER OSI LICENCE NUMBER 201405/CCMA/CorkCityCouncil. UNAUTHORISED REPRODUCTION INFRINGES ORDNANCE SURVEY IRELAND AND GOVERNMENT OF IRELAND COPYRIGHT. © ORDNANCE SURVEY IRELAND.

Contract
Wilton Road, Sarsfield Road, Victoria Cross & Western Road Project

Title
Part 8 Planning Proposal
Sheet 2 of 8

Scale: 1:500	File Name: W:\Wilton Road\Pre Contract\Part 8 Planning
Drawn: S.L.	Date: May 2016
Checked: JG	Approved: JS
Contract: WR-P8-02	Rev: P1

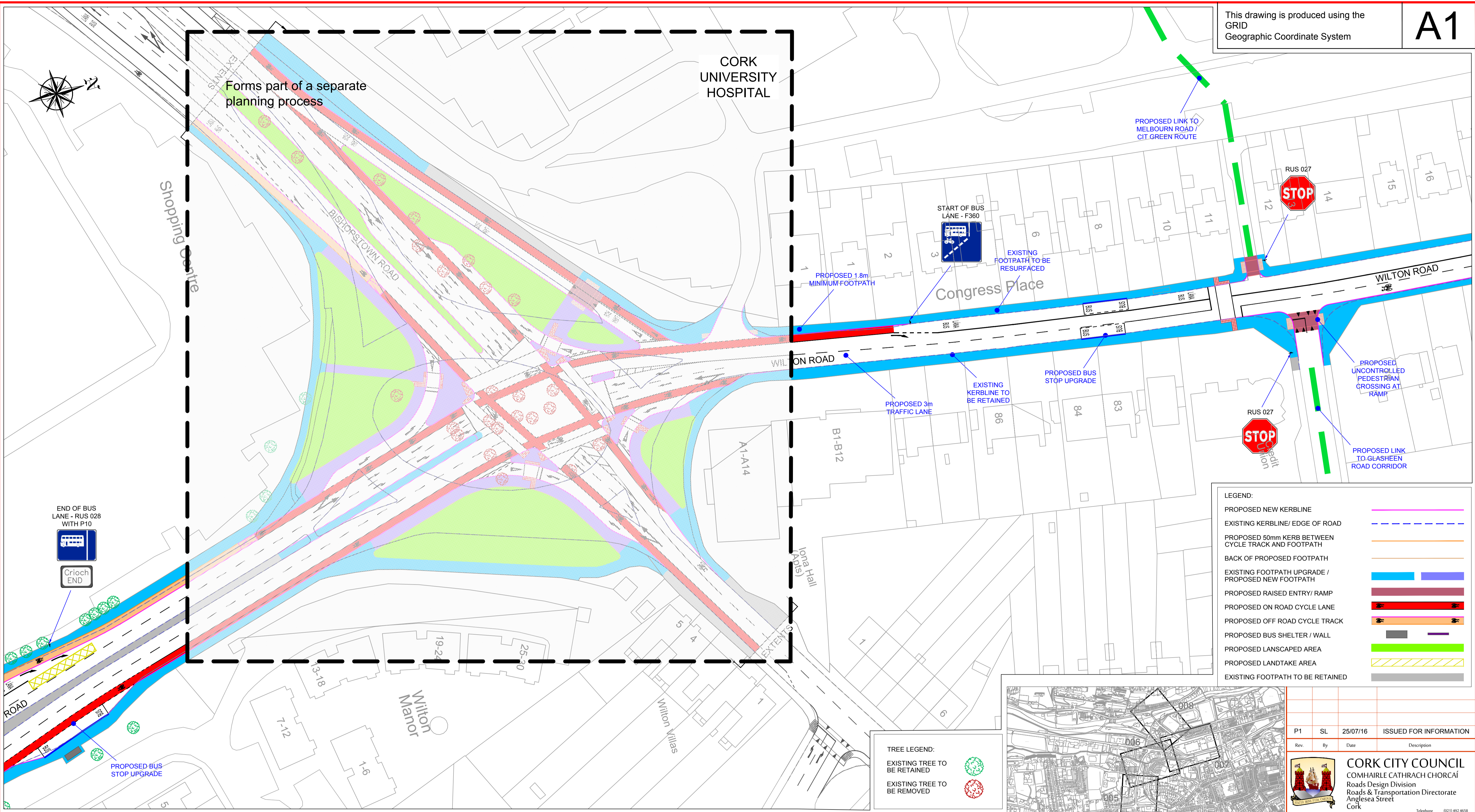

LEGEND:

PROPOSED NEW KERBLINE	
EXISTING KERBLINE/ EDGE OF ROAD	
PROPOSED 50mm KERB BETWEEN CYCLE TRACK AND FOOTPATH	
BACK OF PROPOSED FOOTPATH	
EXISTING FOOTPATH UPGRADE / PROPOSED NEW FOOTPATH	
PROPOSED RAISED ENTRY/ RAMP	
PROPOSED ON ROAD CYCLE LANE	
PROPOSED OFF ROAD CYCLE TRACK	
PROPOSED BUS SHELTER / WALL	
PROPOSED LANDSCAPED AREA	
PROPOSED LANDTAKE AREA	
EXISTING FOOTPATH TO BE RETAINED	

TREE LEGEND:

EXISTING TREE TO BE RETAINED	
EXISTING TREE TO BE REMOVED	

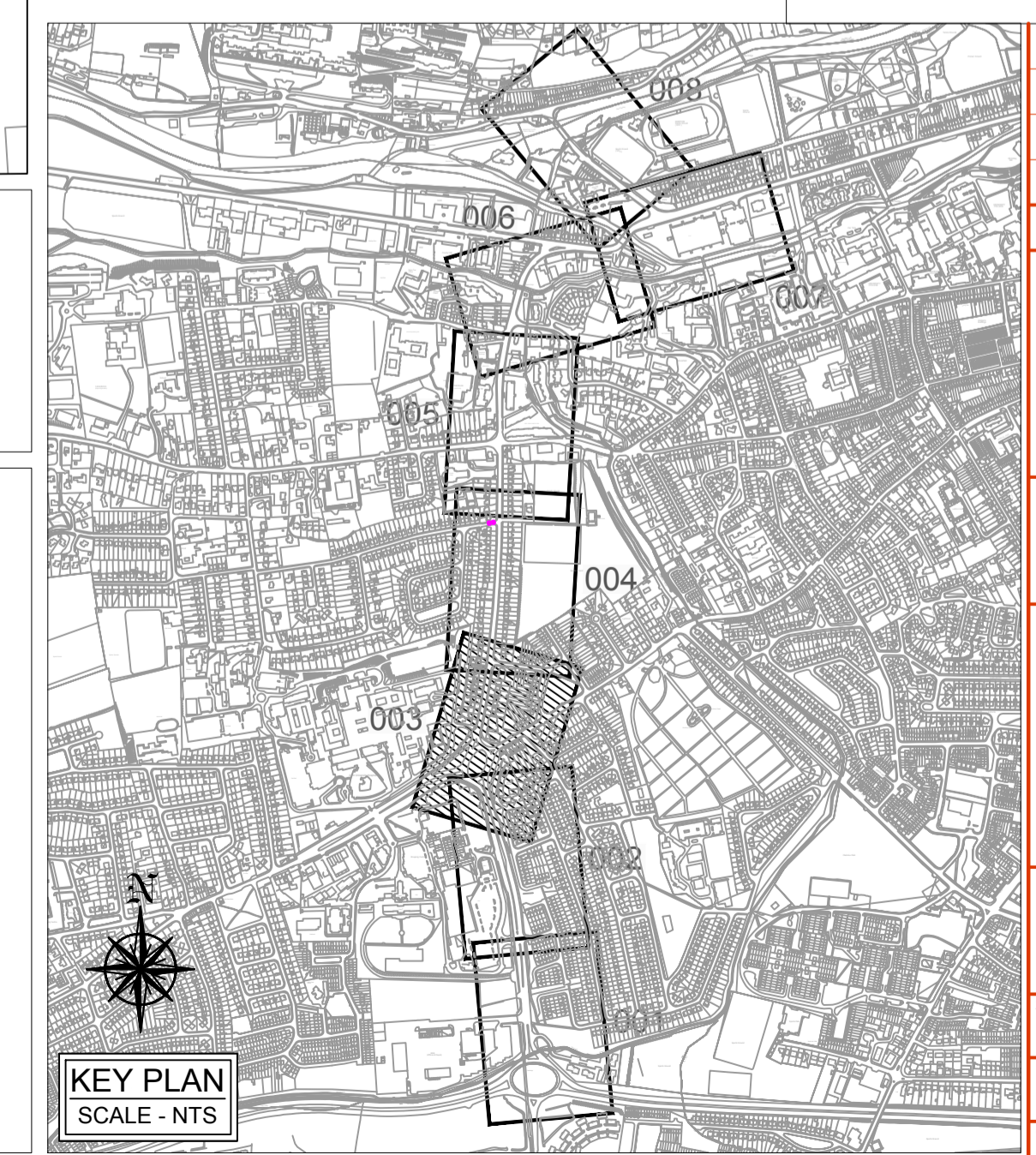

P1	SL	25/07/16	ISSUED FOR INFORMATION
----	----	----------	------------------------

CORK CITY COUNCIL
 COMHAIRLE CATHRACH CHORCAÍ
 Roads Design Division
 Roads & Transportation Directorate
 Anglesea Street
 Cork
 Telephone: (031) 492 4658

INCLUDES ORDNANCE SURVEY IRELAND DATA REPRODUCED UNDER OSI LICENCE NUMBER 2014/05/CCMA/CorkCityCouncil. UNAUTHORISED REPRODUCTION INFRINGES ORDNANCE SURVEY IRELAND AND GOVERNMENT OF IRELAND COPYRIGHT.
 © ORDNANCE SURVEY IRELAND.

Contract
Wilton Road, Sarsfield Road, Victoria Cross & Western Road Project

Title
Part 8 Planning Proposal
 Sheet 3 of 8

Scale: 1:500	File Name: W:\Wilton Road\Pre Contract\Part 8 Planning
Drawn: S.L.	Date: May 2016
Checked: JG	Approved: JS
WR-P8-03	PI

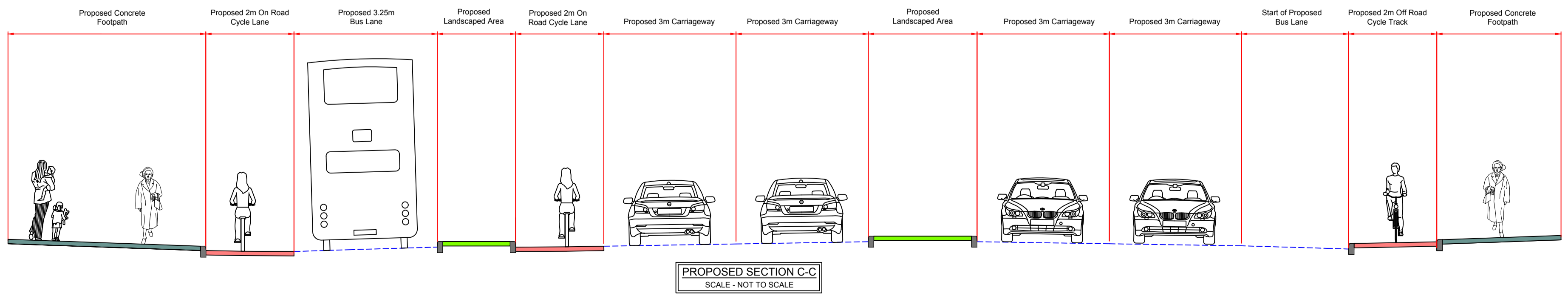

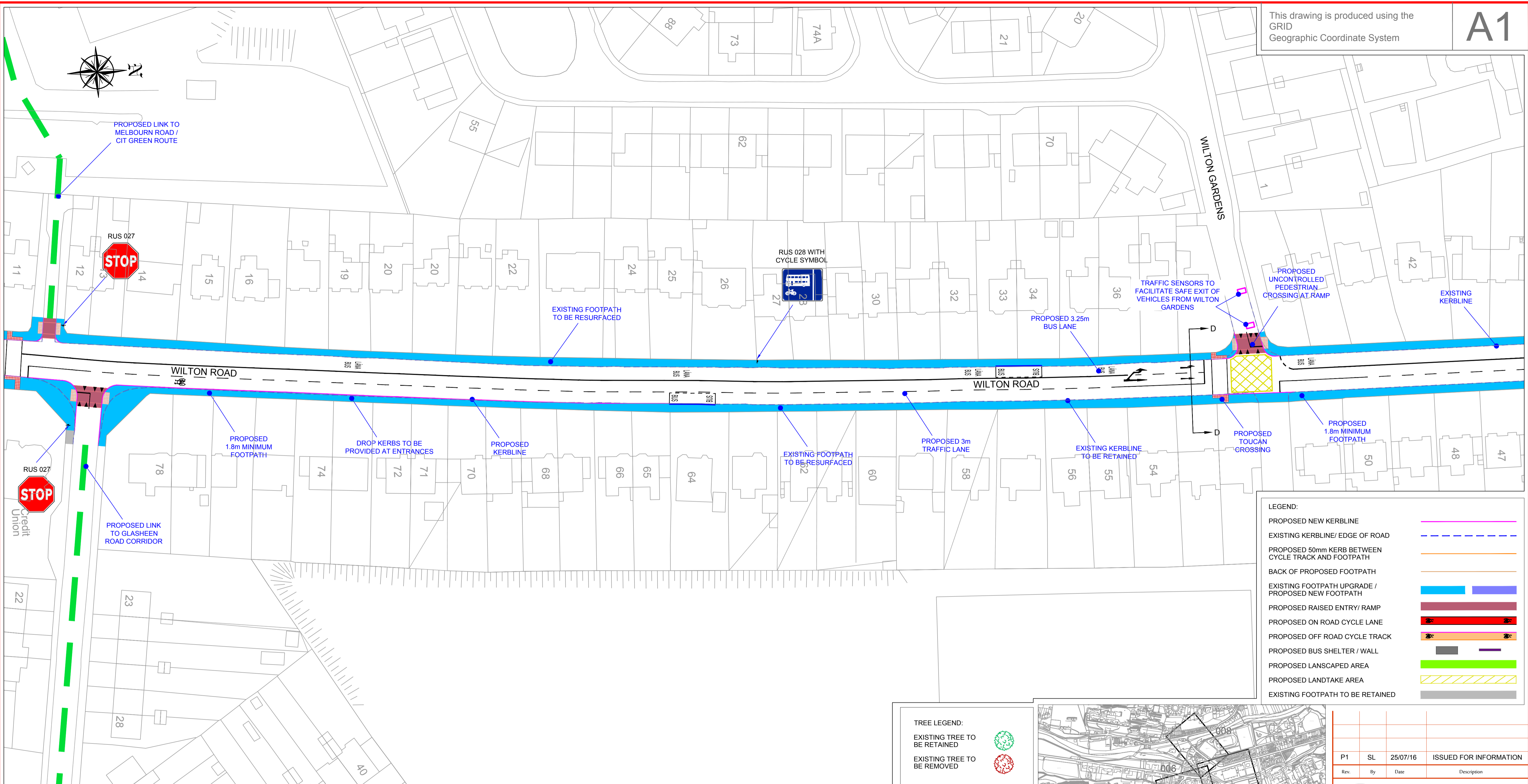

LEGEND:

PROPOSED NEW KERBLINE	—
EXISTING KERBLINE/ EDGE OF ROAD	- - -
PROPOSED 50mm KERB BETWEEN CYCLE TRACK AND FOOTPATH	—
BACK OF PROPOSED FOOTPATH	—
EXISTING FOOTPATH UPGRADE / PROPOSED NEW FOOTPATH	■
PROPOSED RAISED ENTRY/ RAMP	■
PROPOSED ON ROAD CYCLE LANE	■
PROPOSED OFF ROAD CYCLE TRACK	■
PROPOSED BUS SHELTER / WALL	■
PROPOSED LANDTAKE AREA	■
EXISTING FOOTPATH TO BE RETAINED	■

TREE LEGEND:

EXISTING TREE TO BE RETAINED	●
EXISTING TREE TO BE REMOVED	●

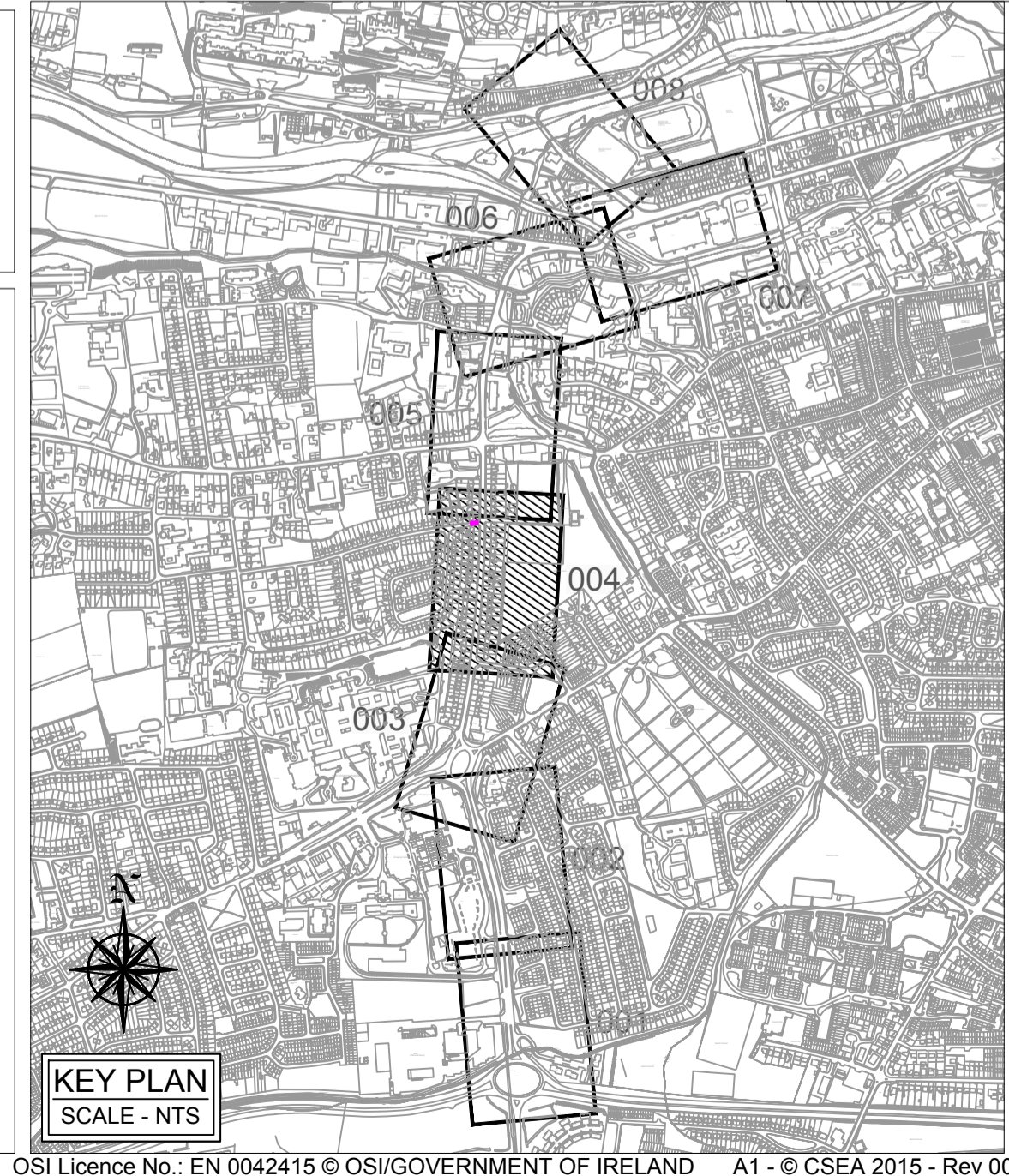
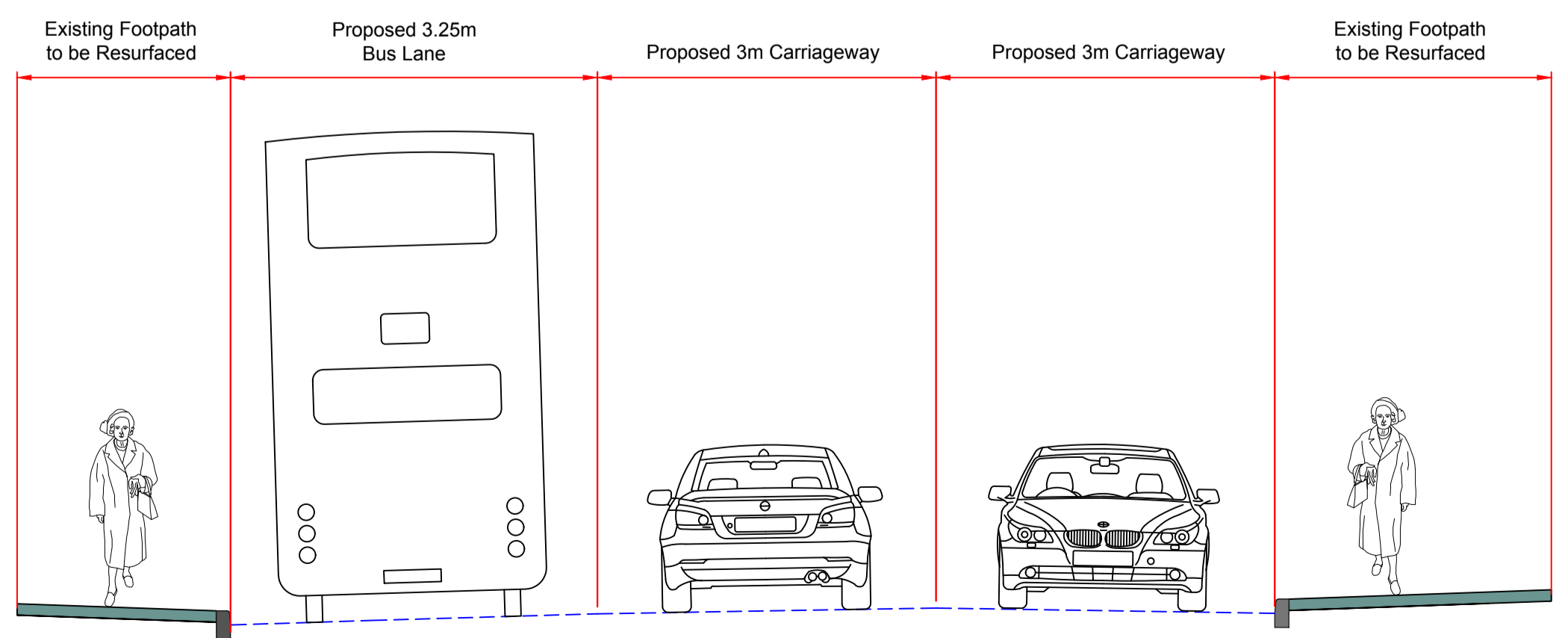

P1	SL	25/07/16	ISSUED FOR INFORMATION
Rev.	By	Date	Description
CORK CITY COUNCIL COMHAIRLE CATHRACH CHORCAÍ Roads Design Division Roads & Transportation Directorate Anglesea Street Cork Telephone: (021) 492 4658			
INCLUDES ORDNANCE SURVEY IRELAND DATA REPRODUCED UNDER OSI LICENCE NUMBER 2014/05/CCMA/CorkCityCouncil. UNAUTHORISED REPRODUCTION INFRINGES ORDNANCE SURVEY IRELAND AND GOVERNMENT OF IRELAND COPYRIGHT. © ORDNANCE SURVEY IRELAND.			
Contract Wilton Road, Sarsfield Road, Victoria Cross & Western Road Project			
Title Part 8 Planning Proposal Sheet 4 of 8			
Scale:	1:500	File Name:	W:\Wilton Road\Pre Contract\Part 8 Planning
Drawn:	S.L.	Date:	May 2016
Checked:	JG	Approved:	JS
WR-P8-04			PI

OSI Licence No.: EN 0042415 © OSI/GOVERNMENT OF IRELAND A1 - © CSEA 2015 - Rev 00

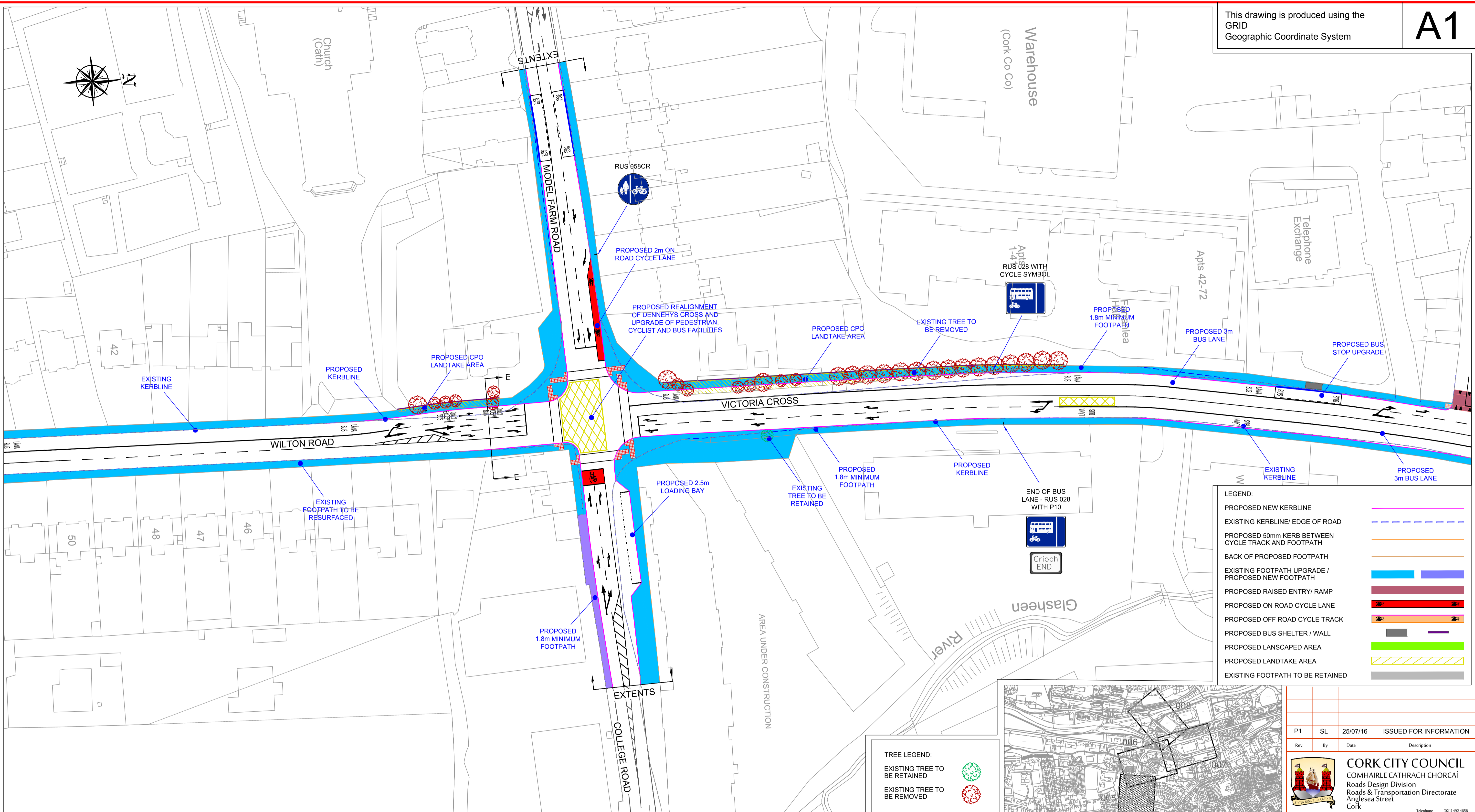

LEGEND:

PROPOSED NEW KERBLINE	
EXISTING KERBLINE/ EDGE OF ROAD	
PROPOSED 50mm KERB BETWEEN CYCLE TRACK AND FOOTPATH	
BACK OF PROPOSED FOOTPATH	
EXISTING FOOTPATH UPGRADE / PROPOSED NEW FOOTPATH	
PROPOSED RAISED ENTRY/ RAMP	
PROPOSED ON ROAD CYCLE LANE	
PROPOSED OFF ROAD CYCLE TRACK	
PROPOSED BUS SHELTER / WALL	
PROPOSED LANDSCAPED AREA	
PROPOSED LANDTAKE AREA	
EXISTING FOOTPATH TO BE RETAINED	

TREE LEGEND:

EXISTING TREE TO BE RETAINED	
EXISTING TREE TO BE REMOVED	

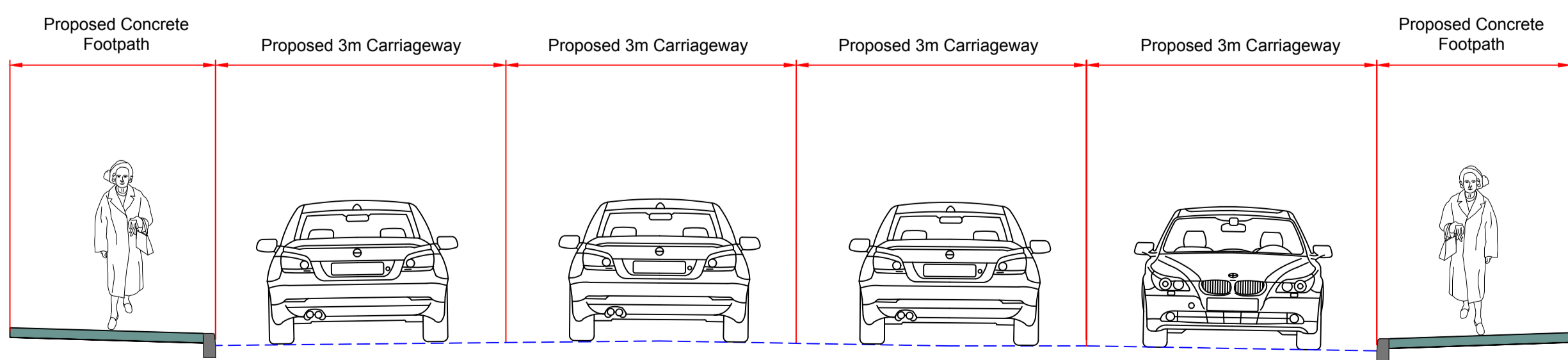

PROPOSED SECTION E-E
SCALE - 1:50

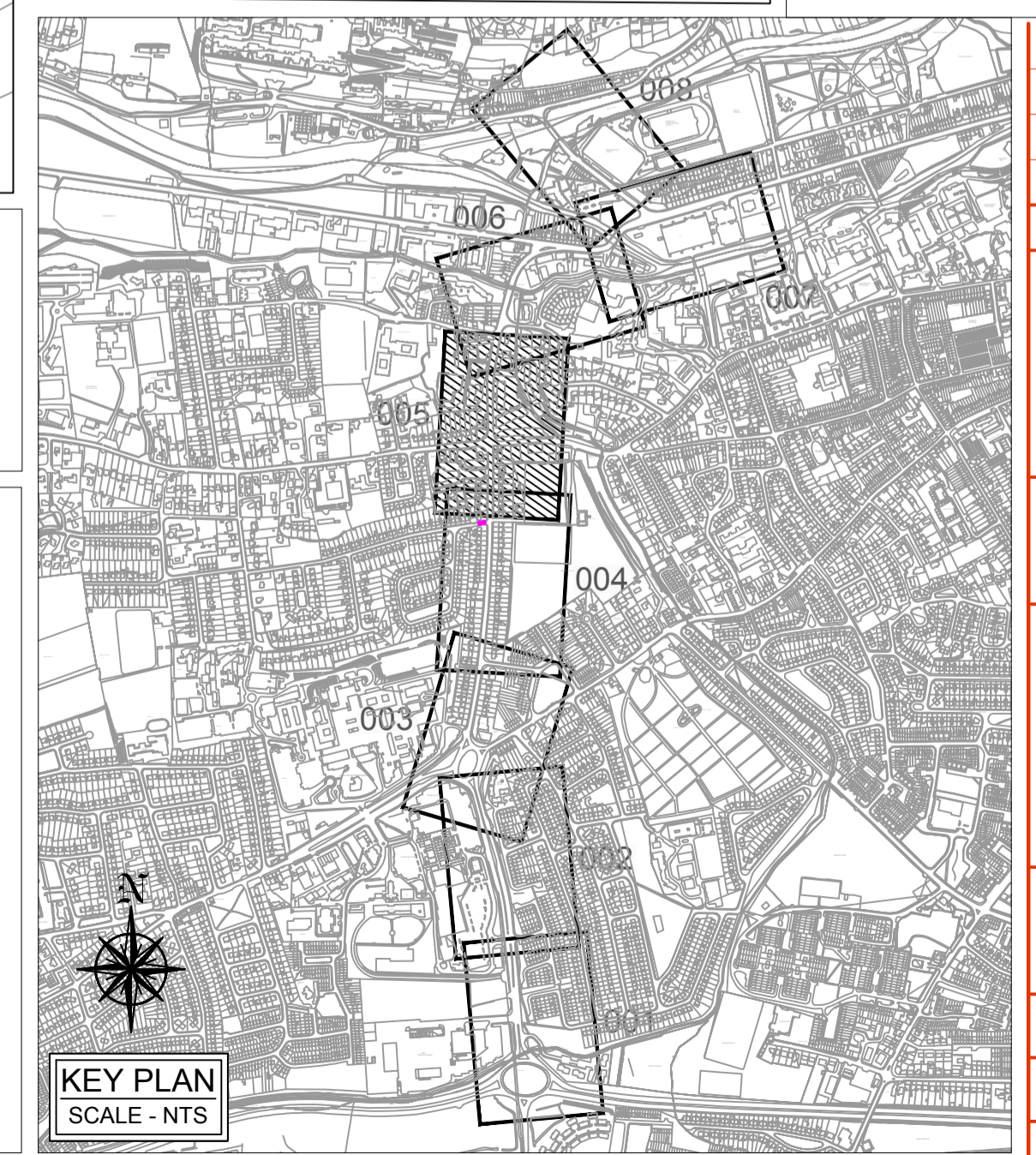

P1	SL	25/07/16	ISSUED FOR INFORMATION
----	----	----------	------------------------

Rev.	By	Date	Description

CORK CITY COUNCIL
COMHAIRLE CATHRACH CHORCAÍ
Roads Design Division
Roads & Transportation Directorate
Anglesea Street
Cork
Telephone: (031) 492 4658

INCLUDES ORDNANCE SURVEY IRELAND DATA REPRODUCED UNDER OSI LICENCE NUMBER 2014/05/CCMA/CorkCityCouncil. UNAUTHORISED REPRODUCTION INFRINGES ORDNANCE SURVEY IRELAND AND GOVERNMENT OF IRELAND COPYRIGHT.
© ORDNANCE SURVEY IRELAND.

Contract
Wilton Road, Sarsfield Road, Victoria Cross & Western Road Project

Title
Part 8 Planning Proposal
Sheet 5 of 8

Scale: 1:500	File Name: W:\Wilton Road\Pre Contract\Part 8 Planning
Drawn: S.L.	Date: May 2016
Checked: JG	Approved: JS
Contract: WR-P8-05	Rev: PI

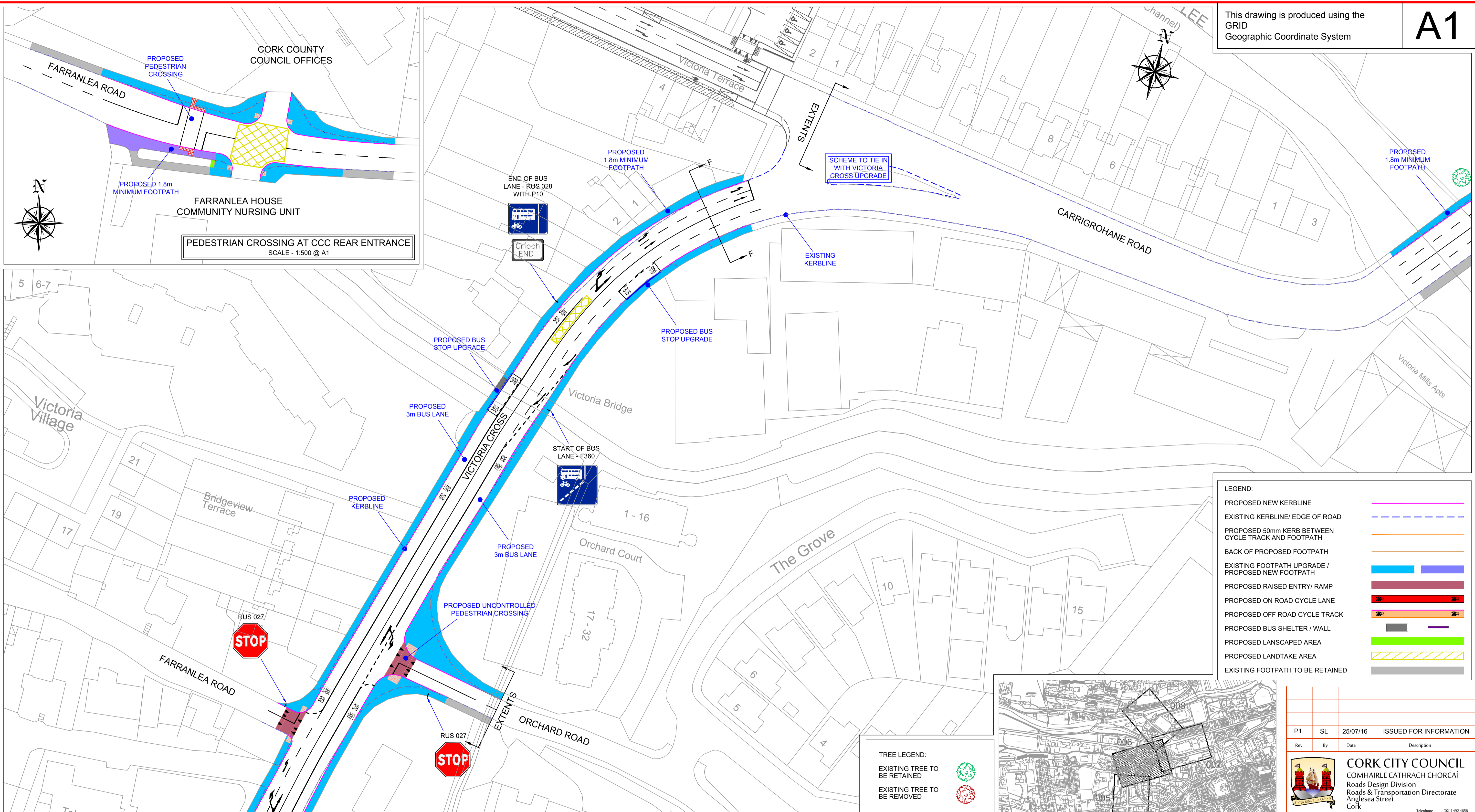

PEDESTRIAN CROSSING AT CCC REAR ENTRANCE
SCALE - 1:500 @ A1

LEGEND:

PROPOSED NEW KERBLINE	
EXISTING KERBLINE/ EDGE OF ROAD	
PROPOSED 50mm KERB BETWEEN CYCLE TRACK AND FOOTPATH	
BACK OF PROPOSED FOOTPATH	
EXISTING FOOTPATH UPGRADE / PROPOSED NEW FOOTPATH	
PROPOSED RAISED ENTRY/ RAMP	
PROPOSED ON ROAD CYCLE LANE	
PROPOSED OFF ROAD CYCLE TRACK	
PROPOSED BUS SHELTER / WALL	
PROPOSED LANDSCAPED AREA	
PROPOSED LANDTAKE AREA	
EXISTING FOOTPATH TO BE RETAINED	

TREE LEGEND:

EXISTING TREE TO BE RETAINED	
EXISTING TREE TO BE REMOVED	

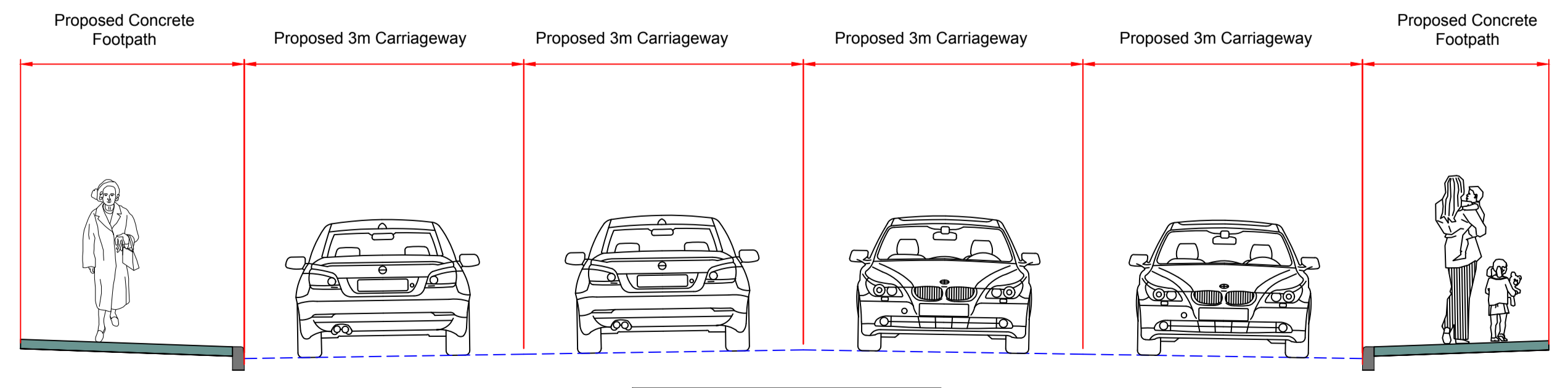

PROPOSED SECTION F-F
SCALE - 1:50

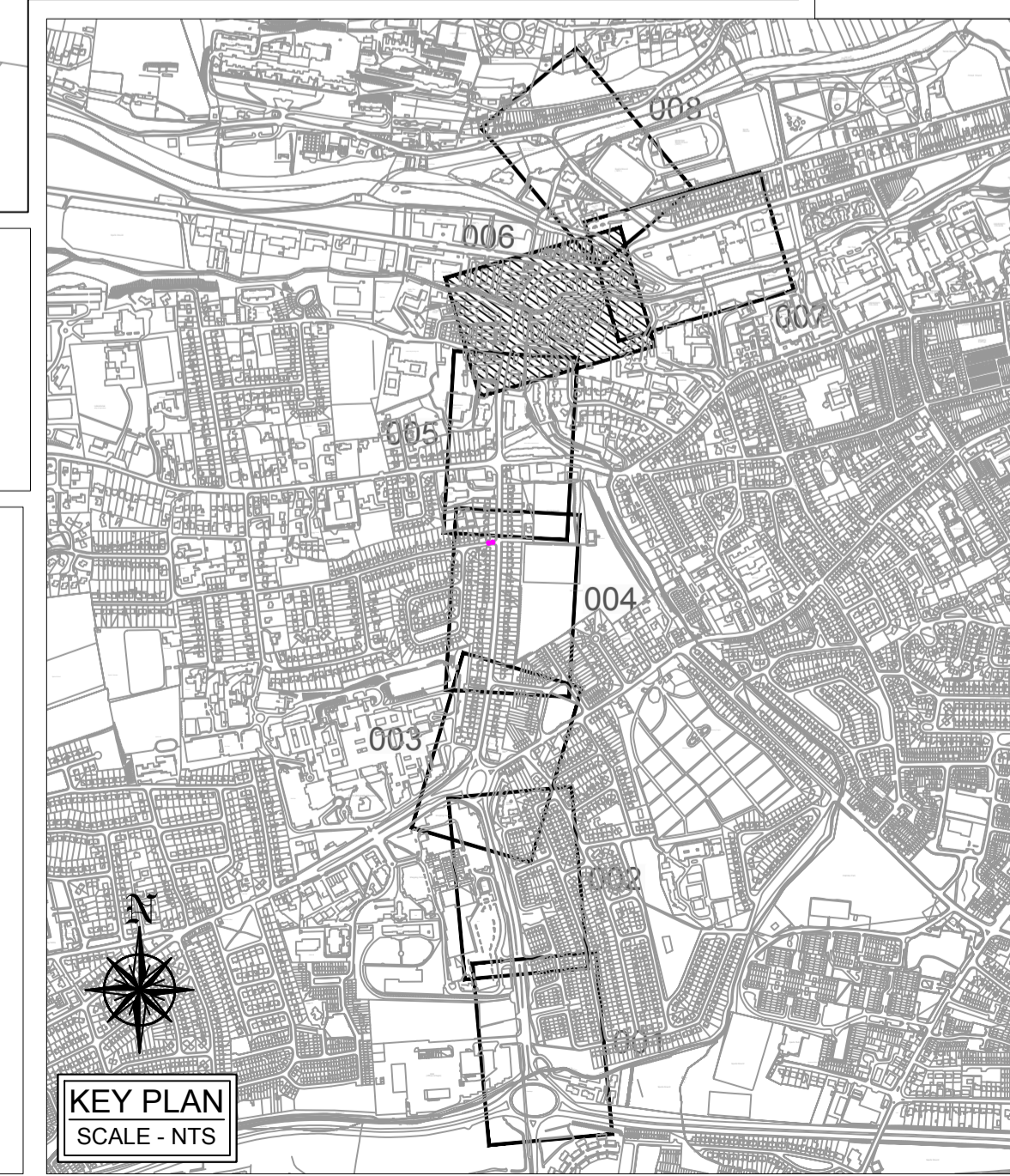

P1	SL	25/07/16	ISSUED FOR INFORMATION
----	----	----------	------------------------

CORK CITY COUNCIL
COMHAIRLE CATHRACH CHORCAÍ
Roads Design Division
Roads & Transportation Directorate
Anglesea Street
Cork
Telephone: (021) 492 4658

INCLUDES ORDNANCE SURVEY IRELAND DATA REPRODUCED UNDER OSI LICENCE NUMBER 2014/05/CCMA/CorkCityCouncil. UNAUTHORISED REPRODUCTION INFRINGES ORDNANCE SURVEY IRELAND AND GOVERNMENT OF IRELAND COPYRIGHT.
© ORDNANCE SURVEY IRELAND.

Wilton Road, Sarsfield Road, Victoria Cross & Western Road Project

Part 8 Planning Proposal
Sheet 6 of 8

Scale: 1:500	File Name: W:\Wilton Road\Pre Contract\Part 8 Planning
Drawn: S.L.	Date: May 2016
Checked: JG	Approved: JS
Contract: WR-P8-06	Rev: PI

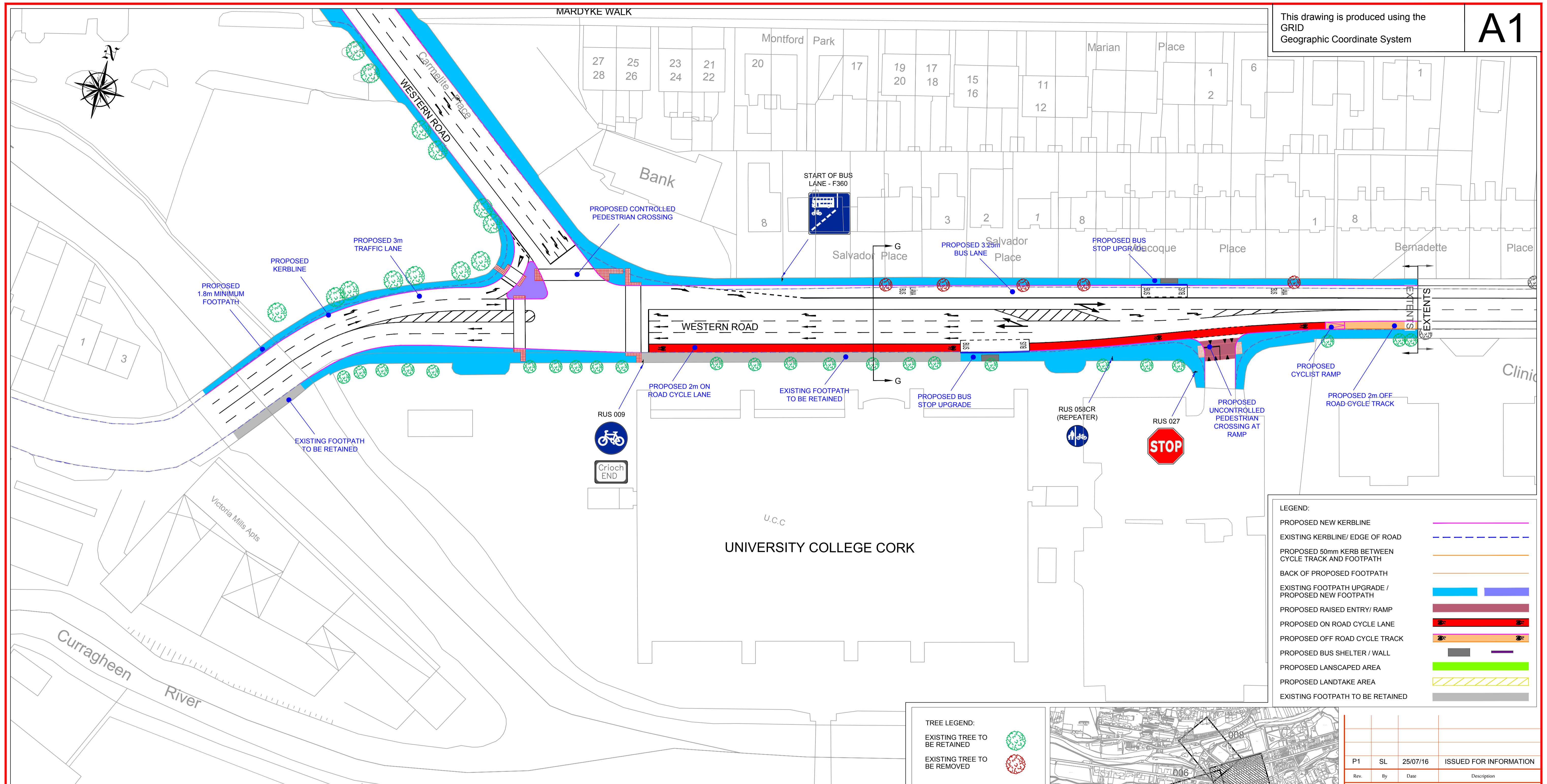

LEGEND:

PROPOSED NEW KERBLINE	— (solid purple line)
EXISTING KERBLINE/ EDGE OF ROAD	- - - (dashed blue line)
PROPOSED 50mm KERB BETWEEN CYCLE TRACK AND FOOTPATH	— (solid orange line)
BACK OF PROPOSED FOOTPATH	— (solid brown line)
EXISTING FOOTPATH UPGRADE / PROPOSED NEW FOOTPATH	— (solid blue line)
PROPOSED RAISED ENTRY/ RAMP	— (solid red line)
PROPOSED ON ROAD CYCLE LANE	— (solid red line with hatching)
PROPOSED OFF ROAD CYCLE TRACK	— (solid orange line with hatching)
PROPOSED BUS SHELTER / WALL	— (solid grey line)
PROPOSED LANDSCAPED AREA	— (solid green line)
PROPOSED LANDTAKE AREA	— (dashed yellow line)
EXISTING FOOTPATH TO BE RETAINED	— (solid grey line)

TREE LEGEND:

EXISTING TREE TO BE RETAINED	— (green tree symbol)
EXISTING TREE TO BE REMOVED	— (red tree symbol)

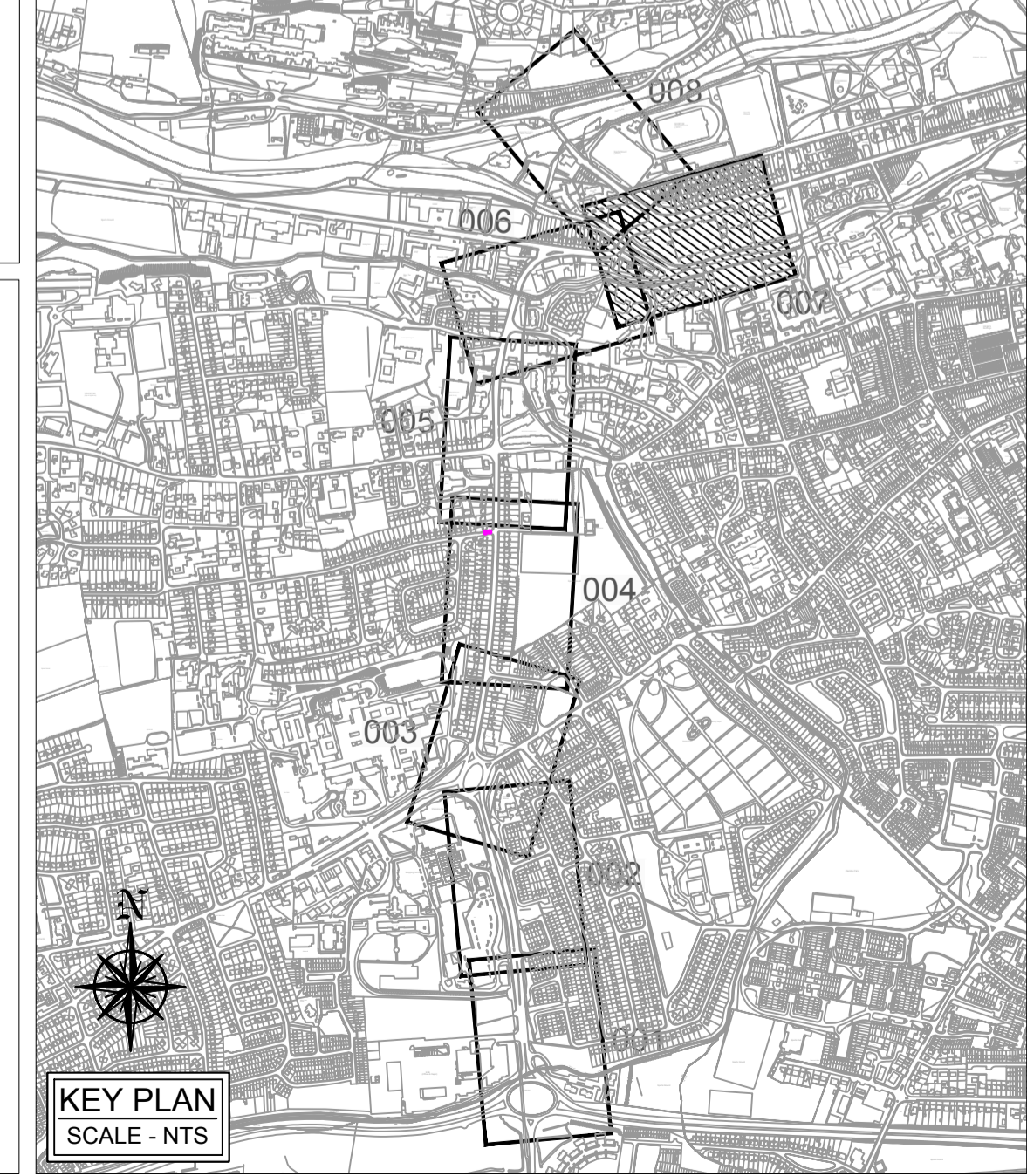
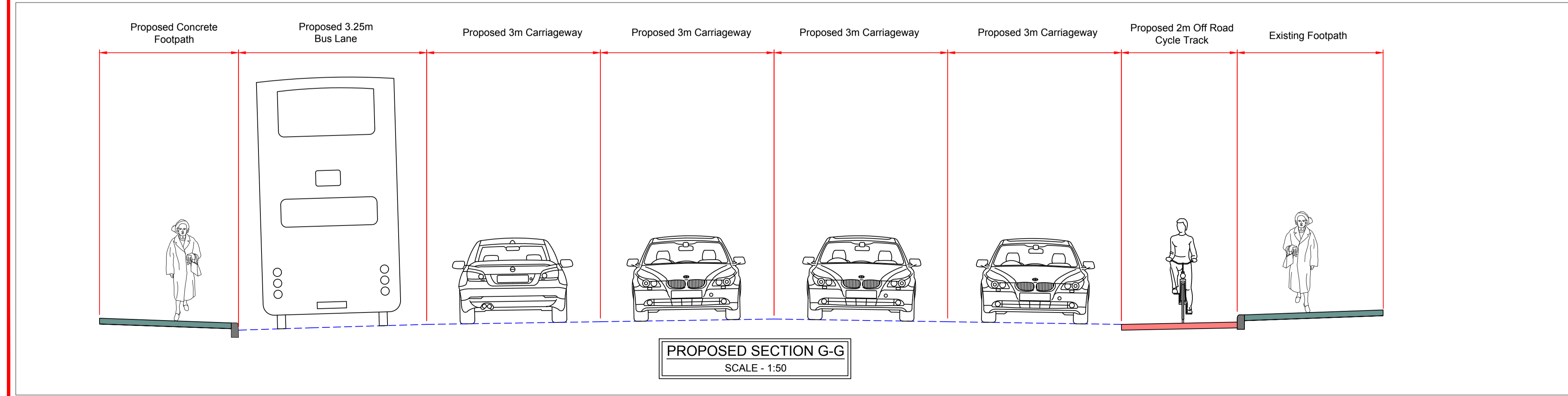

Rev.	By	Date	Description
P1	SL	25/07/16	ISSUED FOR INFORMATION

CORK CITY COUNCIL
COMHAIRLE CATHRACH CHORCAÍ
Roads Design Division
Roads & Transportation Directorate
Anglesea Street
Cork
Telephone: (031) 492 4658

INCLUDES ORDNANCE SURVEY IRELAND DATA REPRODUCED UNDER OSI LICENCE NUMBER 2014/05/CCMA/CorkCityCouncil. UNAUTHORISED REPRODUCTION INFRINGES ORDNANCE SURVEY IRELAND AND GOVERNMENT OF IRELAND COPYRIGHT.
© ORDNANCE SURVEY IRELAND.

Contract
Wilton Road, Sarsfield Road, Victoria Cross & Western Road Project

Title
Part 8 Planning Proposal
Sheet 7 of 8

Scale:	1:500	File Name:	W:\Wilton Road\Pre Contract\Part 8 Planning
Drawn:	S.L.	Date:	May 2016
Checked:	JG	Approved:	JS
Rev.			
		WR-P8-07	PI

OSI Licence No.: EN 0042415 © OSI/GOVERNMENT OF IRELAND A1 - © CSEA 2015 - Rev 00

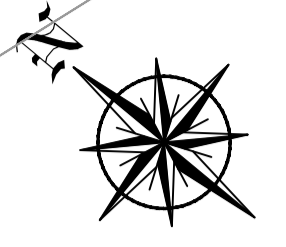

Forms part of a separate planning process

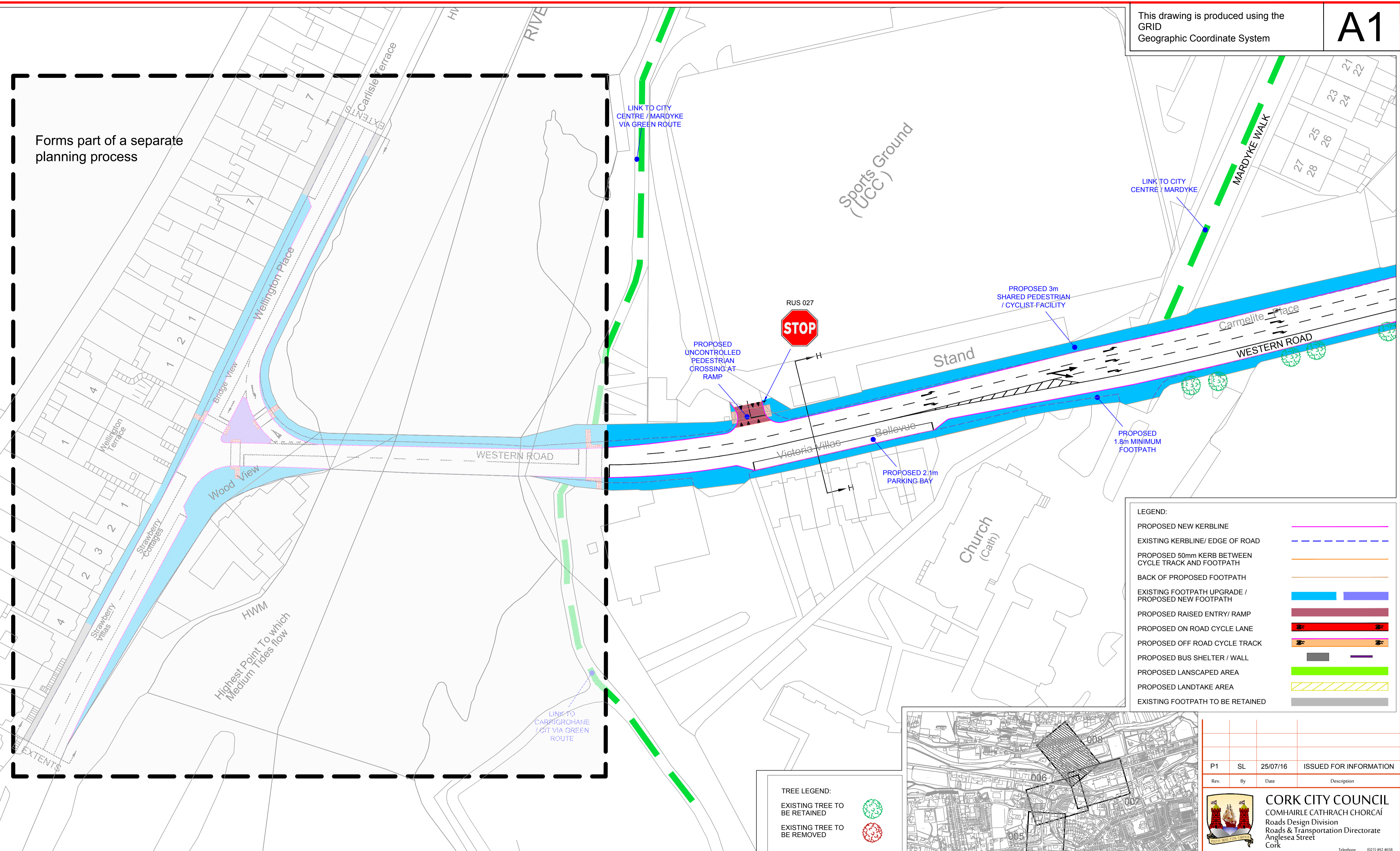

LEGEND:

PROPOSED NEW KERBLINE	—
EXISTING KERBLINE/ EDGE OF ROAD	- - -
PROPOSED 50mm KERB BETWEEN CYCLE TRACK AND FOOTPATH	—
BACK OF PROPOSED FOOTPATH	—
EXISTING FOOTPATH UPGRADE / PROPOSED NEW FOOTPATH	■
PROPOSED RAISED ENTRY/ RAMP	■
PROPOSED ON ROAD CYCLE LANE	■
PROPOSED OFF ROAD CYCLE TRACK	■
PROPOSED BUS SHELTER / WALL	■
PROPOSED LANDSCAPED AREA	■
PROPOSED LANDTAKE AREA	■
EXISTING FOOTPATH TO BE RETAINED	■

TREE LEGEND:

EXISTING TREE TO BE RETAINED	●
EXISTING TREE TO BE REMOVED	●

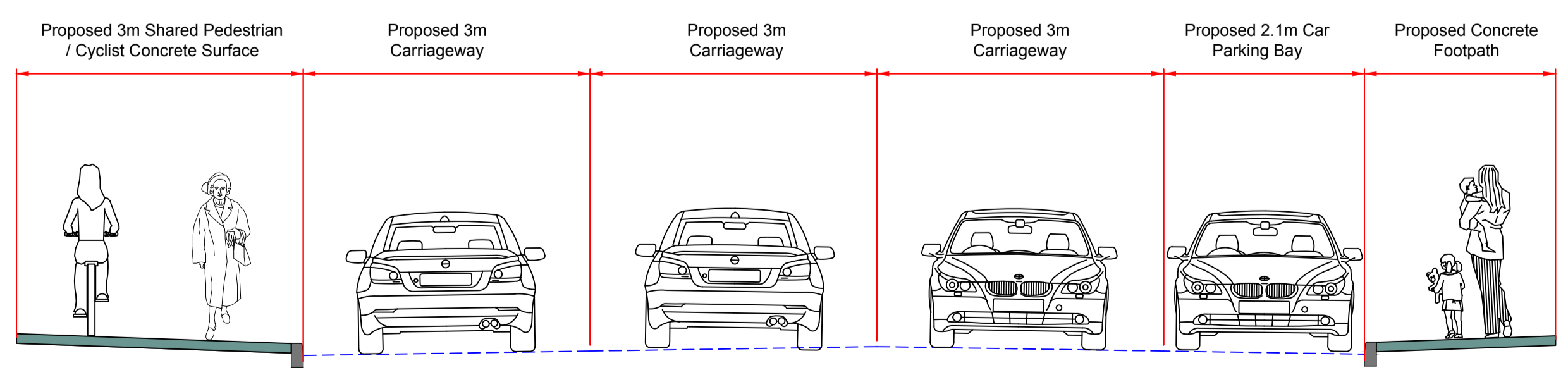
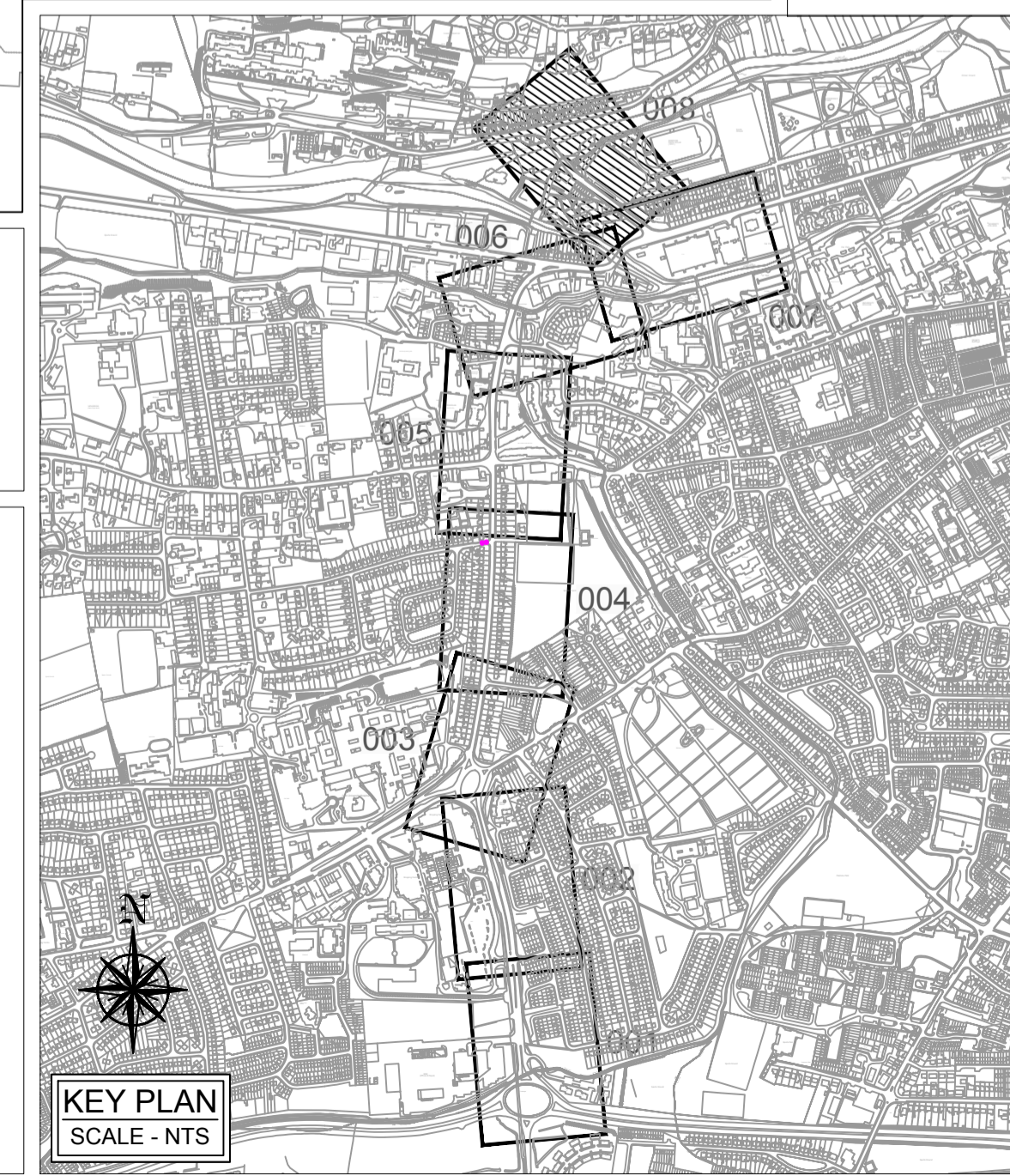

P1	SL	25/07/16	ISSUED FOR INFORMATION
Rev.	By	Date	Description
CORK CITY COUNCIL COMHAIRLE CATHRACH CHORCAÍ Roads Design Division Roads & Transportation Directorate Anglesea Street Cork Telephone: (031) 492 4658			
INCLUDES ORDNANCE SURVEY IRELAND DATA REPRODUCED UNDER OSI LICENCE NUMBER 2014/05/CCMA/CorkCityCouncil. UNAUTHORISED REPRODUCTION INFRINGES ORDNANCE SURVEY IRELAND AND GOVERNMENT OF IRELAND COPYRIGHT. © ORDNANCE SURVEY IRELAND.			
Contract Wilton Road, Sarsfield Road, Victoria Cross & Western Road Project			
Title Part 8 Planning Proposal Sheet 8 of 8			
Scale:	1:500	File Name:	W:\Wilton Road\Pre Contract\Part 8 Planning
Drawn:	S.L.	Date:	May 2016
Checked:	JG	Approved:	JS
WR-P8-08			PI

OSI Licence No.: EN 0042415 © OSI/GOVERNMENT OF IRELAND A1 - © CSEA 2015 - Rev 00