

Specification

- ① Existing two storey dwelling
- ② Existing single storey dwelling
- ③ Existing low front boundary wall to single storey dwellings
- ④ Existing front gated entrance to single storey dwellings
- ⑤ Existing single storey house to the rear of the proposed site
- ⑥ Proposed two bed dwelling
- ⑦ Proposed pedestrian gated entrance
- ⑧ Proposed front boundary pillars
- ⑨ Proposed one bed dwelling
- ⑩ Proposed low front wall 1000mm along existing pedestrian pathway
- ⑪ Proposed vehicular entrance gate, and pedestrian gates inset gates are teak or similar timber sheeted galvanised steel - refer to elevation drawings

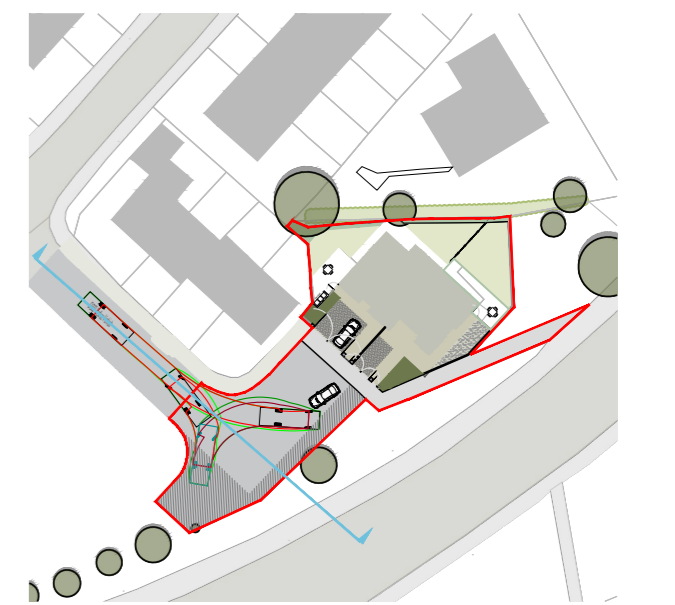

KEY PLAN- SECTION LOCATION
Scale 1:1000

PROPOSED CONTIGUOUS ELEVATION

Scale 1:100

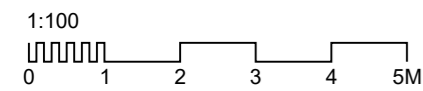

STANDARD INSTRUCTIONS

1 THE MAIN CONTRACTOR, SUB-CONTRACTOR OR SUPPLIER SHALL VERIFY ALL DIMENSIONS ON SITE AND IMMEDIATELY REPORT TO THE ARCHITECT ANY DISCREPANCIES ON THE DRAWINGS.
WORK TO FIGURED DIMENSIONS ONLY (EXCEPT WHERE FULL SIZE DETAILS ARE PROVIDED).
NOT VARY ANY WORK SHOWN ON THE DRAWINGS WITHOUT OBTAINING PRIOR APPROVAL FROM THE ARCHITECT.
BE RESPONSIBLE FOR REQUESTING FROM THE ARCHITECT ANY ADDITIONAL INFORMATION REQUIRED.
SUPPLY TO THE ARCHITECT ALL SHOP DRAWINGS, ILLUSTRATIONS, SPECIFICATIONS, ETC. OF ALL SPECIALIST WORK TO BE INCORPORATED IN THE MAIN CONTRACT WORKS.

IMMEDIATELY INFORM THE ARCHITECT IF ANY WORK SHOWN ON THIS DRAWING IS NOT IN ACCORDANCE WITH THE RELEVANT CODES OF PRACTICE RECOGNISED GOOD PRACTICE THROUGHOUT THE INDUSTRY AND DOES NOT COMPLY WITH THE RELEVANT LOCAL AUTHORITY BYELAWS OR BUILDING REGULATIONS.
IMMEDIATELY ADVISE THE ARCHITECT / QUANTITY SURVEYOR OF THE EFFECT UPON PROGRAMME AND COST OF ANY ALTERATIONS TO THE PROPOSED WORKS SHOWN ON THIS DRAWING.
2 THIS DRAWING SUPersedES ALL PREVIOUS ISSUES OF THE SAME DRAWING NUMBER WITH EARLIER REVISIONS.
3 THIS DRAWING IS COPYRIGHT TO KENNETH HENNESSY ARCHITECTS LTD. AND THE CONTENTS MUST NOT BE DISCLOSED TO ANYONE WITHOUT PRIOR AGREEMENT.

GENERAL NOTES

ALL DIMENSIONS TO BE CHECKED ON SITE.
THIS DRAWING IS TO BE READ IN CONJUNCTION WITH ALL RELEVANT SPECIFICATIONS AND DRAWINGS.
IN THE EVENT OF ANY DISCREPANCIES BETWEEN DRAWINGS THE CONTRACTOR IS TO INFORM THE ARCHITECT IMMEDIATELY.
DO NOT SCALE. USE FIGURED DIMENSIONS ONLY.
ALL WORK TO COMPLY WITH CURRENT BUILDING REGS & S.S.

REVISION REGISTER

REV	DATE	DESCRIPTION	DRAWN	CHECKED	APPROVED
P01	1/09/23	ISSUED FOR PART VIII PLANNING	GD	AQ	AQ



tel: 052 6128966
fax: 052 6180950
email: info@kharchitects.ie
Anglesea House, Anglesea Street
Clonmel, Co. Tipperary

STATUS: **PLANNING**

CLIENT: CORK CITY COUNCIL	
PROJECT: NEW SHELTERED ACCOMMODATION AT 101-102 HOLLYVILLE, HOLLYHILL CORK CITY, COUNTY CORK	
DRAWING TITLE: PROPOSED CONTIGUOUS ELEVATIONS	
PROJECT: 2245	NO: KHA
DATE: ZZ00	TYPE: DR/A/P
SCALE: 4000	SHEET: S1
NO: P01	REV: P01