

COPYRIGHT AND OWNERSHIP OF THIS DRAWING IS VESTED IN DRA CONSULTING ENGINEERS. NO PART OF THIS DOCUMENT MAY BE REPRODUCED OR TRANSMITTED IN ANY FORM OR STORED IN ANY RETRIEVAL SYSTEM OF ANY NATURE WITHOUT THE WRITTEN PERMISSION OF DRA CONSULTING ENGINEERS AS COPYRIGHT HOLDER EXCEPT AS AGREED FOR USE ON THE PROJECT FOR WHICH THE DOCUMENT WAS ORIGINALLY ISSUED. ©

ALL RIGHT RESERVED BY THE LAW OF COPYRIGHT AND BY INTERNATIONAL COPYRIGHT CONVENTIONS ARE RESERVED TO DRA CONSULTING ENGINEERS. ©

ORDNANCE SURVEY MAPS REPRODUCED UNDER LICENCE No. CYAL50173115. © ORDNANCE SURVEY IRELAND / GOVERNMENT OF IRELAND.

NOTES:

1. ALL DIMENSIONS ARE IN MILLIMETRES AND LEVELS IN METRES UNLESS NOTED OTHERWISE.
2. USE FIGURED DIMENSIONS ONLY. DO NOT SCALE.
3. DRAWINGS TO BE READ IN CONJUNCTION WITH ALL RELEVANT ENGINEER'S, ARCHITECT'S AND SERVICE ENGINEER'S DRAWINGS AND SPECIFICATIONS.
4. ALL WORKS TO BE CARRIED OUT IN ACCORDANCE WITH CURRENT BUILDING REGULATIONS.

LEGEND:

- SITE BOUNDARY
- EXISTING SURFACE WATER SEWER
- - - EXISTING FOUL SEWER
- - - EXISTING WATERMAIN
- EXISTING BOUNDARY BOX

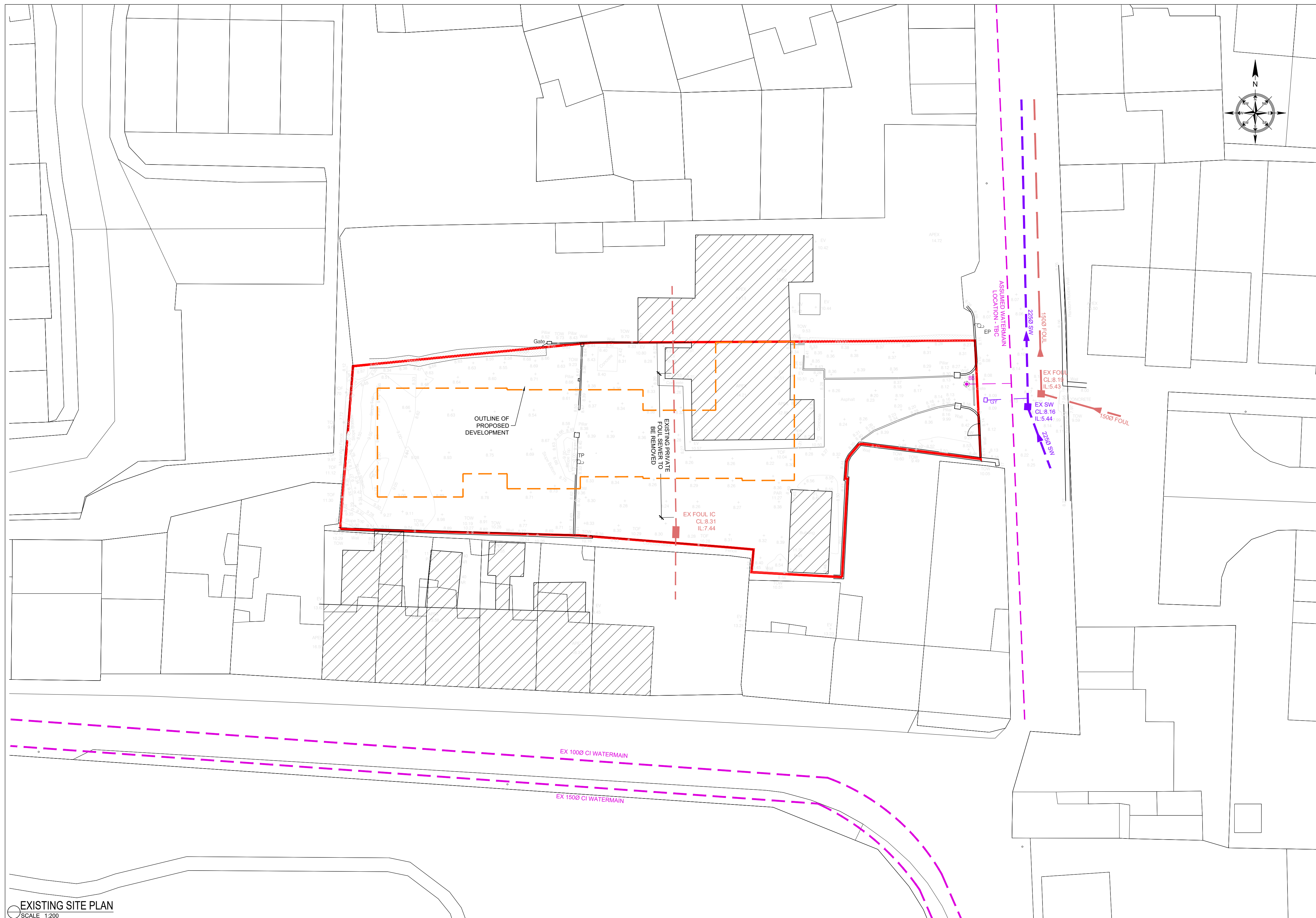

REV.	DESCRIPTION	PROD.	VERIF.	APPR.	DATE
5	BUILDING FOOTPRINT REVISED	RP	JR	AD	09/04/24
4	REDLINE UPDATED	RP	JR	AD	03/11/23
3	UPDATED TO REFLECT GPR SURVEY	RP	JR	AD	27/09/23
2	EXISTING INVERT LEVELS ADDED	RP	JR	AD	20/09/23

PART 8



DUBLIN T: 01-216-2956 | LIMERICK 061-310-701 | WEXFORD 053-915-2814 | E: info@draconsulting.ie | W: www.draconsulting.ie

CLIENT: CORK CITY COUNCIL

PROJECT: PROPOSED DEVELOPMENT AT THE GARDENS, ROPE WALK, BLACKROCK, CORK

TITLE: EXISTING SITE PLAN

DATE:	DESIGNER:	PRODUCER:	VERIFIER:	APPROVER:	SCALE:	REV.
28/08/2023	RP	RP	JR	AD	1:200 @ A1	5

EXISTING SITE PLAN
SCALE 1:200

IRISH WATER STANDARD DETAILS AND CODE PRACTICE (FOUL DRAINAGE):
 ALL OF THE UNDERGROUND FOUL DRAINAGE WORKS, FROM THE PUBLIC SIDE INSPECTION CHAMBER TO NEW CONNECTION TO EXISTING PUBLIC MANHOLE, SHOULD BE CARRIED OUT IN ACCORDANCE WITH IRISH WATER'S (IW) "WASTEWATER INFRASTRUCTURE STANDARD DETAILS" AND "CODE OF PRACTICE FOR WASTEWATER INFRASTRUCTURE".

PIPE MATERIALS:
 1. SERVICE CONNECTIONS FROM DWELLINGS TO BE 100mm Ø UNPLASTICISED PVC IN ACCORDANCE WITH SECTION 3.13 OF IW CODE PRACTICE.
 2. FOUL SEWERS TO BE IN ACCORDANCE WITH SECTION 3.13 OF THE IW CODE OF PRACTICE.

TESTING:
 1. FOUL SEWER AND MANHOLES TO BE TESTED IN ACCORDANCE WITH SECTION 4.10 OF IW CODE OF PRACTICE.
 2. CCTV AND MANHOLE CONDITION SURVEYS TO BE CARRIED OUT IN ACCORDANCE WITH SECTION 1.9 OF IW CODE OF PRACTICE IN ADVANCE OF THE DEFECTS LIABILITY PERIOD.

IRISH WATER INSPECTIONS & AS-BUILTS:
 1. CONTRACTOR TO ENSURE THAT IW FIELD ENGINEERS INSPECT WORKS IN ACCORDANCE WITH THE QUALITY ASSURANCE (QA) FIELD INSPECTION REQUIREMENTS MANUAL.
 2. CONTRACTOR TO ENSURE THAT AS CONSTRUCTED ELEMENTS ARE ADEQUATELY SURVEYED PRIOR TO COVERING UP TO ENSURE AS-BUILT DRAWINGS IN ACCORDANCE WITH QUALITY ASSURANCE (QA) FIELD INSPECTION REQUIREMENTS MANUAL CAN BE PRODUCED ON COMPLETION OF WORK.

CONSTRUCTION DETAILS:
 ALL SITE WATER SERVICES TO BE IN ACCORDANCE WITH CURRENT IRISH WATER INFRASTRUCTURE STANDARD DETAILS REFER TO IRISH WATER STANDARD DETAILS. DOCUMENT No. IW.-CDS-5030-01

TECHNICAL GUIDANCE DOCUMENT PART H (SURFACE WATER & PRIVATE FOUL DRAINAGE):

ALL PRIVATE FOUL DRAINAGE UPSTREAM OF THE IRISH WATER PRIVATE SIDE INSPECTION CHAMBER AND ALL OF THE SURFACE WATER DRAINAGE SHOULD BE CARRIED OUT IN ACCORDANCE WITH PART H - DRAINAGE & THE GREATER DUBLIN REGIONAL CODE OF PRACTICE FOR DRAINAGE WORKS.

MATERIALS:
 1. ALL UNDERGROUND PIPEWORK TO BE IN ACCORDANCE WITH TABLE 7 OF PART H & SECTION 11 OF THE GREATER DUBLIN REGIONAL CODE OF PRACTICE FOR DRAINAGE WORKS.

MANHOLES:
 1. ALL SURFACE WATER MANHOLES TO BE CONSTRUCTED IN ACCORDANCE WITH SECTION 9 OF THE GREATER DUBLIN REGIONAL CODE OF PRACTICE FOR DRAINAGE WORKS.

BEDDING:
 1. ALL UNDERGROUND PIPEWORK TO BE IN ACCORDANCE WITH DIAGRAM 8 OF PART H & SECTION 11 OF THE GREATER DUBLIN REGIONAL CODE OF PRACTICE FOR DRAINAGE WORKS

TESTING:
 1. TESTING TO BE IN ACCORDANCE WITH SECTION 12 OF THE GREATER DUBLIN REGIONAL CODE OF PRACTICE FOR DRAINAGE WORKS.
 2. ALL EXISTING SEWERS WITHIN THE SITES BOUNDARY SHOULD BE CCTV SURVEYED PRIOR TO COMMENCEMENT OF WORKS.
 3. ALL NEW DRAINAGE SHOULD BE CCTV SURVEYED ON COMPLETION OF WORKS.

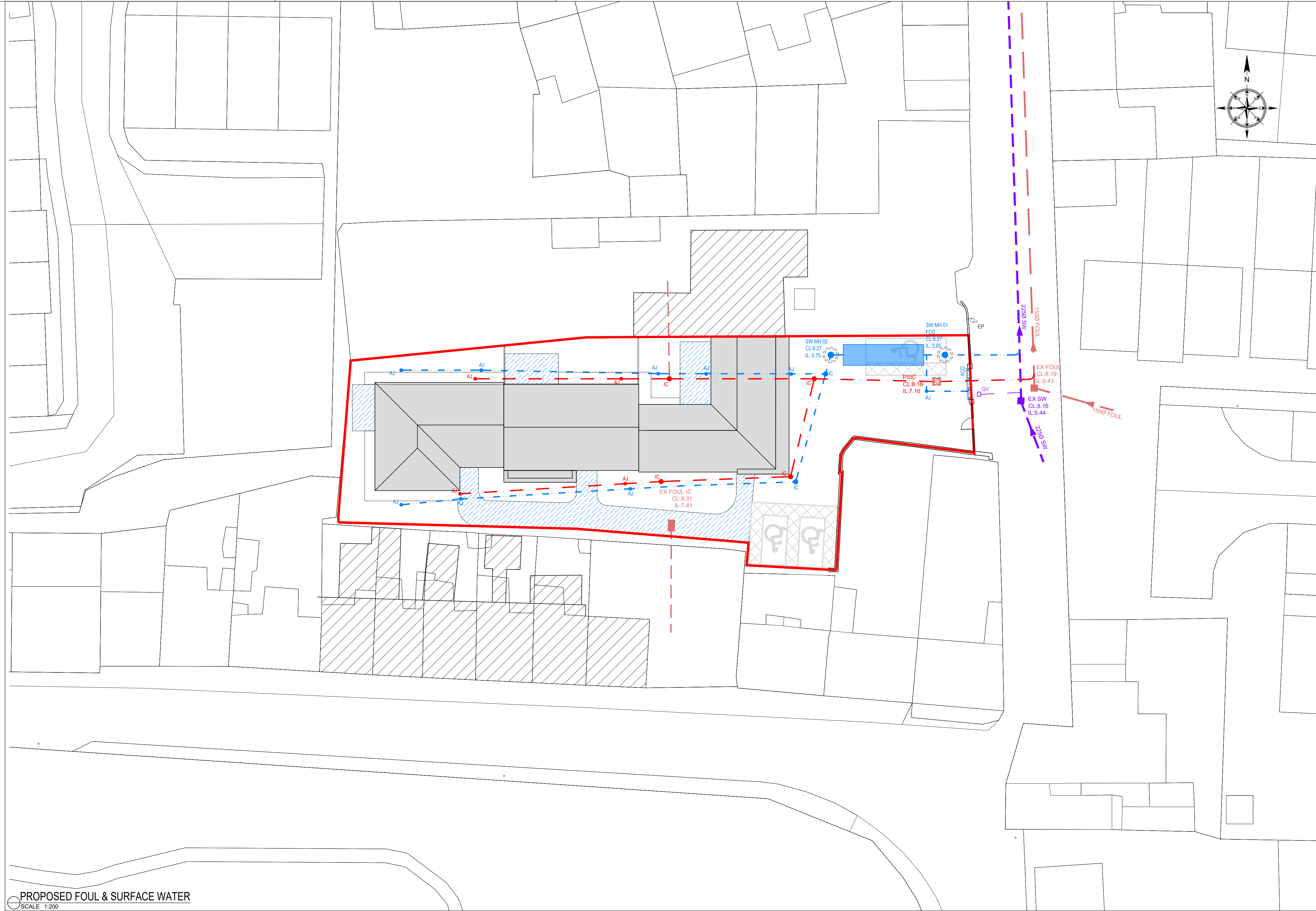

COPYRIGHT AND OWNERSHIP OF THIS DRAWING IS VESTED IN DRA CONSULTING ENGINEERS. NO PART OF THIS DOCUMENT MAY BE REPRODUCED OR TRANSMITTED IN ANY FORM OR STORED IN ANY RETRIEVAL SYSTEM OF ANY NATURE WITHOUT THE WRITTEN PERMISSION OF DRA CONSULTING ENGINEERS AS COPYRIGHT HOLDER EXCEPT AS AGREED FOR USE ON THE PROJECT FOR WHICH THE DOCUMENT WAS ORIGINALLY ISSUED. ©

ALL RIGHT RESERVED BY THE LAW OF COPYRIGHT AND BY INTERNATIONAL COPYRIGHT CONVENTIONS ARE RESERVED TO DRA CONSULTING ENGINEERS. ©

ORDNANCE SURVEY MAPS REPRODUCED UNDER LICENCE No. CYAL50173115. © ORDNANCE SURVEY IRELAND / GOVERNMENT OF IRELAND.

NOTES:
 1. ALL DIMENSIONS ARE IN MILLIMETRES AND LEVELS IN METRES UNLESS NOTED OTHERWISE.
 2. USE FIGURED DIMENSIONS ONLY. DO NOT SCALE.
 3. DRAWINGS TO BE READ IN CONJUNCTION WITH ALL RELEVANT ENGINEER'S, ARCHITECT'S AND SERVICE ENGINEER'S DRAWINGS AND SPECIFICATIONS.
 4. ALL WORKS TO BE CARRIED OUT IN ACCORDANCE WITH CURRENT BUILDING REGULATIONS.

- LEGEND:**
- SITE BOUNDARY
 - EXISTING SURFACE WATER SEWER
 - PROPOSED SURFACE WATER SEWER (100mmØ @ 1:100)
 - PROPOSED SURFACE WATER INSPECTION CHAMBER AS PER PART H (600-1000mm DEEP, Ø450mm)
 - PROPOSED SURFACE WATER AJ AS PER PART H (400-600mm DEEP, Ø300mm)
 - FLOW CONTROL DEVICE, MAX DISCHARGE = 5.0 l/s (MANHOLE BENCHES AS PER MANUFACTURERS REQUIREMENTS)
 - ATTENUATION TANK (STORAGE VOLUME = 2.5m³)
 - PERMEABLE PAVING
 - EXISTING FOUL SEWER
 - PROPOSED FOUL SEWER (100mmØ @ 1:60 - 1:80)
 - PROPOSED FOUL INSPECTION CHAMBER AS PER IW DETAIL STD-WW-13 (CIRCA 900mm DEEP)
 - PROPOSED FOUL INSPECTION CHAMBER AS PER PART H (600-1000mm DEEP, Ø450mm)
 - PROPOSED FOUL AJ AS PER PART H (400-600mm DEEP, Ø300mm)

REV.	DESCRIPTION	PROD.	VERIF.	APPR.	DATE
5	BUILDING FOOTPRINT REVISED	RP	JR	AD	09/04/24
4	ENTRANCE UPDATED	RP	JR	AD	03/11/23
3	DRAINAGE UPDATED TO MATCH GPR SURVEY DRAWING	RP	JR	AD	27/09/23
2	EXISTING INVERT LEVELS ADDED AND DRAINAGE UPDATED	RP	JR	AD	20/09/23

PART 8

DRA
 CONSULTING ENGINEERS

DUBLIN: 01-216-2956 | LIMERICK: 061-310-701 | WEXFORD: 053-915-2814 | E: info@draconsulting.ie | W: www.draconsulting.ie

CLIENT: CORK CITY COUNCIL

PROJECT: PROPOSED DEVELOPMENT AT THE GARDENS, ROPE WALK, BLACKROCK, CORK

TITLE: PROPOSED FOUL & SURFACE WATER

DATE:	DESIGNER:	PRODUCER:	VERIFIER:	APPROVER:	SCALE:	REV.
28/08/2023	RP	RP	JR	AD	1:200 @ A1	
						5

ORG. No. 23082-150

PROPOSED FOUL & SURFACE WATER
 SCALE 1:200

COPYRIGHT AND OWNERSHIP OF THIS DRAWING IS VESTED IN DRA CONSULTING ENGINEERS. NO PART OF THIS DOCUMENT MAY BE REPRODUCED OR TRANSMITTED IN ANY FORM OR STORED IN ANY RETRIEVAL SYSTEM OF ANY NATURE WITHOUT THE WRITTEN PERMISSION OF DRA CONSULTING ENGINEERS AS COPYRIGHT HOLDER EXCEPT AS AGREED FOR USE ON THE PROJECT FOR WHICH THE DOCUMENT WAS ORIGINALLY ISSUED. ©
 ALL RIGHT RESERVED BY THE LAW OF COPYRIGHT AND BY INTERNATIONAL COPYRIGHT CONVENTIONS ARE RESERVED TO DRA CONSULTING ENGINEERS. ©

ORDNANCE SURVEY MAPS REPRODUCED UNDER LICENCE No. CYAL50173115.
 © ORDNANCE SURVEY IRELAND / GOVERNMENT OF IRELAND.

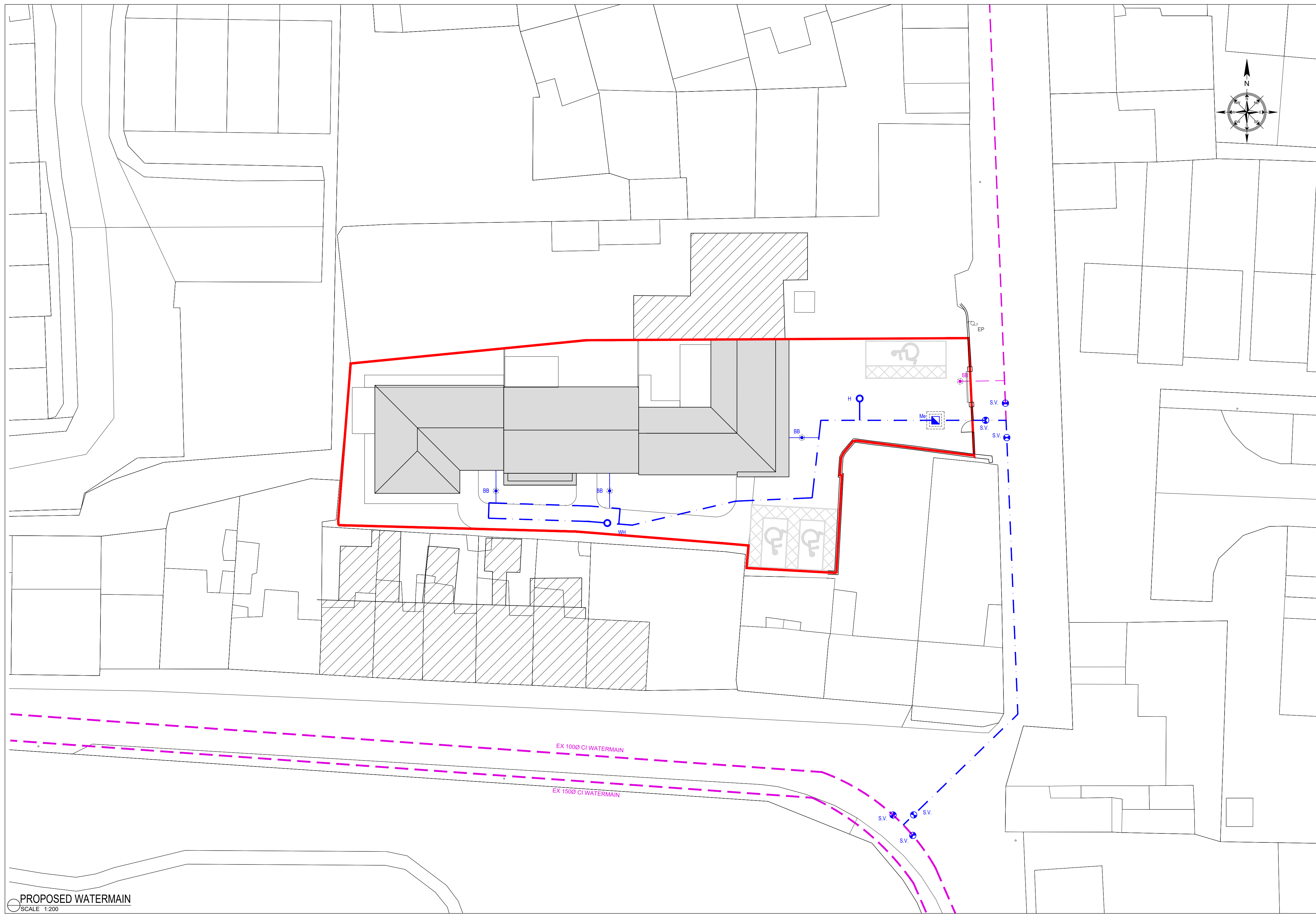

- NOTES:**
1. ALL DIMENSIONS ARE IN MILLIMETRES AND LEVELS IN METRES UNLESS NOTED OTHERWISE.
 2. USE FIGURED DIMENSIONS ONLY. DO NOT SCALE.
 3. DRAWINGS TO BE READ IN CONJUNCTION WITH ALL RELEVANT ENGINEER'S, ARCHITECT'S AND SERVICE ENGINEER'S DRAWINGS AND SPECIFICATIONS.
 4. ALL WORKS TO BE CARRIED OUT IN ACCORDANCE WITH CURRENT BUILDING REGULATIONS.

- LEGEND:**
- SITE BOUNDARY
 - - - EXISTING WATERMAIN
 - S.V. (circle with dot) EXISTING SLUCE VALVE
 - BB (circle with cross) EXISTING BOUNDARY BOX
 - - - PROPOSED WATERMAIN (1000 PE)
 - - - PROPOSED SERVICE CONNECTION (250 PE)
 - S.V. (circle with dot) PROPOSED SLUCE VALVE
 - H (circle) PROPOSED HYDRANT
 - WH (circle) PROPOSED WASHOUT HYDRANT
 - BB (circle with cross) PROPOSED BOUNDARY BOX
 - Me (square) PROPOSED WATERMETER

IRISH WATER STANDARD DETAILS AND CODE PRACTICE:
 ALL OF THE SITE WATERMAIN WORKS SHOULD BE CARRIED OUT IN ACCORDANCE WITH IRISH WATER'S (IW) "WATER INFRASTRUCTURE STANDARD DETAILS" AND "CODE OF PRACTICE FOR WATER INFRASTRUCTURE".

- MATERIALS:**
1. ALL WATERMAIN PIPE MATERIALS TO BE IN ACCORDANCE WITH SECTION 3.9 OF THE CODE OF PRACTICE.
 2. HYDRANTS TO COMPLY WITH BS 750, TYPE 2 SCREW DOWN TYPE & IRISH WATER CODE OF PRACTICE.
 3. HYDRANT INDICATOR PLATES TO COMPLY WITH BS 3251 & IRISH WATER CODE OF PRACTICE.

- TESTING:**
1. ALL ELEMENTS TO BE TESTED IN ACCORDANCE WITH SECTION 4.10 OF IW CODE OF PRACTICE.

- IRISH WATER INSPECTIONS & AS-BUILTS:**
1. CONTRACTOR TO ENSURE THAT IW FIELD ENGINEERS INSPECTS WORKS IN ACCORDANCE WITH QUALITY ASSURANCE (QA) FIELD INSPECTION REQUIREMENTS MANUAL.
 2. CONTRACTOR TO ENSURE THAT AS CONSTRUCTED ELEMENTS ARE ADEQUATELY SURVEYED PRIOR TO COVERING UP TO ENSURE AS-BUILT DRAWINGS IN ACCORDANCE WITH QUALITY ASSURANCE (QA) FIELD INSPECTION REQUIREMENTS MANUAL CAN BE PRODUCED ON COMPLETION OF WORK.

REV.	DESCRIPTION	PROD.	VERIF.	APPR.	DATE
6	WATERMAIN UPDATED	RP	JR	AD	23/04/24
5	BUILDING FOOTPRINT REVISED	RP	JR	AD	09/04/24
4	ENTRANCE UPDATED	RP	JR	AD	03/11/23
3	UPDATED TO REFLECT UPDATED SITE PLAN	RP	JR	AD	27/09/23
2	UPDATED TO REFLECT DRAINAGE DRAWING	RP	JR	AD	20/09/23

PART 8

DRA
 CONSULTING ENGINEERS

NSAI
 Registered Engineer
 Member of the Institution of Engineers, Ireland

DUBLIN T: 01-216-2956 | LIMERICK 061-310-701 | WEXFORD 053-915-2814 | E: info@draconsulting.ie | W: www.draconsulting.ie

CLIENT: CORK CITY COUNCIL

PROJECT: PROPOSED DEVELOPMENT AT THE GARDENS, ROPE WALK, BLACKROCK, CORK

TITLE: PROPOSED WATERMAIN

DATE:	DESIGNER:	PRODUCER:	VERIFIER:	APPROVER:	SCALE:	REV.
28/08/2023	RP	RP	JR	AD	1:200 @ A1	6
					DRG. No.	23082-160

PROPOSED WATERMAIN
 SCALE 1:200

