

- Notes**
1. Exact location of Pedestrian Crossing to be agreed on site with Cork County Council prior to commencement.
 2. Footpath dishing shall be constructed in tactile paving and shall be added in and surrounded in concrete, macadam shall not be used without prior approval.
 3. A minimum clearance of 450mm from the nearest carriageway edge shall be provided to all signs / poles and signal equipment. (This may be increased where there is a high road camber or super elevation)
 4. This layout only applies for design speeds of 50KPH or lower & on roads with public lighting.
 5. All signs and road markings shall comply with the TSM and TS4: Guidelines, Certification Scheme and Specification for Construction of Traffic Signs, DoEHLG.

Key Plan
Scale 1:2500

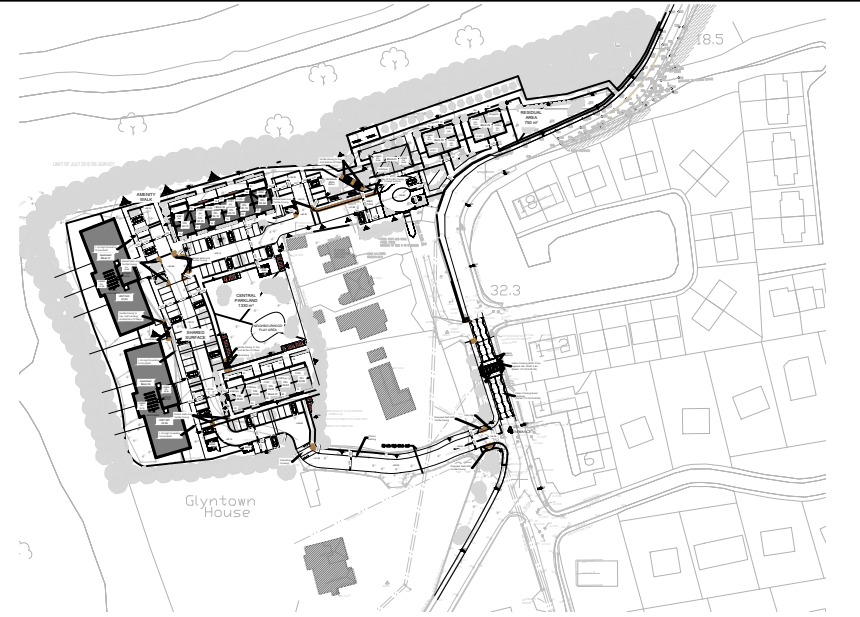

Site Layout
Scale 1:250



Joyce House
Barrack Square
Ballincollig
Cork
P31 KP84

021 4871781
info@dosa.ie
www.dosa.ie

THIS DRAWING IS COPYRIGHT, NO PART OF THIS DOCUMENT MAY BE REPRODUCED OR TRANSMITTED IN ANY FORM OR STORED IN ANY RETRIEVAL SYSTEM OF ANY NATURE WITHOUT THE WRITTEN PERMISSION OF THE ENGINEER AS COPYRIGHT HOLDER EXCEPT AS AGREED FOR USE ON THE PROJECT FOR WHICH THE DOCUMENT WAS ORIGINALLY ISSUED.

REV.	DRAWN	CHKD	APPRVD	DATE	DETAILS
H	E.C.	B.O'S.	C.O'S.	06.09.'24	Revised And Reissued For Part 8
G	E.C.	B.O'S.	C.O'S.	26.08.'24	Revised And Reissued For Part 8
F	E.C.	B.O'S.	C.O'S.	24.05.'24	Issued For Part 8 Feedback

CUBIT	
PROJECT	Development at Glyntown, Glanmire, Co. Cork

DRAWING TITLE		Speed Control Measures & Zebra/Pedestrian Crossings	
SHEET	A1	SCALE	1:250
PROJECT NO.	6291	DRAWING NO.	5012
STATUS/ISSUE	H		