

1. Granite paving flags, flamed top, sawn sides. 350mm width x RL 400 to 700mm x 80mm depth 450mm width x RL 500 to 600mm x 80mm depth 600mm width x RL 800 to 1100mm x 80mm depth (mixture of 40% G603 Montemuro, 40% G603 Grey Vilar and 20% G363 Pink Forte)
2. Mortar Bed 20-30mm deep, to engineers specification.
3. DBM to engineers specification
4. Well compacted Type 1/3 to Engineers specification. Slurry mortar to all joints. 8mm width (set out with 8mm spacers). All slurry mortar to be removed using sponge rollers. No excess mortar to be allowed to enter drainage gullies.
6. Proposed Kerb, refer to detail
7. Adjacent Paving / surface

Plan - Not To Scale

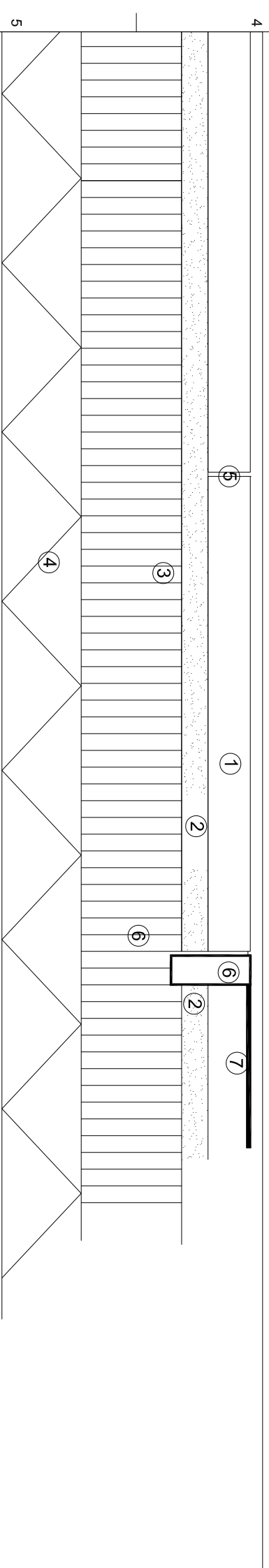

Typical Section

Notes: Drawing to be read in conjunction with all Works Information For proposed orientation refer to Layouts Paving system including jointing and bedding to perform to BS 7533 Heavy vehicular over run.

Rev	Date	By	Chkd	Appl
P01	12/02/18	DM	AH	AH

Issued for Planning

ARUP
 One Albert Quay
 Cork, Ireland
 Tel +353 (0)21 427 7670 Fax +353 (0)21 427 2345
 www.arup.com

the paulhogarth company

Project Title **Morrison's Island Public Realm and Flood Defence Project**

Client **Cork City Council
 City Hall
 Anglessea Street
 Cork**



Drawing Title **Pedestrian Type 1 Paving**

Scale at A3 1:10

Role	Civil Infrastructure	Rev	
Subsidiarity	Part 8 Planning	Rev	
Arup Job No	230436-00	Rev	P01
Name	MOR-5001		