



**Cork  
City Council**  
Comhairle Cathrach Chorcaí



**We are Cork.**

# Upper Glanmire Pedestrian Safety Scheme

Notes

Key to symbols

Reference drawings

Rev	Date	Drawn	Description	Ch'k'd	App'd
P01	18/03/2022	MMat	For Client Comment	EPet	ACos

Status Stamp

**NOT FOR CONSTRUCTION**

<b>M</b> <b>MOTT</b> <b>MACDONALD</b>	<b>M</b>	5 Eastgate Avenue
		Eastgate Little Island Cork Ireland T +353 (0) 21 4809800 F +353 (0) 21 4809801 W www.mottmac.com

 <b>Cork City Council</b> Comhairle Cathrach Chorcaí	Cork City Council City Hall Anglesea Street Cork, T12 T997
--	---

Title  
**Upper Glanmire Pedestrian  
Safety Scheme  
Cover Sheet**

Designed	E.PETERS	EP	Eng check	A.COSTELLO	AC
Drawn	M.MATYSZCZAK	MM	Coordination	A.COSTELLO	AC
Dwg check	E.PETERS	EP	Approved	J.HAWE	JH

MMD Project Number <b>229101013</b>	Scale at A1	Security <b>STD</b>
--	-------------	------------------------

Suitability Description <b>Suitable for Review &amp; Comment</b>	Suit. Code
---	------------

Drawing Number <b>229101013-MMD-0000-XX-DR-C-0001</b>	Revision <b>P01</b>
--	------------------------

# Upper Glanmire Pedestrian Safety Scheme

## Schedule of Drawings

### Drg. No.

229101013-MMD-0000-XX-DR-C-0001  
 229101013-MMD-0000-XX-DR-C-0002  
 229101013-MMD-0000-XX-DR-C-0003  
 229101013-MMD-0000-XX-DR-C-0004  
 229101013-MMD-0000-XX-DR-C-0005

### Filename

Cover Sheet  
 Schedule of Drawings  
 Project Boundary  
 Typical Cross Section  
 General Layout

- Notes**
1. This drawing to be read in conjunction with all relevant Engineers drawings and specifications.
  2. All dimensions are in metres (m).
  3. Use figured dimensions only. Do not scale from this drawing. All dimensions to be checked on site.
  4. All levels in metres O.D. (Malin).
  5. All coordinates relate to ITM - Irish Transverse Mercator.
  6. Drawing to be read in conjunction with drawings 229101013-MMD-0000-XX-DR-C-0001 to 229101013-MMD-0000-XX-DR-C-0005.

**Key to symbols**



— Red Site Boundary

**Reference drawings**

Rev	Date	Drawn	Description	Ch'k'd	App'd
P01	18/03/2022	MMat	For Client Comment	EPet	ACos

Status Stamp

**NOT FOR CONSTRUCTION**

	M	M	5 Eastgate Avenue Eastgate Little Island Cork Ireland T +353 (0) 21 4809800 F +353 (0) 21 4809801 W www.mottmac.com
	Client  Cork City Council City Hall Anglesea Street Comhairle Cathrach Chorcaí Cork, T12 T997		

**Title**

Upper Glanmire Pedestrian  
 Safety Scheme  
 Schedule of Drawings

Designed	E.PETERS	EP	Eng check	A.COSTELLO	AC
Drawn	M.MATYSZCZAK	MM	Coordination	A.COSTELLO	AC
Dwg check	E.PETERS	EP	Approved	J.HAWE	JH
MMD Project Number	229101013			Scale at A1	Security <b>STD</b>
Suitability Description	Suitable for Review & Comment				Suit. Code
Drawing Number	229101013-MMD-0000-XX-DR-C-0002				Revision <b>P01</b>



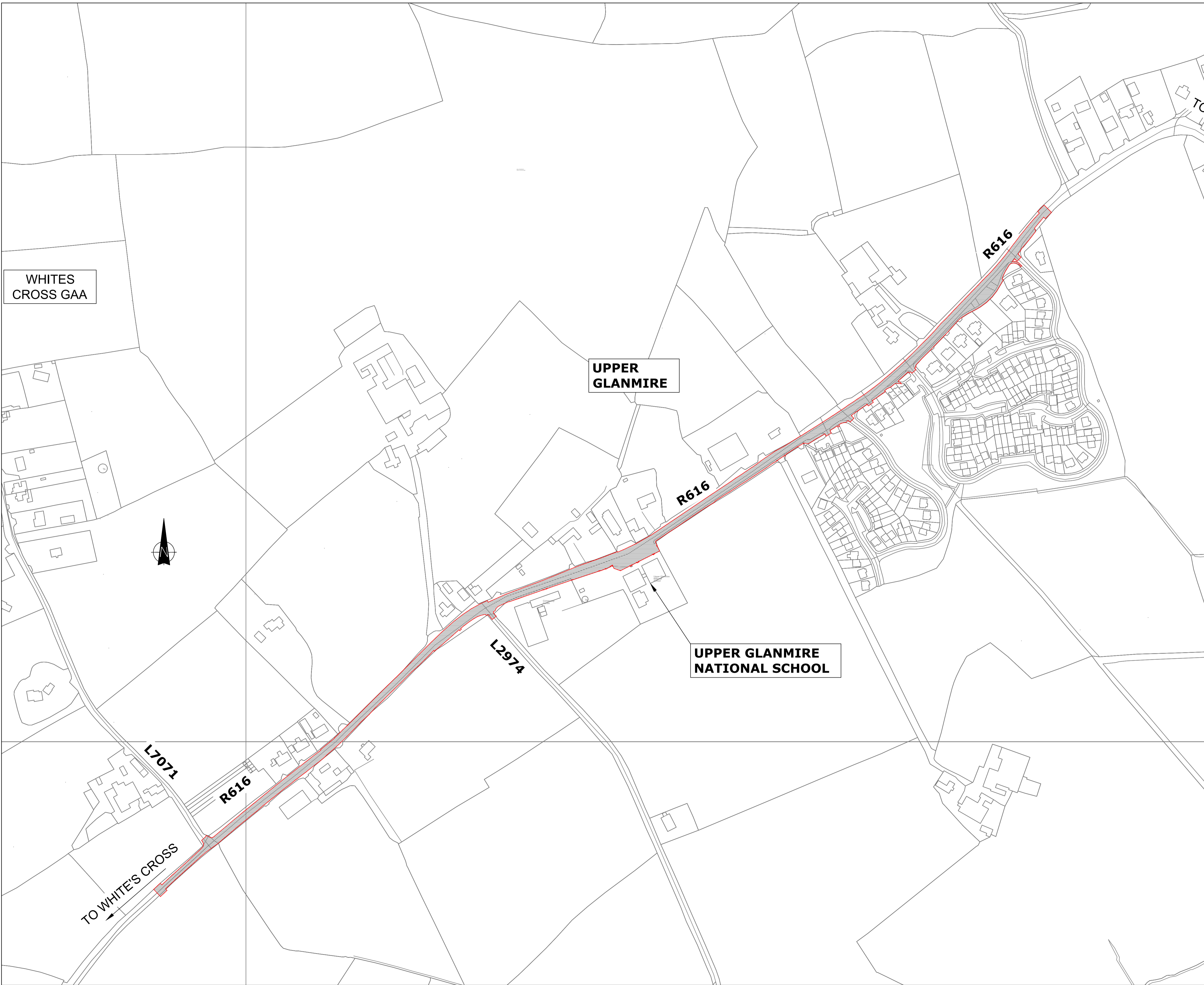

- Notes
1. This drawing to be read in conjunction with all relevant Engineers drawings and specifications.
  2. All dimensions are in metres (m).
  3. Use figured dimensions only. Do not scale from this drawing. All dimensions to be checked on site.
  4. All levels in metres O.D. (Malin).
  5. All coordinates relate to ITM - Irish Transverse Mercator.
  6. Drawing to be read in conjunction with drawings 229101013-MMD-0000-XX-DR-C-0001 to 229101013-MMD-0000-XX-DR-C-0005.

Key to symbols  
 — Red Site Boundary

Reference drawings

Rev	Date	Drawn	Description	Ch'k'd	App'd
P01	18/03/2022	MMat	For Client Comment	EPet	ACos

Status Stamp

**NOT FOR CONSTRUCTION**

<p><b>M</b></p> <p><b>MOTT</b> <b>MACDONALD</b></p>	<p>5 Eastgate Avenue Eastgate Little Island Cork Ireland +353 (0) 21 4809800 T +353 (0) 21 4809801 E www.mottmac.com W</p>
---	--

Client

<p><b>Cork City Council</b> Comhairle Cathrach Chorcaí</p>	<p>Cork City Council City Hall Anglesea Street Cork, T12 T997</p>
--	---

Title

**Upper Glanmire Pedestrian Safety Scheme Project Boundary**

Designed	E.PETERS	EP	Eng check	A.COSTELLO	AC
Drawn	M.MATYSZCZAK	MM	Coordination	A.COSTELLO	AC
Dwg check	E.PETERS	EP	Approved	J.HAWE	JH

MMD Project Number	Scale at A1	Security
<b>229101013</b>		<b>STD</b>
Suitability Description		
<b>Suitable for Review &amp; Comment</b>		
Drawing Number		Revision
<b>229101013-MMD-0000-XX-DR-C-0003</b>		<b>P01</b>



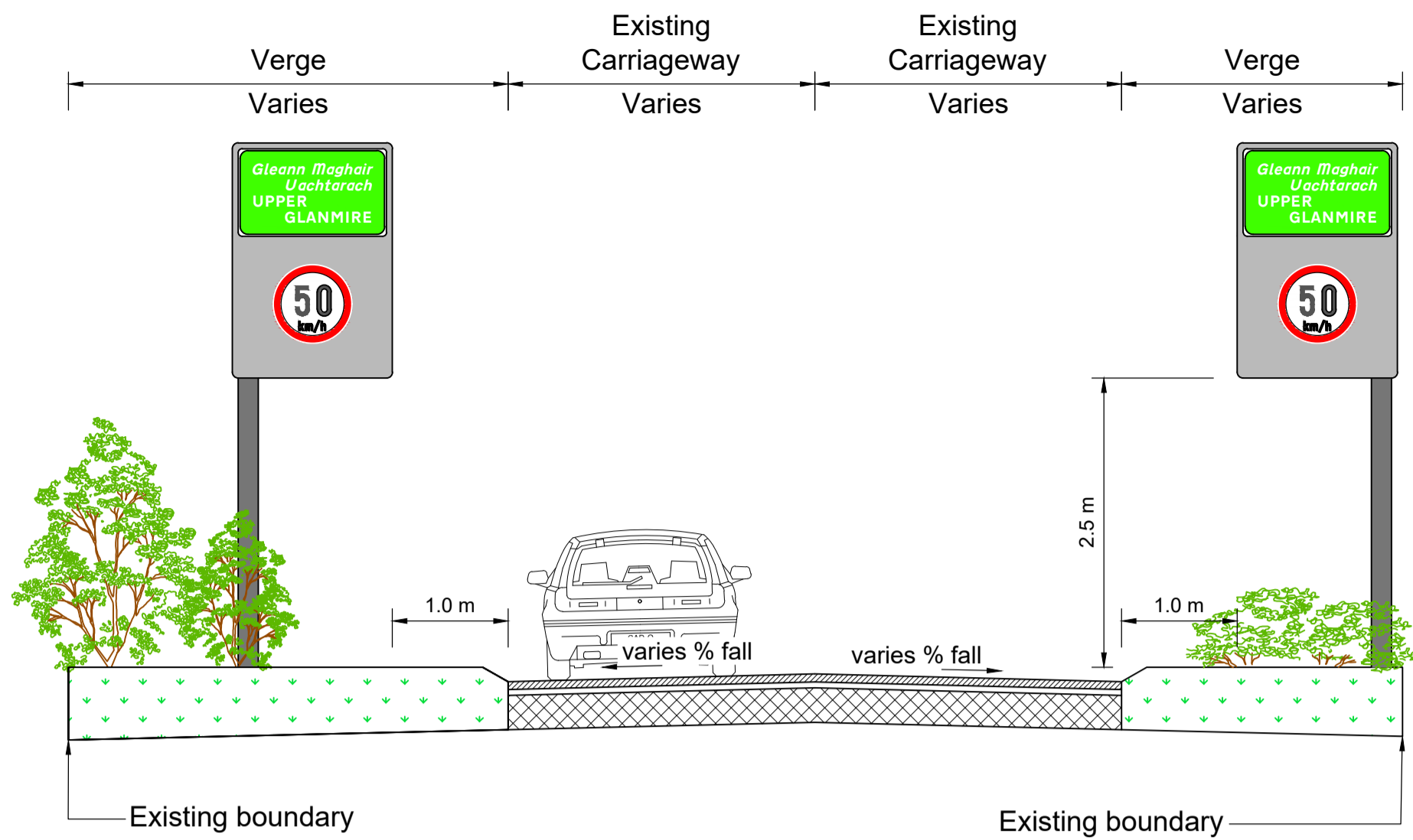

TYPICAL SECTION A-A  
R616

LOCATED ON PLAN 01  
DRAWING REF: 229101013-MMD-0000-XX-SK-C-0005

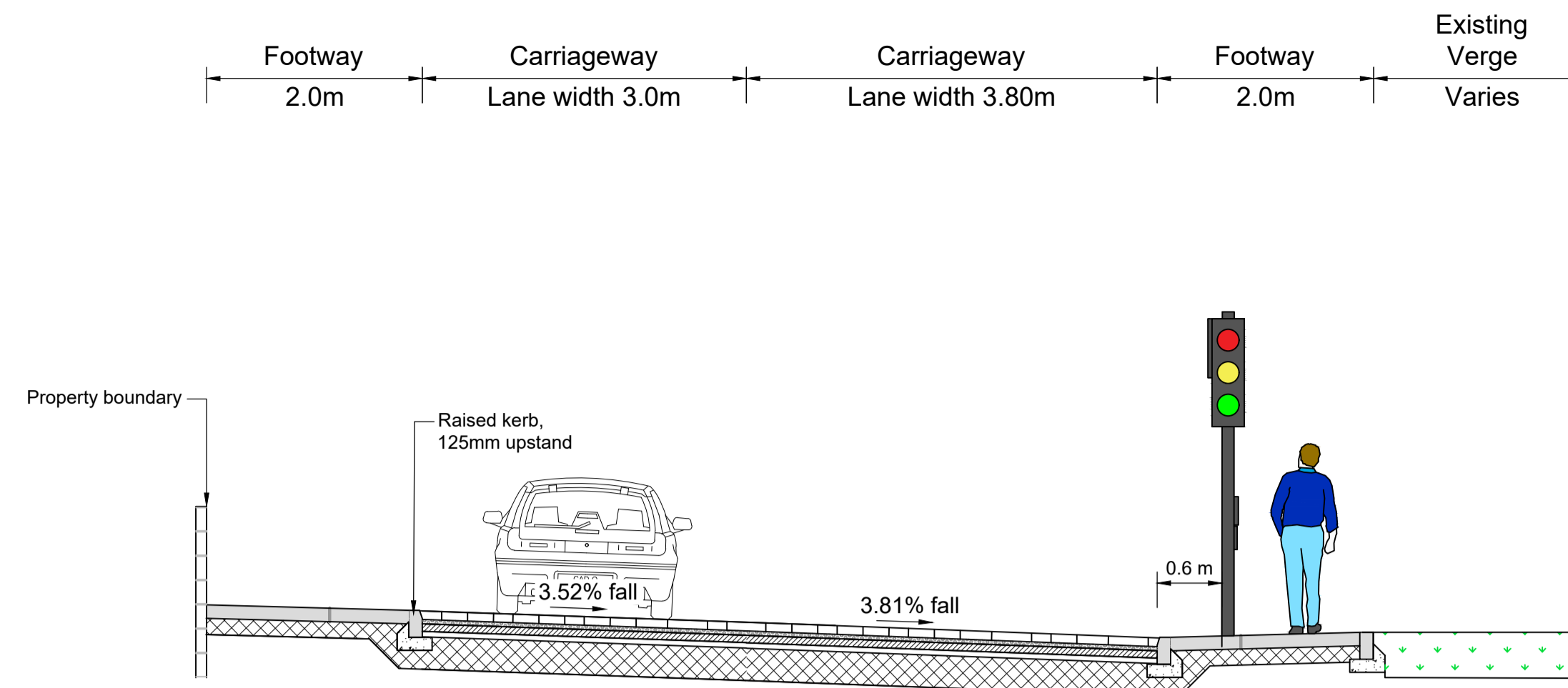

TYPICAL SECTION D-D  
R616

LOCATED ON PLAN 02  
DRAWING REF: 229101013-MMD-0000-XX-SK-C-0005

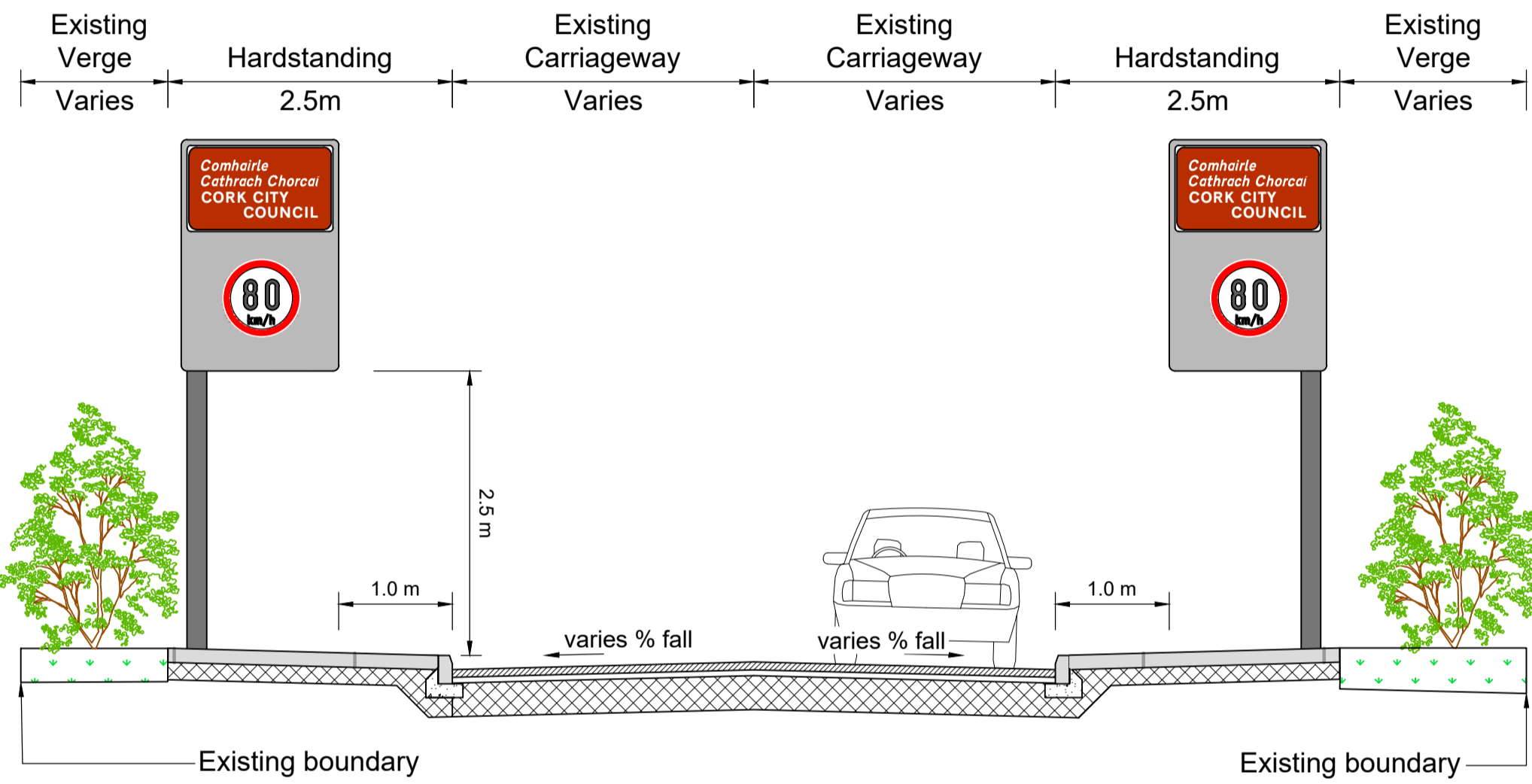

TYPICAL SECTION B-B  
R616

LOCATED ON PLAN 01  
DRAWING REF: 229101013-MMD-0000-XX-SK-C-0005

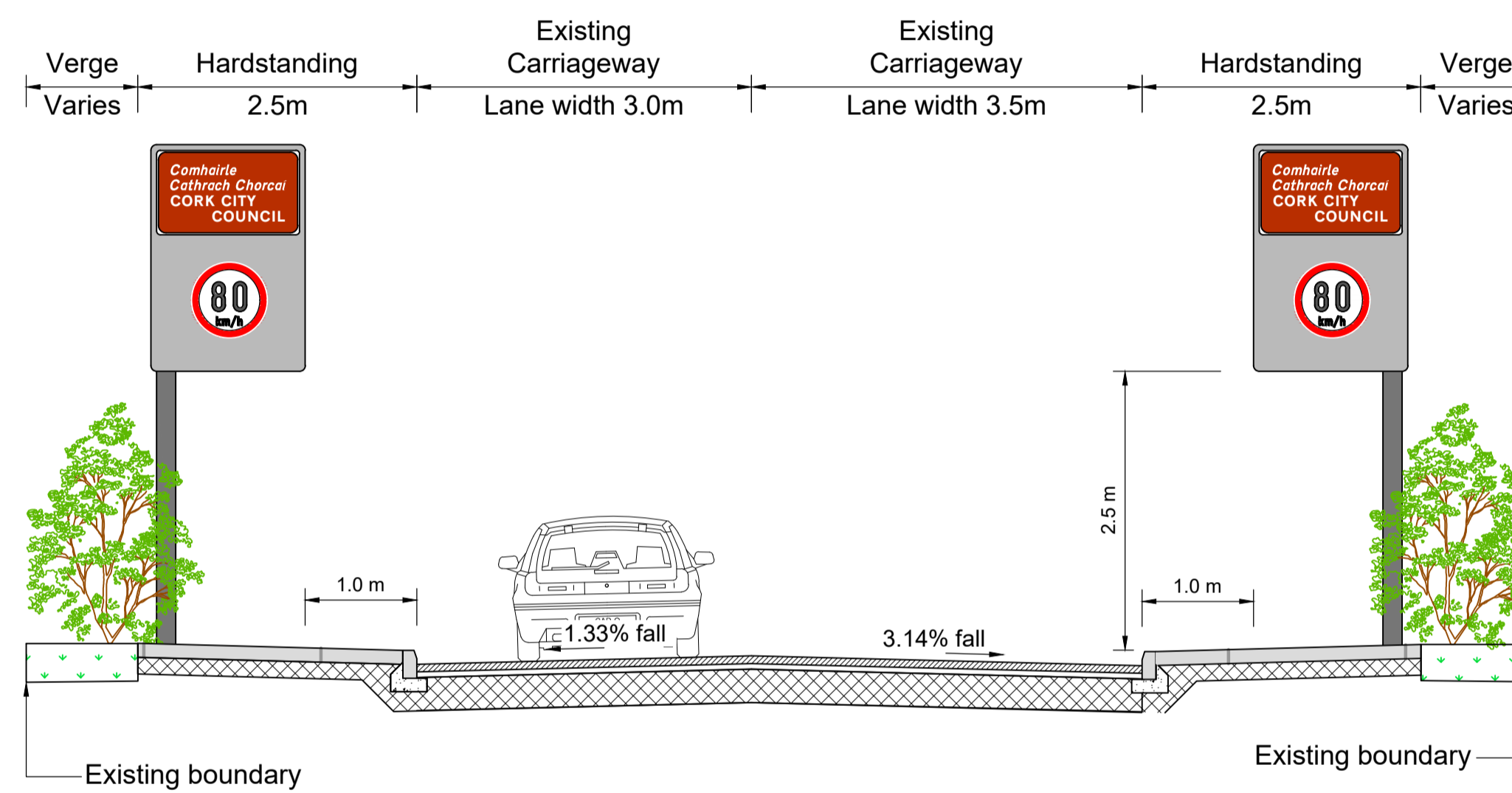

TYPICAL SECTION E-E  
R616

LOCATED ON PLAN 04  
DRAWING REF: 229101013-MMD-0000-XX-SK-C-0005

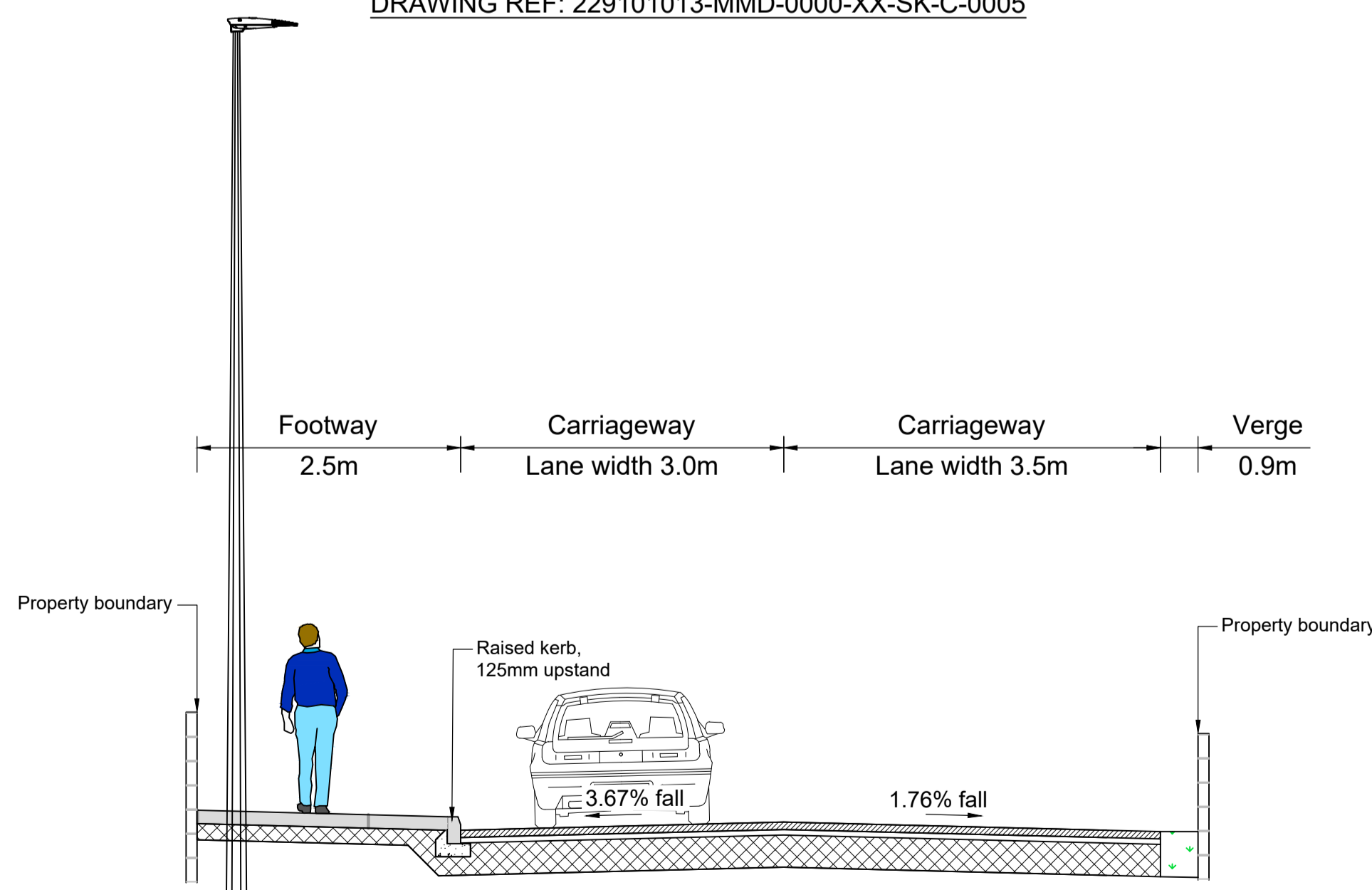

TYPICAL SECTION C-C  
R616

LOCATED ON PLAN 01  
DRAWING REF: 229101013-MMD-0000-XX-SK-C-0005

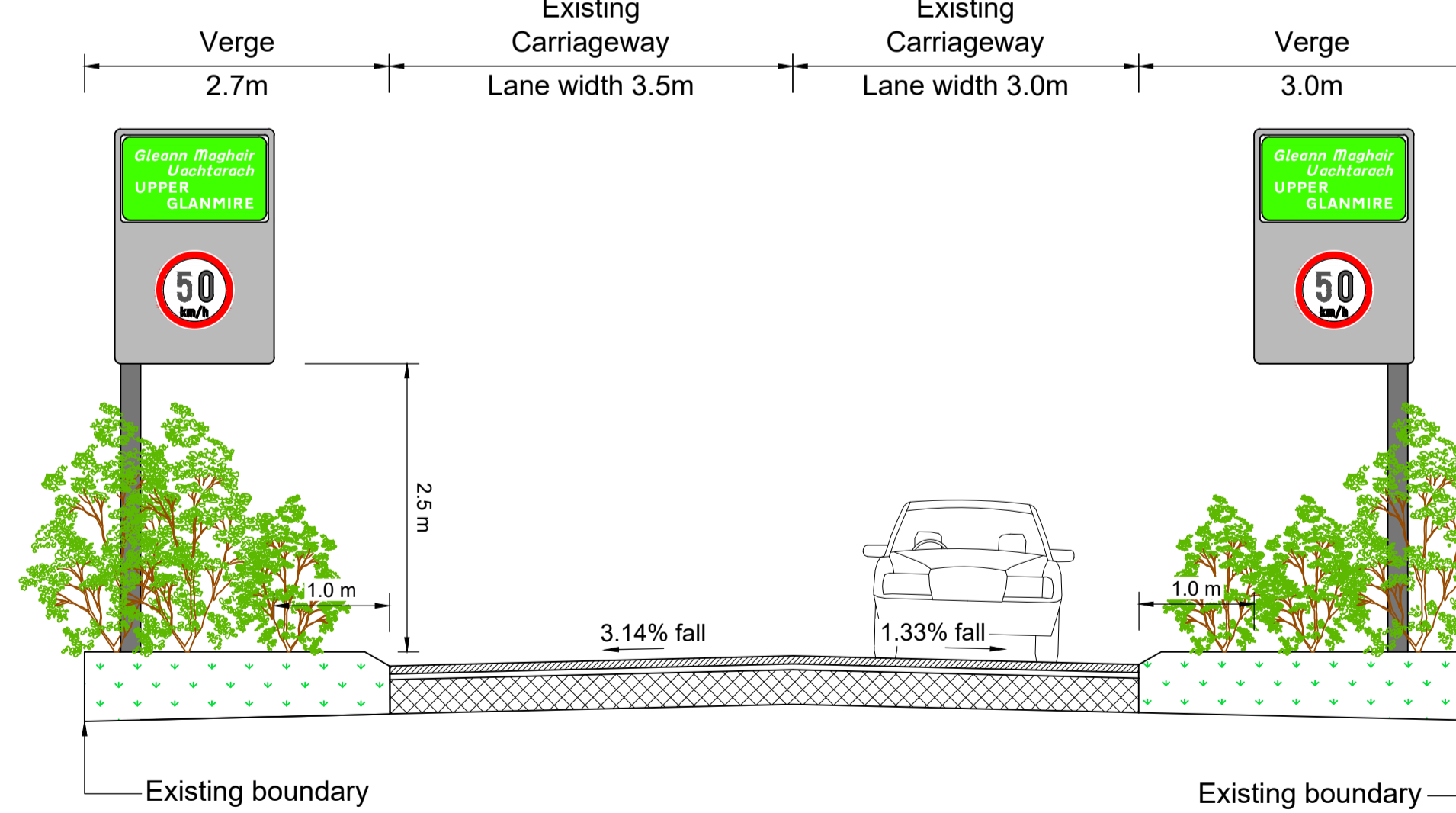

TYPICAL SECTION F-F  
R616

LOCATED ON PLAN 04  
DRAWING REF: 229101013-MMD-0000-XX-SK-C-0005

SCALE  
1:500 @ A1

- Notes
1. This drawing to be read in conjunction with all relevant Engineers drawings and specifications.
  2. All dimensions are in metres (m).
  3. Use figured dimensions only. Do not scale from this drawing. All dimensions to be checked on site.
  4. All levels in metres O.D. (Malin).
  5. All coordinates relate to ITM - Irish Transverse Mercator.
  6. Drawing to be read in conjunction with drawings 229101013-MMD-0000-XX-DR-C-0001 to 229101013-MMD-0000-XX-DR-C-0004

Key to symbols

Reference drawings

Rev	Date	Drawn	Description	Ch'k'd	App'd
P01	18/03/2022	MMat	For Client Comment	EPet	ACos

Status Stamp

**NOT FOR CONSTRUCTION**

**MOTT MACDONALD**

5 Eastgate Avenue  
Eastgate  
Little Island  
Cork  
Ireland  
T +353 (0) 21 4809800  
F +353 (0) 21 4809801  
W www.mottmac.com

Client

**Cork City Council**  
Comhairle Cathrach Chorcaí

Cork City Council  
City Hall  
Anglesea Street  
Cork, T12 T997

Title

**Upper Glanmire Pedestrian Safety Scheme Typical Cross Section**

Designed	E.PETERS	EP	Eng check	A.COSTELLO	AC
Drawn	M.MATYSZCZAK	MM	Coordination	A.COSTELLO	AC
Dwg check	E.PETERS	EP	Approved	J.HAWE	JH
MMD Project Number	Scale at A1			Security	
<b>229101013</b>				<b>STD</b>	
Suitability Description					Suit. Code
<b>Suitable for Review &amp; Comment</b>					
Drawing Number				Revision	
<b>229101013-MMD-0000-XX-DR-C-0004</b>				<b>P01</b>	



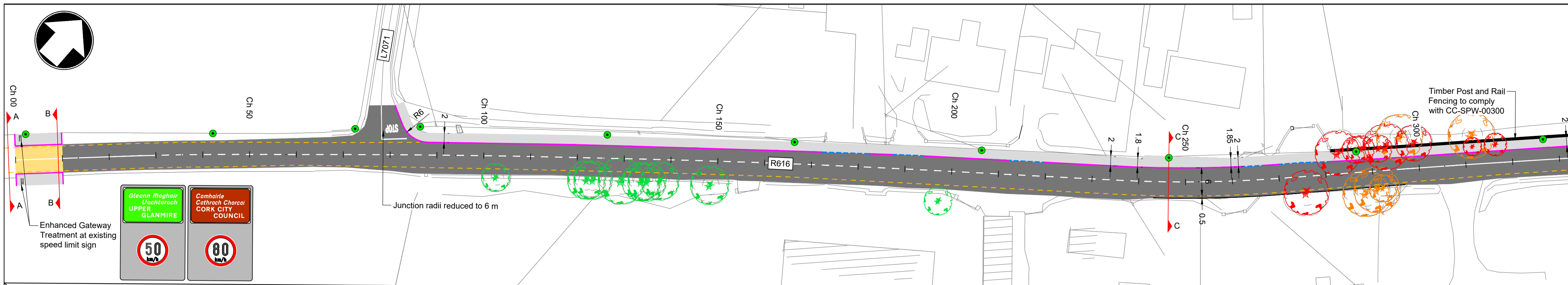

Plan 1

1:500 @ A1

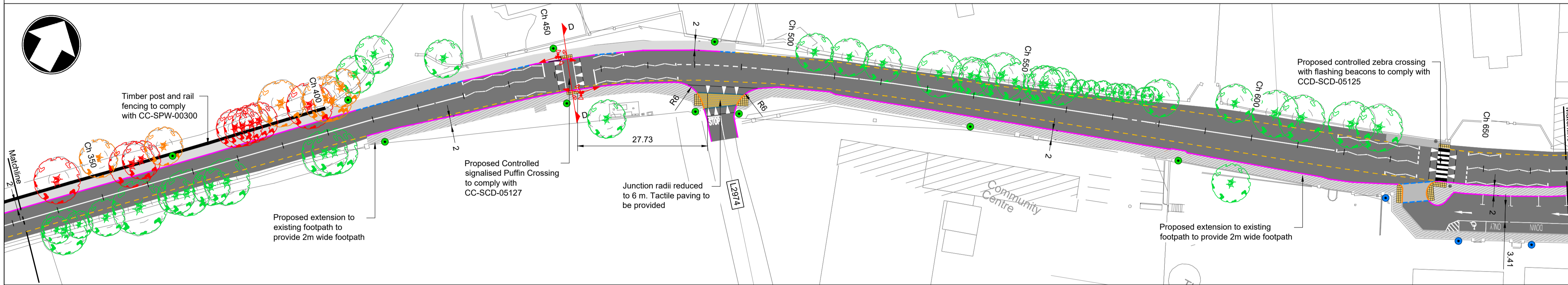

Plan 2

1:500 @ A1

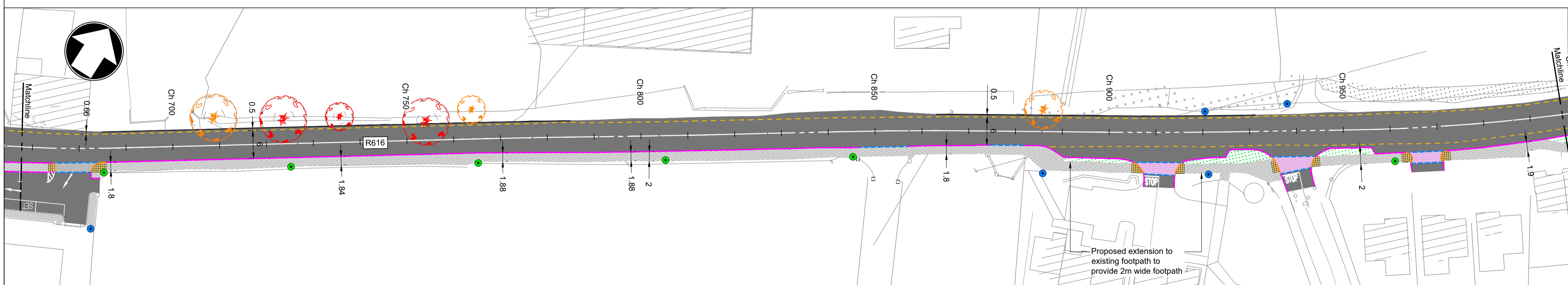

Plan 3

1:500 @ A1

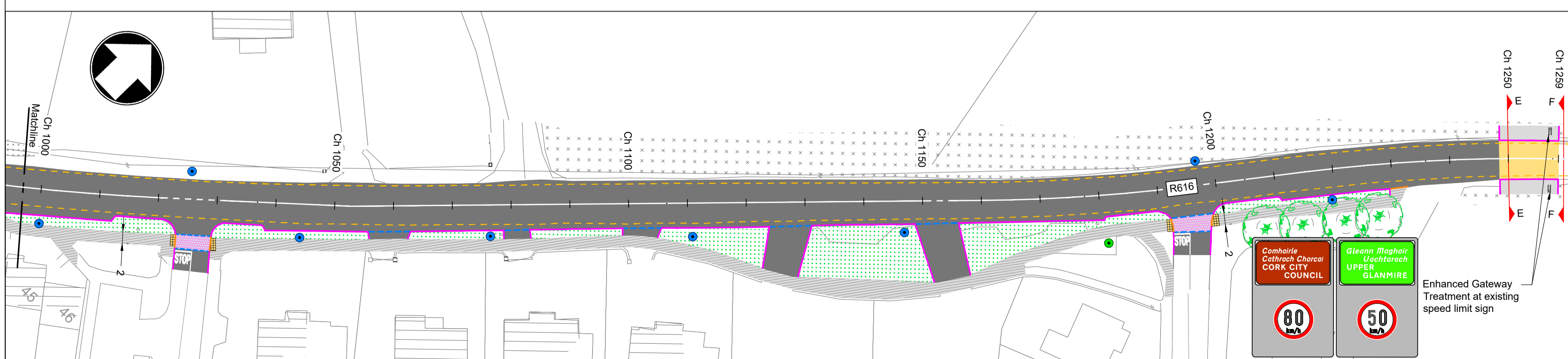

Plan 4

1:500 @ A1

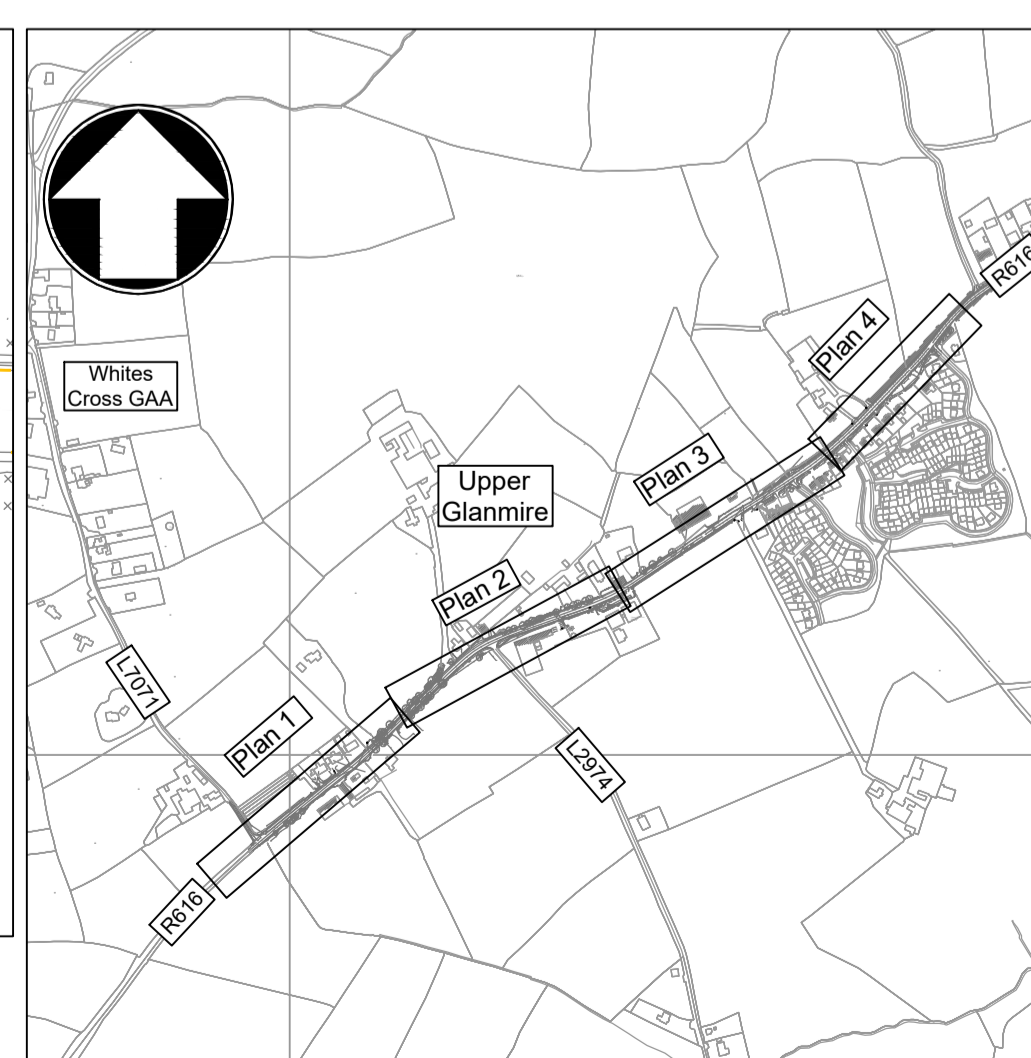

Key Plan

N.T.S

- Notes
- This drawing to be read in conjunction with all relevant Engineers drawings and specifications.
  - All dimensions are in metres (m).
  - Use figured dimensions only. Do not scale from this drawing. All dimensions to be checked on site
  - All levels in metres O.D. (Malin).
  - All coordinates relate to ITM - Irish Transverse Mercator.
  - Drawing to be read in conjunction with Options Assessment Report 229101013-MMD-0000-XX-RP-C-0014.
  - Drawing to be read in conjunction with drawings 229101013-MMD-0000-XX-DR-C-0001 to 229101013-MMD-0000-XX-DR-C-0005.

Key to symbols

- Asphalt Carriageway
- Enhanced Gateway Treatment
- Concrete Footway to TII CC-SCD-01105.
- Existing Footway, To Be Retained and Widened
- Raised Table, Contrasting Material as Specified
- Raised Pedestrian Crossing, Concrete Paviour, Natural Colour
- Grassed Area
- Kerb, Concrete, 125mm Upstand
- Kerb, Concrete, 6mm Upstand
- Kerb, Concrete, 25mm Upstand
- Kerb, Limestone, 0mm Upstand
- Edge of Carriageway
- Blister Tactile Paving, Concrete, Buff Colour
- Road Markings
- Retained lighting column
- Proposed lighting column
- Flashing beacon
- Signals
- Retained Trees
- At Risk/Requires Remediation to Retain
- Removed Trees

Reference drawings

P01	18/03/2022	MMat	For Client Comment	EPet	ACos
Rev	Date	Drawn	Description	Ch'k'd	App'd

Status Stamp

**NOT FOR CONSTRUCTION**

**M** **M**

**MOTT**  
**MACDONALD**

5 Eastgate Avenue  
Eastgate  
Little Island  
Cork  
Ireland  
T +353 (0) 21 4809800  
F +353 (0) 21 4809801  
W www.mottmac.com

Client

**Cork City Council**  
Comhairle Cathrach Chorcaí

Cork City Council  
City Hall  
Anglesea Street  
Cork, T12 T997

Title

## Upper Glanmire Pedestrian Safety Scheme General Layout

Designed	E.PETERS	EP	Eng check	A.COSTELLO	AC
Drawn	M.MATYSZCZAK	MM	Coordination	A.COSTELLO	AC
Dwg check	E.PETERS	EP	Approved	J.HAWE	JH
MMD Project Number	229101013			Scale at A1	Security
Suitability Description	Suitable for Review & Comment				Suit. Code
Drawing Number	229101013-MMD-0000-XX-DR-C-0005				Revision
					P01

© Mott MacDonald Ireland

This document is issued for the party which commissioned it and for specific purposes connected with the captioned project only. It should not be relied upon by any other party or used for any other purpose. We accept no responsibility for the consequences of this document being relied upon by any other party, or being used for any other purpose, or containing any error or omission which is due to an error or omission in data supplied to us by other parties.

C:\users\mat93942\appdata\local\projectwise\workdir\mott-gb-pw-09\0145925\229101013-MMD-0000-XX-DR-C-0005.dwg Mar 18, 2022 - 10:16AM MAT93942