



Section AA



Section BB

Site Sections AA & BB

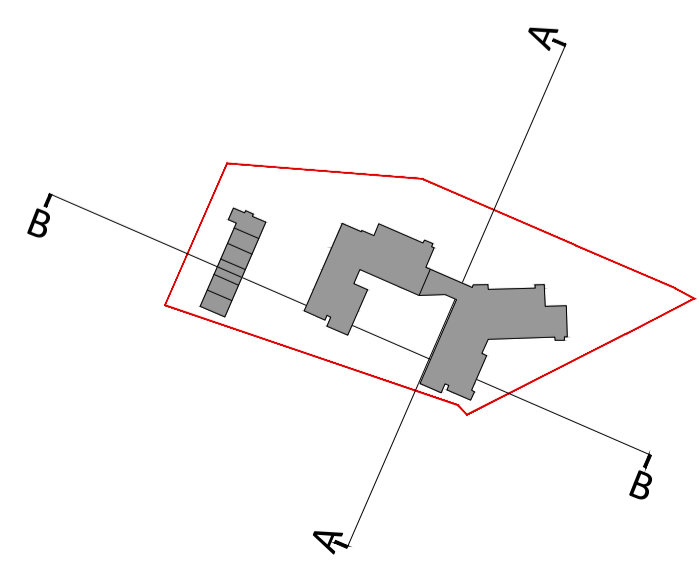

Keyplan

Revision Description	Date	Rev. No.	Issued by
Draft Planning Submission	22-07-2022	C01	SK
Final Planning Submission	10-10-2022	C02	AW

Figured dimensions only to be used. This drawing is copyright of O'Mahony Pike Architects Ltd. All information is shared as per approved use in accordance with BS1192(2007) + A2(2016), Table 5; Standard Codes for Suitability of Models and Documents. If 'Information Approval Check' is empty, this information has been shared at S0 - WIP.

**omahony pike**

architecture | urban design | Dublin | Cork  
 email: info@omahonypike.com | The Chapel | One South Mall  
 tel: +353 1 202 7400 | Mount St. Anne's | Cork City  
 fax: +353 1 283 0822 | Milltown, Dublin 6 | Co. Cork  
 www.omahonypike.com | D06 XNS2 Ireland | T12 CN3 Ireland

**Project:** Clover Hill Court  
**Location:** Bessboro Road, Mahon, Cork  
**client:** Cork City Council

**Project No.:** 20001A **Scale @ A1:** 1:250  
**Project Lead:** AS **Date Printed:** 10-10-2022  
**Drawn By:** AR **Current Rev.:** C02  
**Model No.:** 20001A-OMP-00-ZZ-DR-A-3900  
**Purpose:** A3

**Drawing Title:** Site Sections AA & BB  
**Drawing No.:** 20001A-OMP-00-ZZ-DR-A-3900

Suitability - Checked By - Date